

# LISTA DE APLICACIONES - BUYERS GUIDE

## RB1640-229



8 424073 132789

Qty: 944

Weight: 1.873

O.E.M.	MAKE
1 501 265	FORD
1 718 023	FORD
8C1V-2M008-AA	FORD
8C1V-2M008-AB	FORD

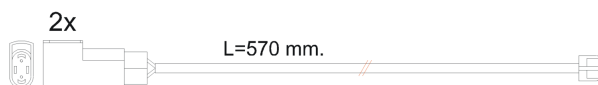
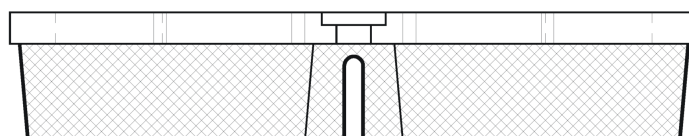
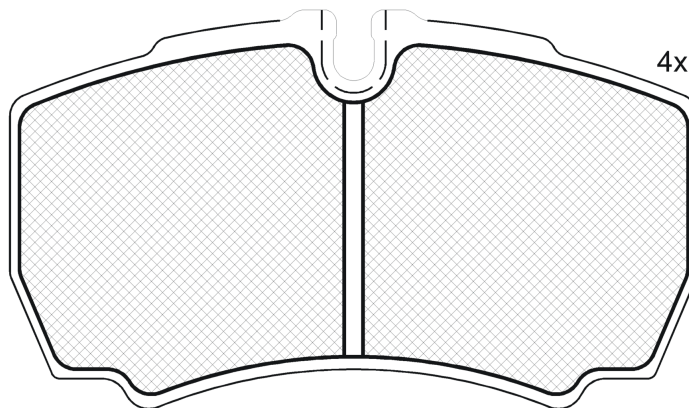

1-Ref. 610463 E

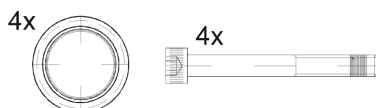

2 - Ref. 690142 E

## RB1640-229



E 90R-01110/496

Brembo

109.6x63.6x20.3

WVA

29123

Sin Filas



Trac.	CC	Kw	CV	
				Front / Rear

### FORD

TRANSIT V (FA_ ) 04.06-					[CAMBIADO]:Furgón (LCVs-N1 Segment)				
2.3 16V RWD (GZFA)		Gasolina	RWD	2261	107	145	04.06-08.14		*
2.3 16V RWD (GZFB)		Gasolina	RWD	2261	107	145	04.06-08.14		*
2.3 16V RWD (GZFC)		Gasolina	RWD	2261	107	145	04.06-08.14		*
2.3 16V LPG RWD (GZFC)		Gasol./Gas (LPG)	RWD	2261	107	145	04.06-08.14		*
2.3 16V CNG RWD (GZFC)		Gasol./Gas (CNG)	RWD	2261	100	136	04.06-08.14		*
2.2 TDCi (P8FA)		Diesel	FWD	2198	63	85	04.06-08.14		*
2.2 TDCi (P8FB)		Diesel	FWD	2198	63	85	04.06-08.14		*
2.2 TDCi (DRFA)		Diesel	FWD	2198	74	100	10.11-08.14		*
2.2 TDCi (DRFB)		Diesel	FWD	2198	74	100	10.11-08.14		*
2.2 TDCi (DRFC)		Diesel	FWD	2198	74	100	10.11-08.14		*
2.2 TDCi (DRFD)		Diesel	FWD	2198	74	100	10.11-08.14		*
2.2 TDCi (DRFE)		Diesel	FWD	2198	74	100	10.11-08.14		*
2.2 TDCi RWD (DRRA)		Diesel	RWD	2198	74	100	10.11-08.14		*
2.2 TDCi RWD (DRRB)		Diesel	RWD	2198	74	100	10.11-08.14		*
2.2 TDCi RWD (DRRC)		Diesel	RWD	2198	74	100	10.11-08.14		*
2.2 TDCi (QVFA)		Diesel	FWD	2198	81	110	04.06-08.14		*
2.2 TDCi (SRFA)		Diesel	FWD	2198	85	115	10.08-08.14		*
2.2 TDCi (SRFB)		Diesel	FWD	2198	85	115	10.08-08.14		*
2.2 TDCi (SRFC)		Diesel	FWD	2198	85	115	10.08-08.14		*
2.2 TDCi (SRFD)		Diesel	FWD	2198	85	115	10.08-08.14		*
2.2 TDCi (SRFE)		Diesel	FWD	2198	85	115	10.08-08.14		*

# LISTA DE APLICACIONES - BUYERS GUIDE

2.2 TDCi (CYFA)		Diesel	FWD	2198	92	125	10.11-08.14	*
2.2 TDCi (CYFB)		Diesel	FWD	2198	92	125	10.11-08.14	*
2.2 TDCi (CYFC)		Diesel	FWD	2198	92	125	10.11-08.14	*
2.2 TDCi (CYFD)		Diesel	FWD	2198	92	125	10.11-08.14	*
2.2 TDCi 4x4 (CYRB)		Diesel	4WD	2198	92	125	10.11-08.14	*
2.2 TDCi 4x4 (CYRC)		Diesel	4WD	2198	92	125	10.11-08.14	*
2.2 TDCi RWD (CYRA)		Diesel	RWD	2198	92	125	09.11-12.14	*
2.2 TDCi (QWFA)		Diesel	FWD	2198	96	130	04.06-08.14	*
2.2 TDCi RWD (USRA)		Diesel	RWD	2198	100	136	10.11-08.14	*
2.2 TDCi RWD (USRB)		Diesel	RWD	2198	100	136	10.11-08.14	*
2.2 TDCi (PGFA)		Diesel	FWD	2198	103	140	10.07-08.14	*
2.2 TDCi (PGFB)		Diesel	FWD	2198	103	140	10.07-08.14	*
2.2 TDCi (UHFA)		Diesel	FWD	2198	103	140	10.07-08.14	*
2.2 TDCi (UHFB)		Diesel	FWD	2198	103	140	10.07-08.14	*
2.2 TDCi (UHFC)		Diesel	FWD	2198	103	140	10.07-08.14	*
2.2 TDCi RWD (CVRA)		Diesel	RWD	2198	114	155	10.11-08.14	*
2.2 TDCi RWD (CVRB)		Diesel	RWD	2198	114	155	10.11-08.14	*
2.2 TDCi RWD (CVRC)		Diesel	RWD	2198	114	155	10.11-08.14	*
2.4 TDCi RWD (PHFA)		Diesel	RWD	2402	74	100	04.06-08.14	*
2.4 TDCi RWD (PHFC)		Diesel	RWD	2402	74	100	04.06-08.14	*
2.4 TDCi RWD (JXFA)		Diesel	RWD	2402	85	115	04.06-08.14	*
2.4 TDCi RWD (JXFC)		Diesel	RWD	2402	85	115	04.06-08.14	*
2.4 TDCi 4x4 (H9FB)		Diesel	4WD	2402	103	140	11.06-08.14	*
2.4 TDCi RWD (H9FB)		Diesel	RWD	2402	103	140	04.06-08.14	*
2.4 TDCi RWD (H9FD)		Diesel	RWD	2402	103	140	04.06-08.14	*
3.2 TDCi RWD (SAFA)		Diesel	RWD	3199	147	200	09.07-08.14	*
3.2 TDCi RWD (SAFB)		Diesel	RWD	3199	147	200	09.07-08.14	*
<b>TRANSIT V (FD __, FB __, FS __, FZ __, FC __) 04.06-</b>					<b>Bus (Minibus-M2-Segment)</b>			
2.2 TDCi (P8FA)		Diesel	FWD	2198	63	85	04.06-08.14	*
2.2 TDCi (P8FB)		Diesel	FWD	2198	63	85	04.06-08.14	*
2.2 TDCi RWD (DRRA)		Diesel	RWD	2198	74	100	10.11-08.14	*
2.2 TDCi RWD (DRRB)		Diesel	RWD	2198	74	100	10.11-08.14	*
2.2 TDCi RWD (DRRC)		Diesel	RWD	2198	74	100	10.11-08.14	*
2.2 TDCi (QVFA)		Diesel	FWD	2198	81	110	04.06-08.14	*
2.2 TDCi (SRFA)		Diesel	FWD	2198	85	115	10.08-08.14	*
2.2 TDCi (SRFB)		Diesel	FWD	2198	85	115	10.08-08.14	*
2.2 TDCi (SRFC)		Diesel	FWD	2198	85	115	10.08-08.14	*
2.2 TDCi (SRFD)		Diesel	FWD	2198	85	115	10.08-08.14	*
2.2 TDCi (SRFE)		Diesel	FWD	2198	85	115	10.08-08.14	*
2.2 TDCi RWD (CYRA)		Diesel	RWD	2198	92	125	09.11-12.14	*
2.2 TDCi (QWFA)		Diesel	FWD	2198	96	130	04.06-08.14	*
2.2 TDCi RWD (USRA)		Diesel	RWD	2198	100	135	09.11-08.14	*
2.2 TDCi RWD (USRB)		Diesel	RWD	2198	100	135	09.11-08.14	*
2.2 TDCi (PGFA)		Diesel	FWD	2198	103	140	10.07-08.14	*
2.2 TDCi (PGFB)		Diesel	FWD	2198	103	140	10.07-08.14	*
2.2 TDCi (UHFA)		Diesel	FWD	2198	103	140	10.07-08.14	*
2.2 TDCi (UHFB)		Diesel	FWD	2198	103	140	10.07-08.14	*
2.2 TDCi (UHFC)		Diesel	FWD	2198	103	140	10.07-08.14	*
2.4 TDCi (PHFA)		Diesel	RWD	2402	74	100	04.06-08.14	*
2.4 TDCi (PHFC)		Diesel	RWD	2402	74	100	04.06-08.14	*
2.4 TDCi (JXFA)		Diesel	RWD	2402	85	115	04.06-08.14	*

# LISTA DE APLICACIONES - BUYERS GUIDE

2.4 TDCi (JXFC)		Diesel	RWD	2402	85	115	04.06-08.14	*
2.4 TDCi (H9FD)		Diesel	RWD	2402	103	140	04.06-08.14	*
2.4 TDCi 4x4 (H9FB)		Diesel	4WD	2402	103	140	11.06-08.14	*
3.2 TDCi (SAFA)		Diesel	RWD	3199	147	200	02.08-08.14	*
3.2 TDCi (SAFB)		Diesel	RWD	3199	147	200	02.08-08.14	*
<b>TRANSIT V (FM __, FN __, FF __) 04.06-12.14</b>					<b>Caja/Chasis (LCVs-N1 Segment)</b>			
2.3 16V RWD (GZFA)		Gasolina	RWD	2261	107	145	04.06-08.14	*
2.3 16V RWD (GZFB)		Gasolina	RWD	2261	107	145	04.06-08.14	*
2.3 16V RWD (GZFC)		Gasolina	RWD	2261	107	145	04.06-08.14	*
2.3 16V LPG RWD (GZFC)		Gasol./Gas (LPG)	RWD	2261	107	145	04.06-08.14	*
2.3 16V CNG RWD (GZFC)		Gasol./Gas (CNG)	RWD	2261	100	136	04.06-08.14	*
2.2 TDCi (P8FA)		Diesel	FWD	2198	63	85	04.06-08.14	*
2.2 TDCi (P8FB)		Diesel	FWD	2198	63	85	04.06-08.14	*
2.2 TDCi (DRFA)		Diesel	FWD	2198	74	100	10.11-08.14	*
2.2 TDCi (DRFB)		Diesel	FWD	2198	74	100	10.11-08.14	*
2.2 TDCi (DRFC)		Diesel	FWD	2198	74	100	10.11-08.14	*
2.2 TDCi (DRFD)		Diesel	FWD	2198	74	100	10.11-08.14	*
2.2 TDCi (DRFE)		Diesel	FWD	2198	74	100	10.11-08.14	*
2.2 TDCi RWD (DRRA)		Diesel	RWD	2198	74	100	10.11-08.14	*
2.2 TDCi RWD (DRRB)		Diesel	RWD	2198	74	100	10.11-08.14	*
2.2 TDCi RWD (DRRC)		Diesel	RWD	2198	74	100	10.11-08.14	*
2.2 TDCi (QVFA)		Diesel	FWD	2198	81	110	04.06-08.14	*
2.2 TDCi (SRFA)		Diesel	FWD	2198	85	115	10.08-08.14	*
2.2 TDCi (SRFB)		Diesel	FWD	2198	85	115	10.08-08.14	*
2.2 TDCi (SRFC)		Diesel	FWD	2198	85	115	10.08-08.14	*
2.2 TDCi (SRFD)		Diesel	FWD	2198	85	115	10.08-08.14	*
2.2 TDCi (SRFE)		Diesel	FWD	2198	85	115	10.08-08.14	*
2.2 TDCi (CYFA)		Diesel	FWD	2198	92	125	10.11-08.14	*
2.2 TDCi (CYFB)		Diesel	FWD	2198	92	125	10.11-08.14	*
2.2 TDCi (CYFC)		Diesel	FWD	2198	92	125	10.11-08.14	*
2.2 TDCi (CYFD)		Diesel	FWD	2198	92	125	10.11-08.14	*
2.2 TDCi 4x4 (CYRB)		Diesel	4WD	2198	92	125	10.11-08.14	*
2.2 TDCi 4x4 (CYRC)		Diesel	4WD	2198	92	125	10.11-08.14	*
2.2 TDCi RWD (CYRA)		Diesel	RWD	2198	92	125	10.11-08.14	*
2.2 TDCi (QWFA)		Diesel	FWD	2198	96	130	04.06-08.14	*
2.2 TDCi (PGFA)		Diesel	FWD	2198	103	140	10.07-09.11	*
2.2 TDCi (PGFB)		Diesel	FWD	2198	103	140	10.07-09.11	*
2.2 TDCi (UHFA)		Diesel	FWD	2198	103	140	10.07-09.11	*
2.2 TDCi (UHFB)		Diesel	FWD	2198	103	140	10.07-09.11	*
2.2 TDCi (UHFC)		Diesel	FWD	2198	103	140	10.07-09.11	*
2.2 TDCi RWD (CVRA)		Diesel	RWD	2198	114	155	10.11-08.14	*
2.2 TDCi RWD (CVRB)		Diesel	RWD	2198	114	155	10.11-08.14	*
2.2 TDCi RWD (CVRC)		Diesel	RWD	2198	114	155	10.11-08.14	*
2.4 TDCi RWD (PHFA)		Diesel	RWD	2402	74	100	04.06-08.14	*
2.4 TDCi RWD (PHFC)		Diesel	RWD	2402	74	100	04.06-08.14	*
2.4 TDCi RWD (JXFA)		Diesel	RWD	2402	85	115	04.06-08.14	*
2.4 TDCi RWD (JXFC)		Diesel	RWD	2402	85	115	04.06-08.14	*
2.4 TDCi 4x4 (H9FB)		Diesel	4WD	2402	103	140	11.06-08.14	*
2.4 TDCi RWD (H9FD)		Diesel	RWD	2402	103	140	04.06-08.14	*
3.2 TDCi RWD (SAFA)		Diesel	RWD	3199	147	200	09.07-08.14	*

# LISTA DE APLICACIONES - BUYERS GUIDE

3.2 TDCi RWD (SAFB)	Diesel	RWD	3199	147	200	09.07-08.14	*
<b>TRANSIT CONNECT (P65_, P70_, P80_) 06.02-</b>				<b>Furgoneta/MPV (LCVs-N1 Segment)</b>			
1.8 TDCi (RWPA)	Diesel	FWD	1753	81	110	08.06-12.13	*
1.8 TDCi (RWPB)	Diesel	FWD	1753	81	110	08.06-12.13	*
1.8 TDCi (RWPC)	Diesel	FWD	1753	81	110	08.06-12.13	*
1.8 TDCi (RWPD)	Diesel	FWD	1753	81	110	08.06-12.13	*
<b>TRANSIT TOURNEO III 07.06-08.14</b>				<b>Bus (Minibus-M2-Segment)</b>			
2.2 TDCi (QVFA)	Diesel	FWD	2198	81	110	07.06-08.14	*
2.2 TDCi (SRFA)	Diesel	FWD	2198	85	115	10.08-08.14	*
2.2 TDCi (SRFB)	Diesel	FWD	2198	85	115	10.08-08.14	*
2.2 TDCi (SRFC)	Diesel	FWD	2198	85	115	10.08-08.14	*
2.2 TDCi (SRFD)	Diesel	FWD	2198	85	115	10.08-08.14	*
2.2 TDCi (SRFE)	Diesel	FWD	2198	85	115	10.08-08.14	*
2.2 TDCi (QWFA)	Diesel	FWD	2198	96	131	07.06-08.14	*
2.2 TDCi (PGFA)	Diesel	FWD	2198	103	140	10.07-08.14	*
2.2 TDCi (PGFB)	Diesel	FWD	2198	103	140	10.07-08.14	*
2.2 TDCi (UHFA)	Diesel	FWD	2198	103	140	10.07-08.14	*
2.2 TDCi (UHFB)	Diesel	FWD	2198	103	140	10.07-08.14	*
2.2 TDCi (UHFC)	Diesel	FWD	2198	103	140	10.07-08.14	*