

LISTA DE APLICACIONES - BUYERS GUIDE

RB1419-701



Qty: 300

Weight: 1.720

O.E.M.	MAKE
16 114 564 80	CITROËN
16 172 571 80	CITROËN
4252.15	CITROËN
4252.48	CITROËN
4252.88	CITROËN
4253.46	CITROËN
86 60 004 706	RENAULT
86 71 016 659	RENAULT
E172229	CITROËN

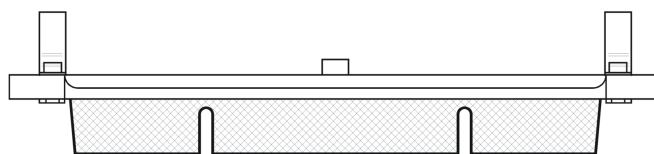
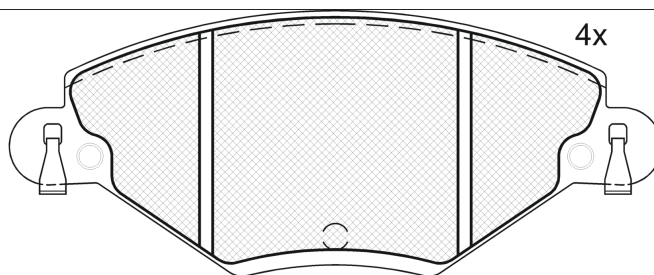

1 - Ref. 610311 E

181419-701

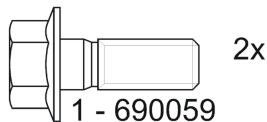

RB1419-701

E 9 90R-01111/592



Bosch

148.85x60.6x18

WVA
23274
23277

FMSI
D2329-9562

Sin Filas



Trac.	CC	Kw	CV		
					Front / Rear

CITROËN

(RE_) 09.04-01.08

1.8 16V (RE6FZB) (6FZ (EW7J4))	Gasolina	FWD	1749	85	116	09.04-08.05	*
2.0 16V (RERFJB, RERFJC) (RFJ (EW10A))	Gasolina	FWD	1997	103	140	11.04-01.08	*
1.6 HDi (RE9HYB, RE9HZB) (9HY (DV6TED4))	Diesel	FWD	1560	80	109	09.04-01.08	*
1.6 HDi (RE9HYB, RE9HZB) (9HZ (DV6TED4))	Diesel	FWD	1560	80	109	09.04-01.08	*

C5 (DE_) 06.01-09.04

1.8 16V (DE6FZB, DE6FZE) (6FZ (EW7J4))	Gasolina	FWD	1749	85	115	06.01-08.04	*
1.8 16V (RE6FZB) (6FZ (EW7J4))	Gasolina	FWD	1749	85	116	09.04-08.05	*
1.8 16V (RE6FYB) (6FY (EW7A))	Gasolina	FWD	1749	92	125	09.05-01.08	*
2.0 16V (DERFNF, DERFNC, RERFNC) (RFN (EW10J4))	Gasolina	FWD	1997	100	136	06.01-08.04	*
2.0 16V (RERFJB, RERFJC) (RFJ (EW10A))	Gasolina	FWD	1997	103	140	09.04-01.08	*
2.0 16V HPi (DERLZB) (RLZ (EW10D))	Gasolina	FWD	1997	103	140	06.01-08.04	*
1.6 HDi (RE9HZC, RE9HYB) (9HY (DV6TED4))	Diesel	FWD	1560	80	109	09.04-01.08	*
1.6 HDi (RE9HZC, RE9HYB) (9HZ (DV6TED4))	Diesel	FWD	1560	80	109	09.04-01.08	*
2.0 HDi (DERHYB) (RHY (DW10TD))	Diesel	FWD	1997	66	90	06.01-08.04	*
2.0 HDi (DERHSB, DERHSE) (RHS (DW10ATED))	Diesel	FWD	1997	79	107	06.01-08.04	*
2.0 HDi (DERHZB, DERHZE) (RHZ (DW10ATED))	Diesel	FWD	1997	80	109	06.01-08.04	*
2.0 HDi (RERHRH) (RHR (DW10BTED4))	Diesel	FWD	1997	100	136	09.04-01.08	*

C5 (DC_) 03.01-03.05

2.0 16V (DCRFNC, DCRFNF) (RFN (EW10J4))	Gasolina	FWD	1997	100	136	03.01-08.04	*
2.0 16V (RCRFJB, RCRFJC) (RFJ (EW10A))	Gasolina	FWD	1997	103	140	09.04-08.08	*
2.0 16V HPi (DCRLZB) (RLZ (EW10D))	Gasolina	FWD	1997	103	140	03.01-08.04	*

LISTA DE APLICACIONES - BUYERS GUIDE

1.6 HDi (RC8HZB) (9HY (DV6TED4))	Diesel	FWD	1560	80	109	09.04-01.08	*
1.6 HDi (RC8HZB) (9HZ (DV6TED4))	Diesel	FWD	1560	80	109	09.04-01.08	*
2.0 HDi (DCRHYP) (RHY (DW10TD))	Diesel	FWD	1997	66	90	03.01-08.04	*
2.0 HDi (RHS (DW10ATED))	Diesel	FWD	1997	79	107	03.01-08.04	*
2.0 HDi (RHZ (DW10ATED))	Diesel	FWD	1997	79	107	03.01-08.04	*
2.0 HDi (DCRHZB, DCRHZE) (RHZ (DW10ATED))	Diesel	FWD	1997	80	109	03.01-08.04	*
C5 (DE_) 06.02-08.04				[CAMBIADO]:Furgón/Break (Large family car-D Segment)			
2.0 HDi (DERHYB) (RHY (DW10TD))	Diesel	FWD	1997	66	90	06.02-08.04	*
2.0 HDi (DERHSE, DERHSB) (RHS (DW10ATED))	Diesel	FWD	1997	79	107	06.02-08.04	*
2.0 HDi (DERHZB, DERHZE) (RHZ (DW10ATED))	Diesel	FWD	1997	80	109	06.02-08.04	*