

# LISTA DE APLICACIONES - BUYERS GUIDE

## RB1185



8 424073 127440

Qty: 300

Weight: 1.350

O.E.M.	MAKE
0K20A-33-23Z	KIA
0K239-33-23Z	KIA
0K240-33-23Z	KIA
0K240-33-23ZA	KIA
0K2A3-33-23ZB	KIA
0K2A4-33-23Z	KIA
0K2X3-33-23Z	KIA
0K2Y1-33-23Z	KIA
0K2Y3-33-23Z	KIA
0K2Y3-33-23ZA	KIA

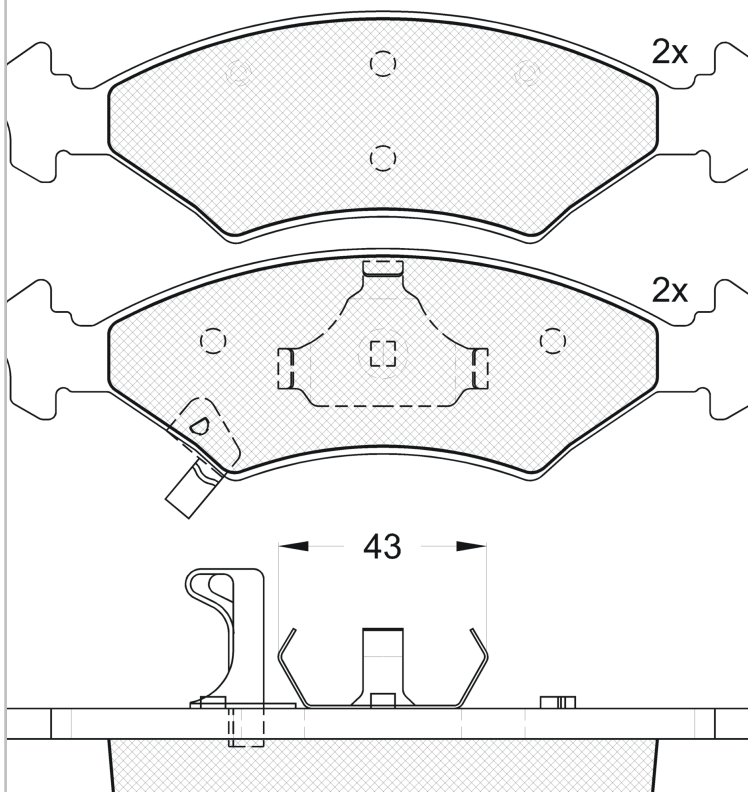

## RB1185



90R-01101/227



Ate - Teves

151.4x46.6x17.3

WVA
23266
23267
23268
23384
23385

Sin Filas

FMSI
D649-7529



Trac.	CC	Kw	CV
-------	----	----	----



Front / Rear

### KIA

#### SEPHIA / MENTOR (FA) 01.95-10.97

#### [CAMBIADO]:Fastback (Compact car-C Segment)

1.5 i (B5)	Gasolina	FWD	1498	59	80	02.96-10.97	*
1.6 i (B6)	Gasolina	FWD	1598	59	80	01.95-10.97	*
1.8 i 16V (TP)	Gasolina	FWD	1793	82	112	01.95-10.97	*

#### SEPHIA / MENTOR (FA) 01.92-09.01

#### Sedán (Compact car-C Segment)

1.5 i (B5)	Gasolina	FWD	1498	59	80	02.96-10.97	*
1.6	Gasolina	FWD	1595	60	81	01.92-	*
1.6 i (B6)	Gasolina	FWD	1598	59	80	09.93-10.97	*
1.8 i 16V (TP)	Gasolina	FWD	1793	82	112	01.95-10.97	*

#### SHUMA / MENTOR / SEPHIA (FB) 09.96-02.02

#### [CAMBIADO]:Fastback (Compact car-C Segment)

1.5 i 16V (AFB242) (BFD)	Gasolina	FWD	1498	65	88	10.97-03.01	*
--------------------------	----------	-----	------	----	----	-------------	---

#### SHUMA / MENTOR / SEPHIA (FB) 03.96-10.01

#### Sedán (Compact car-C Segment)

1.5 (B5)	Gasolina	FWD	1498	59	80	03.96-12.98	*
1.5 i 16V (AFB222) (BFD)	Gasolina	FWD	1498	65	88	10.97-10.01	*