

LISTA DE APLICACIONES - BUYERS GUIDE

RB0059



8 424073 116420

Qty: 944

Weight: 605

O.E.M.	MAKE
001 683 74 00	TALBOT
0060 712 608	ALFA ROMEO
0060 714 402	ALFA ROMEO
0060 714 404	ALFA ROMEO
0060 723 585	ALFA ROMEO
10 569 815 11	ALFA ROMEO
135 828 00	TALBOT
16 05 147	OPEL
16 05 148	OPEL
168 374 00	TALBOT
3 100 021 9	VOLVO
3 343 838 0	VOLVO
34 11 1 102 650	BMW
34 21 1 103 209	BMW
34 21 1 103 322	BMW
34 21 1 103 746	BMW
502 808	DAF
565 600 900	NSU
565 602 902	NSU
89 10 499	SAAB
89 93 834	SAAB
89 94 832	SAAB
901 351 963 35	PORSCHE
911 352 939 01	PORSCHE
983 805 775 3	NSU

4x

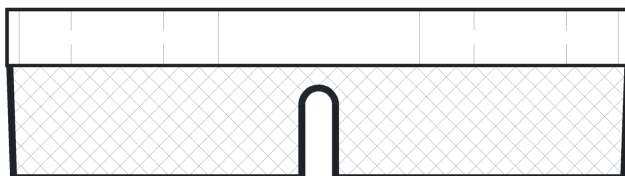
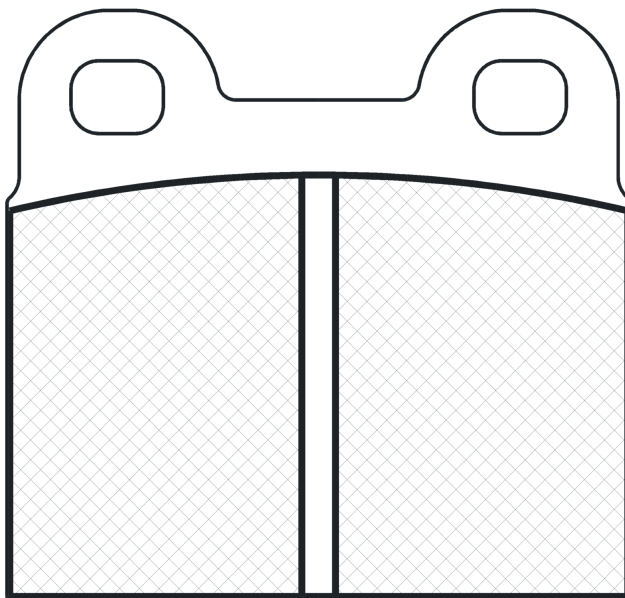

RB0059



Ate - Teves

55.8x53.1x15

WVA	FMSI
20009	D21-755
20010	D30-7200

Sin Filas



Trac.	CC	Kw	CV	
				Front / Rear

ALFA ROMEO

1750-2000 BERLINA (105_) 03.68-07.75

Sedán (Executive car-E Segment)

1.7 (AR 10525)	Gasolina	RWD	1779	80	109	04.68-11.71	*
1750 (105,48) (AR 00548)	Gasolina	RWD	1779	83	113	03.68-10.72	*
2000 (105) (AR 10520)	Gasolina	RWD	1962	97	132	10.71-07.75	*

GIULIA (105_) 01.62-03.79

Sedán (Compact executive car-D Segment)

1300 (105) (AR 00506)	Gasolina	RWD	1290	57	78	01.64-08.69	*
1300 Super (115) (AR 00530)	Gasolina	RWD	1290	64	87	01.74-12.78	*
1.6 T.I. (105) (AR 00112)	Gasolina	RWD	1570	68	92	01.62-12.78	*
1600 Super (105,14) (AR 00526)	Gasolina	RWD	1570	71	97	06.64-08.69	*
1600 Super (115) (AR 00526)	Gasolina	RWD	1570	76	103	01.74-12.78	*
1.6 T.I. Super (105) (AR 00516)	Gasolina	RWD	1570	82	112	01.63-12.78	*
1.8 D (4.108)	Diesel	RWD	1760	38	52	06.76-12.78	*

GIULIA GT (105_) 01.62-12.80

Coupé (Compact executive car-D Segment)

1300 Super (AR 00530)	Gasolina	RWD	1290	64	87	01.74-12.78	*
1600 Sprint (AR 00112)	Gasolina	RWD	1570	67	91	01.62-12.64	*
1600 Super (AR 00526)	Gasolina	RWD	1570	76	103	01.74-12.78	*
1600 Sprint (101) (AR 00121)	Gasolina	RWD	1570	83	113	01.63-12.65	*

GIULIA Spider (101_) 03.62-02.69

Cabrio (Compact executive car-D Segment)

1.6 (AR 00112)	Gasolina	RWD	1570	68	92	03.62-12.66	*
1.6 (101.23) (AR 00121)	Gasolina	RWD	1570	82	112	03.62-02.69	*
1.6 (101.23) (AR 00516)	Gasolina	RWD	1570	82	112	03.62-02.69	*

LISTA DE APLICACIONES - BUYERS GUIDE

GT (105_) 03.63-12.77					Coupé (Compact executive car-D Segment)			
1300 Junior (105) (AR 00530)	Gasolina	RWD	1290	64	87	01.66-12.77	*	
1600 (105) (AR 00526 S)	Gasolina	RWD	1570	75	102	03.63-12.66	*	
1600 (115) (AR 00526 S)	Gasolina	RWD	1570	76	103	09.72-12.77	*	
1600 (105) (AR 00536)	Gasolina	RWD	1570	80	109	01.66-12.68	*	
1600 (115) (AR 00536)	Gasolina	RWD	1570	80	109	06.71-12.77	*	
A 1600 (105) (AR 10538)	Gasolina	RWD	1570	83	113	01.65-12.70	*	
1.8 (AR 10525)	Gasolina	RWD	1779	80	109	04.68-11.71	*	
V 1750 (105) (AR 00548)	Gasolina	RWD	1779	83	113	01.67-12.72	*	
V 2000 (105) (AR 10527)	Gasolina	RWD	1962	96	131	01.71-12.77	*	
GTA (113_) 05.68-12.76					Coupé (Sports car-S Segment)			
1.3 Junior (AR 10531)	Gasolina	RWD	1290	81	110	05.68-12.76	*	
1.3 Junior (AR 10534)	Gasolina	RWD	1290	117	160	05.68-12.76	*	
MONTREAL (105_) 12.72-03.79					Coupé (Sports car-S Segment)			
2.6 (105,64) (AR 10832)	Gasolina	RWD	2593	143	194	12.72-03.79	*	
SPIDER II (105_) 03.66-12.77					Cabrio (Sports car-S Segment)			
1300 (10591) (AR 00530)	Gasolina	RWD	1290	64	87	01.68-12.77	*	
1600 (10503) (AR 00526)	Gasolina	RWD	1570	80	109	03.66-12.68	*	
1600 (10503) (AR 00536)	Gasolina	RWD	1570	80	109	03.66-12.68	*	
1600 (10503) (AR 01600)	Gasolina	RWD	1570	80	109	03.66-12.68	*	
1.7 (AR 10525)	Gasolina	RWD	1779	80	109	04.68-11.71	*	
1750 (10557) (AR 00548)	Gasolina	RWD	1779	83	113	01.67-12.71	*	
2000 (10512, 10524) (AR 00512)	Gasolina	RWD	1962	96	131	01.71-12.77	*	
SPIDER III (115_) 01.71-12.93					Cabrio (Sports car-S Segment)			
1600 (11535) (AR 00526)	Gasolina	RWD	1570	76	103	03.76-12.90	*	
1600 (115A2) (AR 01563)	Gasolina	RWD	1570	79	107	01.90-12.93	*	
1600 (11507) (AR 00536)	Gasolina	RWD	1570	80	109	03.71-12.79	*	
2.0 (115A1A) (AR 01615)	Gasolina	RWD	1962	81	110	01.74-12.84	*	
2000 (115680, 115681) (AR 01544)	Gasolina	RWD	1962	85	116	08.86-12.90	*	
2000 (115A1A) (AR 01588)	Gasolina	RWD	1962	88	120	01.90-12.93	*	
2000 (11538, 115661) (AR 00515)	Gasolina	RWD	1962	92	125	08.86-12.90	*	
2000 (11538, 115A1) (AR 00515)	Gasolina	RWD	1962	93	126	01.77-12.93	*	
2000 (11538, 115A1) (AR 01590)	Gasolina	RWD	1962	93	126	01.77-12.93	*	
2000	Gasolina	RWD	1962	96	131	01.71-12.77	*	
BMW								
2500-3.3 / NEW SIX (E3) 10.68-04.77					Sedán (Luxury car-F Segment)			
2500 (M30 B25)	Gasolina	RWD	2494	110	150	10.68-04.77	*	
2800 (M30 B28)	Gasolina	RWD	2788	125	170	10.68-07.75	*	
V8 (502) 09.54-07.66					Coupé (Grand Tourer-S Segment)			
2.6	Gasolina	RWD	2580	81	110	10.58-11.61	*	
2600	Gasolina	RWD	2580	81	110	09.61-12.64	*	
3.2	Gasolina	RWD	3168	88	120	11.58-11.61	*	
3.2 Super	Gasolina	RWD	3168	103	140	11.58-11.61	*	
3200 L	Gasolina	RWD	3168	103	140	09.61-12.64	*	
3200 CS	Gasolina	RWD	3168	118	160	07.62-07.66	*	
3200 S	Gasolina	RWD	3168	118	160	09.61-12.64	*	
COS MOTORS								

LISTA DE APLICACIONES - BUYERS GUIDE

BAT 18								
-		Diesel					01.53-	*
DAF								
55 10.68-09.72					[CAMBIADO]:Break (Compact car-C Segment)			
1.1 (DBB 110E)		Gasolina	RWD	1108	33	45	10.68-09.72	*
55 05.68-09.72					Coupé (Compact car-C Segment)			
1.1 (DBB 110E)		Gasolina	RWD	1108	33	45	05.68-09.72	*
1.1 MARATHON (110F)		Gasolina	RWD	1108	40	54	12.71-09.72	*
55 10.67-09.72					Sedán (Compact car-C Segment)			
1.1 (DBB 110E)		Gasolina	RWD	1108	33	45	10.67-09.72	*
1.1 MARATHON (110F)		Gasolina	RWD	1108	40	54	12.71-09.72	*
66 10.72-08.75					[CAMBIADO]:Break (Compact car-C Segment)			
1.1 (110E)		Gasolina	RWD	1108	35	48	10.72-08.75	*
1.1 MARATHON (110G)		Gasolina	RWD	1108	40	54	10.72-08.75	*
1300 MARATHON (B13,0S)		Gasolina	RWD	1289	42	57	09.73-08.75	*
66 09.73-08.75					Coupé (Compact car-C Segment)			
1300 MARATHON (B13,0S)		Gasolina	RWD	1289	42	57	09.73-08.75	*
66 10.72-08.75					Sedán (Compact car-C Segment)			
1.1 (110E)		Gasolina	RWD	1108	35	48	10.72-08.75	*
1.1 SL (110G)		Gasolina	RWD	1108	40	54	10.72-08.75	*
1300 MARATHON (B13,0S)		Gasolina	RWD	1289	42	57	09.73-08.75	*
NISSAN								
LAUREL IV (JC31) 11.80-12.85					Sedán (Executive car-E Segment)			
2.4 (L24)		Gasolina	RWD	2393	83	113	01.81-01.84	*
NSU								
PRINZ 08.61-03.74					Sedán (Compact car-C Segment)			
600 (47)		Gasolina	RWD	583	22	30	09.69-11.71	*
600 4L (47)		Gasolina	RWD	583	22	30	08.61-07.70	*
1000 (67)		Gasolina	RWD	996	29	39	09.69-03.74	*
1200 (67)		Gasolina	RWD	1177	48	65	09.69-03.74	*
RO 80 II 01.73-12.78					Sedán (Compact car-C Segment)			
2.0		Gasolina	FWD	1995			01.73-	*
OPEL								
KADETT B 09.65-08.73					[CAMBIADO]:Break (Compact car-C Segment)			
1.1 (11 N)		Gasolina	RWD	1078	33	45	09.65-07.71	*
1.1 (11 N)		Gasolina	RWD	1078	37	50	08.71-08.73	*
1.1 (11 S)		Gasolina	RWD	1078	40	55	09.65-07.71	*
1.2 (12 S)		Gasolina	RWD	1196	44	60	08.71-08.73	*
1.5 (15 S)		Gasolina	RWD	1488	47	64	08.71-07.73	*
KADETT B 09.65-08.73					Coupé (Compact car-C Segment)			
1.1 (11 N)		Gasolina	RWD	1078	33	45	09.65-07.71	*
1.1 (11 N)		Gasolina	RWD	1078	37	50	08.71-08.73	*
1.1 (11 S)		Gasolina	RWD	1078	40	55	09.65-07.71	*
1.1 (11 SR)		Gasolina	RWD	1078	44	60	11.66-07.71	*
1.2 (12 S)		Gasolina	RWD	1196	44	60	08.71-08.73	*
1.5 (15 NT)		Gasolina	RWD	1488	47	64	08.71-07.73	*

LISTA DE APLICACIONES - BUYERS GUIDE

KADETT B / RALLYE B 09.65-08.73					Sedán (Compact car-C Segment)			
1.1 (11 N)		Gasolina	RWD	1078	33	45	09.65-07.71	*
1.1 (11 N)		Gasolina	RWD	1078	37	50	08.71-08.73	*
1.1 S (11 S)		Gasolina	RWD	1078	40	55	09.65-07.71	*
1.1 SR (11 SR)		Gasolina	RWD	1078	44	60	11.66-07.71	*
1.2 S (12 S)		Gasolina	RWD	1196	44	60	08.71-08.73	*
PORSCHÉ								
356 09.47-03.68					Coupé (Sports car-S Segment)			
C 1600 (616.15)		Gasolina	RWD	1582	55	75	01.63-12.65	*
C 1600 SC (616/16)		Gasolina	RWD	1582	70	95	01.63-12.65	*
356 Speedster 01.50-12.65					Cabrio (Sports car-S Segment)			
C 1600 (616.15)		Gasolina	RWD	1582	55	75	01.63-12.65	*
C 1600 SC (616/16)		Gasolina	RWD	1582	70	95	01.63-12.65	*
911 01.63-11.90					Coupé (Sports car-S Segment)			
2.0 T (901.03)		Gasolina	RWD	1991	81	110	08.68-02.72	*
2.0 T (901.13)		Gasolina	RWD	1991	81	110	08.68-02.72	*
911 11.64-11.90					Targa (Sports car-S Segment)			
2.0 T (901.03)		Gasolina	RWD	1991	81	110	06.67-02.72	*
2.0 T (901.13)		Gasolina	RWD	1991	81	110	06.67-02.72	*
912 01.65-02.70					Coupé (Sports car-S Segment)			
1.6 (616.36)		Gasolina	RWD	1582	66	90	01.65-12.69	*
1.6 (616.39)		Gasolina	RWD	1582	66	90	01.65-12.69	*
1.6 (616.40)		Gasolina	RWD	1582	66	90	01.65-12.69	*
912 03.65-02.70					Targa (Sports car-S Segment)			
1.6 (616.36)		Gasolina	RWD	1582	66	90	03.65-02.70	*
1.6 (616.39)		Gasolina	RWD	1582	66	90	03.65-02.70	*
1.6 (616.40)		Gasolina	RWD	1582	66	90	03.65-02.70	*
914 01.69-02.76					Targa (Sports car-S Segment)			
1.8 (EC)		Gasolina	RWD	1795	56	76	01.74-12.75	*
1.8 (AN)		Gasolina	RWD	1795	63	86	08.73-02.76	*
SAAB								
900 06.78-06.94					[CAMBIADO]:Fastback (Compact executive car-D Segment)			
2.0 c (B 20)		Gasolina	FWD	1985	74	101	09.79-12.88	*
2.0 c (B201XC)		Gasolina	FWD	1985	74	101	09.79-12.88	*
2.0 c (B20T)		Gasolina	FWD	1985	79	107	09.78-08.84	*
2.0 c (BT 20)		Gasolina	FWD	1985	79	107	09.78-08.84	*
2.0 i (B201XI)		Gasolina	FWD	1985	85	115	11.80-12.88	*
2.0 i (BI 20)		Gasolina	FWD	1985	85	115	11.80-12.88	*
2.0 EMS (BI 20)		Gasolina	FWD	1985	87	118	09.78-08.79	*
2.0 Turbo (B201S)		Gasolina	FWD	1985	107	146	09.78-07.85	*
2.0 Turbo (BSI 20)		Gasolina	FWD	1985	107	146	09.78-07.85	*
900 (AC4, AM4) 01.79-12.93					Sedán (Compact executive car-D Segment)			
2.0 c (B20T)		Gasolina	FWD	1985	79	107	11.80-08.84	*
2.0 c (BT 20)		Gasolina	FWD	1985	79	107	11.80-08.84	*
2.0 (B201)		Gasolina	FWD	1985	80	109	09.83-03.84	*
2.0 i (B201XI)		Gasolina	FWD	1985	85	115	11.80-08.90	*
2.0 i (BI 20)		Gasolina	FWD	1985	85	115	11.80-08.90	*

LISTA DE APLICACIONES - BUYERS GUIDE

2.0 EMS (BI 20)	Gasolina	FWD	1985	87	118	01.79-12.80	*
2.0 Turbo (B201S)	Gasolina	FWD	1985	107	146	10.80-07.85	*
2.0 Turbo (BSI 20)	Gasolina	FWD	1985	107	146	10.80-07.85	*
99 08.68-01.87				[CAMBIADO]:Fastback (Compact car-C Segment)			
1.7 (B170)	Gasolina	FWD	1709	59	80	08.68-05.71	*
1.85 (WF)	Gasolina	FWD	1854	65	88	10.70-05.74	*
2.0 Turbo (BSI 20)	Gasolina	FWD	1985	107	146	10.77-06.80	*
TALBOT							
SIMCA 1000 10.61-12.78				Sedán (Compact car-C Segment)			
1.1 Rallye (351)	Gasolina	RWD	1118	39	53	10.70-09.72	*
1.1 Spezial	Gasolina	RWD	1118	39	53	10.68-09.75	*
1006 SR, GLS (3E1)	Gasolina	RWD	1118	40	54	10.76-07.78	*
1.3 Rallye 1 (1G1)	Gasolina	RWD	1294	44	60	10.72-09.77	*
1.3 Spezial (1G1)	Gasolina	RWD	1294	44	60	08.74-09.77	*
SIMCA 1100 10.68-01.80				[CAMBIADO]:Fastback (Supermini car-B Segment)			
0.9 LE	Gasolina	FWD	944	35	47	10.76-01.80	*
0.9 LS	Gasolina	FWD	944	35	48	10.70-05.72	*
1.1 LE, LX, GLS, ES (3E1)	Gasolina	FWD	1118	37	50	10.76-01.80	*
1.1 LS, GLS (E1/BTC)	Gasolina	FWD	1118	40	54	11.73-09.77	*
1.1 LS, GLS	Gasolina	FWD	1118	41	56	10.68-05.72	*
1.1 LE, LX, GLS, ES (3E1A)	Gasolina	FWD	1118	43	58	10.76-01.80	*
1.1 LS, GLS	Gasolina	FWD	1118	44	60	10.68-05.76	*
SIMCA 1100 Break/Tourisme 10.68-01.80				[CAMBIADO]:Break (Supermini car-B Segment)			
1.1 (E1/BTC)	Gasolina	FWD	1118	37	50	10.76-01.80	*
1.1 (3E1)	Gasolina	FWD	1118	41	56	10.68-05.72	*
1.1	Gasolina	FWD	1118	44	60	10.70-05.72	*
1.1 (3E1A)	Gasolina	FWD	1118	44	60	10.76-09.79	*
VOLVO							
66 (64) 10.75-11.79				[CAMBIADO]:Break (Compact car-C Segment)			
DL 1.1 (B 11)	Gasolina	RWD	1108	33	45	10.75-11.79	*
GL 1.3 (B 130)	Gasolina	RWD	1289	42	57	10.75-11.79	*
66 (31, 36) 08.75-08.78				Sedán (Compact car-C Segment)			
DL 1.1 (B 11)	Gasolina	RWD	1108	33	45	08.75-08.78	*
GL 1.3 (B 130)	Gasolina	RWD	1289	42	57	08.75-08.78	*
VW							
1500,1600 (31) 04.61-12.73				Sedán (Compact car-C Segment)			
1.5 (K)	Gasolina	RWD	1493	33	45	04.61-07.73	*
1.5 S	Gasolina	RWD	1493	40	54	08.63-07.65	*
1.6 L (P)	Gasolina	RWD	1584	37	50	07.64-07.73	*
1.6 (T)	Gasolina	RWD	1584	40	54	08.65-07.73	*
1.6 (U)	Gasolina	RWD	1584	40	54	08.65-07.73	*
1.6 TL (T)	Gasolina	RWD	1584	40	54	08.65-07.73	*
1.6 TL (U)	Gasolina	RWD	1584	40	54	08.65-07.73	*
1500,1600 / FASTBACK (31) 08.65-03.75				[CAMBIADO]:Fastback (Compact car-C Segment)			
1.5 L (K)	Gasolina	RWD	1493	33	45	07.68-07.73	*
1.6 TL (T)	Gasolina	RWD	1584	40	54	08.65-07.73	*
1.6 TL (U)	Gasolina	RWD	1584	40	54	08.65-07.73	*

LISTA DE APLICACIONES - BUYERS GUIDE

1500,1600 Variant / SQUAREBACK (36) 04.61-07.73					[CAMBIADO]:Break (Compact car-C Segment)			
1.5 (K)		Gasolina	RWD	1493	33	45	04.61-07.73	*
1.5 S		Gasolina	RWD	1493	40	54	08.63-07.65	*
1.6 L (T)		Gasolina	RWD	1584	40	54	08.65-07.73	*
1.6 L (U)		Gasolina	RWD	1584	40	54	08.65-07.73	*
KAEFER / BEETLE / CAROCHA / COCCINELLE / FUSCA / KEVER (15) 07.49-03.81					Cabrio (Supermini car-B Segment)			
1302 1.3 (AC)		Gasolina	RWD	1285	29	39	08.70-07.74	*
1303 1.3 (AB)		Gasolina	RWD	1285	32	44	07.70-03.81	*
1302 1.6 (AF)		Gasolina	RWD	1584	34	46	08.70-07.74	*
1303 1.6 (AE)		Gasolina	RWD	1584	35	48	08.70-07.74	*
1303 1.6 (AH)		Gasolina	RWD	1584	35	48	08.70-07.74	*
1303 1.6 (AK)		Gasolina	RWD	1584	35	48	08.70-07.74	*
1302,1303 1.6 (AD)		Gasolina	RWD	1584	37	50	07.70-06.79	*
KAEFER / BEETLE / CAROCHA / COCCINELLE / FUSCA / KEVER / SUPER BEETLE 12.47-08.03					Sedán (Supermini car-B Segment)			
1200 1.2 (11) (D)		Gasolina	RWD	1192	25	34	01.60-12.85	*
1302 1.3 (AC)		Gasolina	RWD	1285	29	39	08.70-07.75	*
1300 1.3 (11) (AB)		Gasolina	RWD	1285	32	44	01.70-01.73	*
1302 1.3 (11) (AB)		Gasolina	RWD	1285	32	44	08.70-08.72	*
1303 1.3 (13) (AB)		Gasolina	RWD	1285	32	44	08.72-07.75	*
1303 1.3 (13) (AR)		Gasolina	RWD	1285	32	44	08.72-07.75	*
1500 1.5 (11) (H)		Gasolina	RWD	1493	32	44	08.66-11.73	*
1600 i (Mexico) (ACD)		Gasolina	RWD	1584	34	46	10.92-07.03	*
1302 1.6 (AE)		Gasolina	RWD	1584	35	48	07.71-07.74	*
1302 1.6 (AH)		Gasolina	RWD	1584	35	48	07.71-07.74	*
1302 1.6 (AK)		Gasolina	RWD	1584	35	48	07.71-07.74	*
1303 1.6 (13) (AD)		Gasolina	RWD	1584	35	48	08.72-12.79	*
1.6		Gasolina	FWD	1584	36	49	09.92-08.03	*
1302 1.6 (11) (AD)		Gasolina	RWD	1584	37	50	01.70-01.73	*
1303 LS, S 1.6 (13) (AD)		Gasolina	RWD	1584	37	50	08.72-12.79	*
1303 LS, S 1.6 (13) (AJ)		Gasolina	RWD	1584	37	50	08.72-12.79	*
1303 LS, S 1.6 (13) (AS)		Gasolina	RWD	1584	37	50	08.72-12.79	*
1500 1.6 (AD)		Gasolina	RWD	1584	37	50	07.70-01.73	*