

LISTA DE APLICACIONES - BUYERS GUIDE

78RBD24682



8 424073 154477

Weight: 15.876

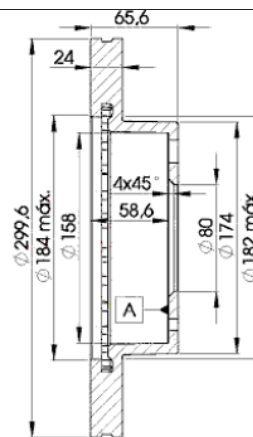
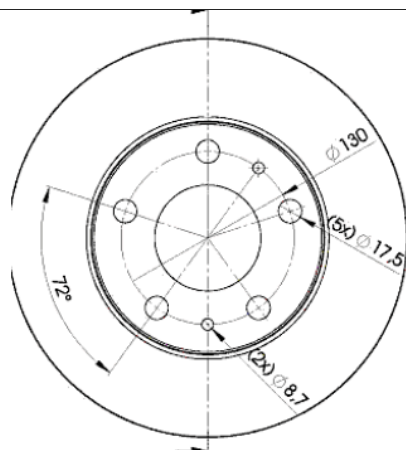

78RBD24682

E1 90R-02C0538/0082



Ø300x24x65.5

Sin Filas

O.E.M.	MAKE
1 307 356 080	FIAT
1341045080	FIAT
1606400780	CITROËN
1606401680	PEUGEOT
1607872280	CITROËN
1618863880	CITROËN
4 680 623 4	FIAT
4,25E+06	CITROËN
4246.K2	PEUGEOT
4246.K3	PEUGEOT
4246.Y3	CITROËN
4246.Y5	PEUGEOT
4249.35	PEUGEOT
4249.36	CITROËN
4249A0	CITROËN
4249G5	CITROËN
4249H2	CITROËN
4249H9	CITROËN
5 172 837 8	FIAT
5 174 024 7	FIAT
51858362	FIAT
51858363	FIAT
71739637	FIAT
E169016	CITROËN
E169154	CITROËN



Trac.	CC	Kw	CV
-------	----	----	----



Front / Rear

CITROËN

JUMPER II / RELAY (230L) 02.94-08.02					[CAMBIADO]:Furgón (LCVs-N1 Segment)			
2.0 (RFW (XU10J2U))	Gasolina	FWD	1998	80	109	03.94-04.02	*	
2.0 (XU10J2)	Gasolina	FWD	1998	81	110	04.02-06.06	*	
2.0 bivalent (XU10J2)	Gasol./Gas (CNG)	FWD	1998	81	110	02.03-06.06	*	
1.9 TD (DHX (XUD9TF/BTF))	Diesel	FWD	1905	66	90	03.94-04.02	*	
1.9 TD (D8C (XUD9UTF))	Diesel	FWD	1905	68	92	03.94-04.02	*	
2.0 HDi (RHV (DW10TD))	Diesel	FWD	1997	62	84	11.01-04.02	*	
2.0 HDi (RHV (DW10UTD))	Diesel	FWD	1997	62	84	04.02-06.06	*	
2.2 HDi (4HY (DW12UTED))	Diesel	FWD	2179	74	101	04.02-06.06	*	
2.5 D (T9A (DJ5))	Diesel	FWD	2446	63	86	03.94-04.02	*	
2.5 D 4x4 (T9A (DJ5))	Diesel	4WD	2446	63	86	03.00-04.02	*	
2.5 DT 4x4 (THZ (DJ5T))	Diesel	4WD	2446	76	103	10.96-08.97	*	
2.5 TD (T8A (DJ5T))	Diesel	FWD	2446	76	103	03.94-04.02	*	
2.5 TDI (THX (DJ5TED))	Diesel	FWD	2446	79	107	12.96-11.00	*	
2.5 TDI 4x4 (THX (DJ5TED))	Diesel	4WD	2446	79	107	03.00-11.00	*	
2.8 HDi (8140.43S)	Diesel	FWD	2798	94	128	09.00-04.02	*	
2.8 HDi (8140.43S)	Diesel	FWD	2798	94	128	04.02-06.06	*	
2.8 HDi 4x4 (8140.43S)	Diesel	4WD	2798	94	128	09.00-04.02	*	
2.8 HDi 4x4 (8140.43S)	Diesel	4WD	2798	94	128	04.02-06.06	*	
2.8 HDi (8140.43N)	Diesel	FWD	2798	107	146	04.04-06.06	*	
JUMPER II / RELAY (230P) 02.94-04.02					Bus (Minibus-M2-Segment)			
2.0 (RFW (XU10J2U))	Gasolina	FWD	1998	80	109	02.94-04.02	*	

LISTA DE APLICACIONES - BUYERS GUIDE

2.0 (XU10J2)		Gasolina	FWD	1998	81	110	04.02-06.06	*	
2.0 bivalent (XU10J2)		Gasol./Gas (CNG)	FWD	1998	81	110	02.03-06.06	*	
2.0 HDi (RHV (DW10UTD))		Diesel	FWD	1997	62	84	04.02-06.06	*	
2.2 HDi (4HY (DW12UTED))		Diesel	FWD	2179	74	101	04.02-06.06	*	
2.5 D (T9A (DJ5))		Diesel	FWD	2446	63	86	08.94-04.02	*	
2.5 D 4x4 (T9A (DJ5))		Diesel	4WD	2446	63	86	08.96-04.02	*	
2.5 TD (T8A (DJ5T))		Diesel	FWD	2446	76	103	08.94-04.02	*	
2.5 TD 4x4 (T8A (DJ5T))		Diesel	4WD	2446	76	103	08.96-04.02	*	
2.5 TDI (THX (DJ5TED))		Diesel	FWD	2446	79	107	12.96-11.00	*	
2.5 TDI 4x4 (THX (DJ5TED))		Diesel	4WD	2446	79	107	12.96-11.00	*	
2.8 HDi (8140.43S)		Diesel	FWD	2798	94	128	09.00-04.02	*	
2.8 HDi (8140.43S)		Diesel	FWD	2798	94	128	04.02-06.06	*	
2.8 HDi 4x4 (8140.43S)		Diesel	4WD	2798	94	128	09.00-04.02	*	
2.8 HDi A las 4 ruedas (8140.43S)		Diesel	4WD	2798	94	128	04.02-06.06	*	
JUMPER II / RELAY (230) 03.94-04.02							Caja/Chasis (LCVs-N1 Segment)		
2.0 (RFW (XU10J2U))		Gasolina	FWD	1998	80	109	03.94-04.02	*	
2.0 HDi (RHV (DW10UTD))		Diesel	FWD	1997	62	84	04.02-06.06	*	
2.2 HDi (4HY (DW12UTED))		Diesel	FWD	2179	74	101	04.02-06.06	*	
2.2 HDi (4HY (DW12UTED))		Diesel	FWD	2179	74	101	02.02-06.06	*	
2.5 D (T9A (DJ5))		Diesel	FWD	2446	63	86	03.94-04.02	*	
2.5 D 4x4 (T9A (DJ5))		Diesel	4WD	2446	63	86	03.00-04.02	*	
2.5 TDI (THX (DJ5TED))		Diesel	FWD	2446	79	107	12.96-04.02	*	
2.5 TDI 4x4 (THX (DJ5TED))		Diesel	4WD	2446	79	107	03.00-04.02	*	
2.8 HDi (8140.43S)		Diesel	FWD	2798	94	128	09.00-04.02	*	
2.8 HDi (8140.43S)		Diesel	FWD	2798	94	128	04.02-06.06	*	
2.8 HDi (8140.43N)		Diesel	FWD	2798	107	146	05.04-06.06	*	
JUMPER III / RELAY 04.06-							[CAMBIADO]:Furgón (LCVs-N1 Segment)		
2.0 BlueHDi 110 (AHM (DW10FUE))		Diesel	FWD	1997	81	110	11.15-09.19	*	
2.0 BlueHDi 130 (AHN (DW10FUD))		Diesel	FWD	1997	96	130	11.15-09.19	*	
2.0 BlueHDi 160 (AHP (DW10FUC))		Diesel	FWD	1997	120	163	11.15-09.19	*	
2.0 BlueHDi 160 4x4 (AHP (DW10FUC))		Diesel	4WD	1997	120	163	11.15-09.19	*	
2.2 HDi 100 (4HV (P22DTE))		Diesel	FWD	2198	74	101	04.06-12.12	*	
2.2 HDi 110 (4HG (P22DTE))		Diesel	FWD	2198	81	110	07.11-12.20	*	
2.2 HDi 120 (4HU (P22DTE))		Diesel	FWD	2198	88	120	04.06-12.16	*	
2.2 HDi 130 (4HH (P22DTE))		Diesel	FWD	2198	96	130	07.11-	*	
2.2 HDi 150 (4HJ (P22DTE))		Diesel	FWD	2198	110	150	07.11-	*	
3.0 HDi 160 (F1CE0481D (F30DT))		Diesel	FWD	2999	116	157	09.06-12.15	*	
3.0 HDi 180 (F1CE3481E (F30DTE))		Diesel	FWD	2999	130	177	07.11-	*	
JUMPER III / RELAY 04.06-							Bus (Minibus-M2-Segment)		
2.0 BlueHDi 110 (AHM (DW10FUE))		Diesel	FWD	1997	81	110	07.15-09.19	*	
2.0 BlueHDi 130 (AHN (DW10FUD))		Diesel	FWD	1997	96	130	07.15-09.19	*	
2.0 BlueHDi 160 (AHP (DW10FUC))		Diesel	FWD	1997	120	163	07.15-09.19	*	
2.2 HDi 100 (4HV (P22DTE))		Diesel	FWD	2198	74	101	04.06-	*	
2.2 HDi 110 (4HG (P22DTE))		Diesel	FWD	2198	81	110	07.11-12.20	*	
2.2 HDi 120 (4HU (P22DTE))		Diesel	FWD	2198	88	120	04.06-12.16	*	
2.2 HDi 130 (4HH (P22DTE))		Diesel	FWD	2198	96	130	07.11-	*	
2.2 HDi 150 (4HJ (P22DTE))		Diesel	FWD	2198	110	150	07.11-	*	
3.0 HDi 160 (F1CE0481D (F30DT))		Diesel	FWD	2999	116	157	09.06-	*	
3.0 HDi 180 (F1CE3481E (F30DTE))		Diesel	FWD	2999	130	177	07.11-	*	

LISTA DE APLICACIONES - BUYERS GUIDE

JUMPER III / RELAY 04.06-					Caja/Chasis (LCVs-N1 Segment)			
2.0 BlueHDi 110 (AHM (DW10FUE))		Diesel	FWD	1997	81	110	11.15-09.19	*
2.0 BlueHDi 130 (AHN (DW10FUD))		Diesel	FWD	1997	96	130	11.15-09.19	*
2.0 BlueHDi 130 4x4 (AHN (DW10FUD))		Diesel	4WD	1997	96	130	11.15-09.19	*
2.0 BlueHDi 160 (AHP (DW10FUC))		Diesel	FWD	1997	120	163	11.15-09.19	*
2.0 BlueHDi 160 4x4 (AHP (DW10FUC))		Diesel	4WD	1997	120	163	11.15-09.19	*
2.2 HDi 100 (4HV (P22DTE))		Diesel	FWD	2198	74	101	04.06-	*
2.2 HDi 110 (4HG (P22DTE))		Diesel	FWD	2198	81	110	07.11-12.20	*
2.2 HDi 120 (4HU (P22DTE))		Diesel	FWD	2198	88	120	04.06-12.16	*
2.2 HDi 130 (4HH (P22DTE))		Diesel	FWD	2198	96	130	07.06-	*
2.2 HDi 150 (4HJ (P22DTE))		Diesel	FWD	2198	110	150	07.11-	*
3.0 HDi 160 (F1CE0481D (F30DT))		Diesel	FWD	2999	116	157	09.06-12.15	*
3.0 HDi 180 (F1CE3481E (F30DTE))		Diesel	FWD	2999	130	177	07.11-	*

FIAT

DUCATO II (230_) 03.94-05.05					[CAMBIADO]:Furgón (LCVs-N1 Segment)			
2.0		Gasolina	FWD	1998	74	101	06.94-12.95	*
2.0 (RFW)		Gasolina	FWD	1998	80	109	03.94-04.02	*
2.0 4x4 (RFW)		Gasolina	4WD	1998	80	109	11.94-04.02	*
2.0 (RFL)		Gasolina	FWD	1998	81	110	12.01-07.06	*
2.0 4x4 (RFL)		Gasolina	4WD	1998	81	110	05.02-07.06	*
2.0 Bipower (RFL)		Gasol./Gas (CNG)	FWD	1998	81	110	11.02-07.06	*
1.9 D (DJY)		Diesel	FWD	1905	50	68	04.98-04.02	*
1.9 TD (DHX)		Diesel	FWD	1905	59	80	05.98-11.01	*
1.9 TD (DHX)		Diesel	FWD	1905	66	90	04.98-04.02	*
1.9 TD (DHX (XUD9TF/L))		Diesel	FWD	1905	66	90	04.98-04.02	*
1.9 D (230 A2.000)		Diesel	FWD	1929	51	69	03.94-04.02	*
1.9 TD CAT (230 A4.000)		Diesel	FWD	1929	59	80	08.94-04.02	*
1.9 TD (230 A3.000)		Diesel	FWD	1929	60	82	03.94-04.02	*
2.0 JTD (RHV)		Diesel	FWD	1997	62	84	10.01-04.02	*
2.0 JTD (RHV)		Diesel	FWD	1997	62	84	12.01-07.06	*
2.3 JTD (F1AE0481C)		Diesel	FWD	2286	81	110	12.01-07.06	*
2.5 TD (8140.47)		Diesel	FWD	2499	80	109	06.94-08.98	*
2.5 TD 4x4 (8140.47)		Diesel	4WD	2499	80	109	11.94-04.98	*
2.5 TD 4x4 (8140.47)		Diesel	4WD	2499	85	116	11.94-04.98	*
2.5 D (8140.67)		Diesel	FWD	2500	62	84	03.94-04.02	*
2.5 TDI (8140.47R)		Diesel	FWD	2500	80	109	03.94-04.02	*
2.5 TDI (8140.47)		Diesel	FWD	2500	85	116	03.94-04.02	*
2.5 TDI 4x4 (8140.47)		Diesel	4WD	2500	85	116	05.98-04.02	*
2.8 JTD (8140.43S)		Diesel	FWD	2798	94	128	11.00-04.02	*
2.8 JTD (8140.43S)		Diesel	FWD	2798	94	128	12.01-12.11	*
2.8 JTD 4x4 (8140.43S)		Diesel	4WD	2798	94	128	11.00-04.02	*
2.8 JTD 4x4 (8140.43S)		Diesel	4WD	2798	94	128	12.01-07.06	*
2.8 TD (8140.43)		Diesel	FWD	2799	90	122	12.01-07.06	*
2.8 TD		Diesel	RWD	2799	90	122	11.03-07.06	*
2.8 TD 4x4 (8140.43)		Diesel	4WD	2799	90	122	05.98-09.01	*
2.8 D (8140.63)		Diesel	FWD	2800	64	87	05.98-04.02	*
2.8 D 4x4 (8140.63)		Diesel	4WD	2800	64	87	08.98-04.02	*
2.8 TDI (8140.43)		Diesel	FWD	2800	90	122	10.97-04.02	*
2.8 TDI 4x4 (8140.43)		Diesel	4WD	2800	90	122	06.99-04.02	*

LISTA DE APLICACIONES - BUYERS GUIDE

2.8 JTD Power (8140.43N)	Diesel	FWD	2800	107	146	04.04-07.06	*
DUCATO II (230_) 03.94-05.05				Bus (Minibus-M2-Segment)			
2.0	Gasolina	FWD	1998	74	101	06.94-12.95	*
2.0 4x4 (RFW)	Gasolina	4WD	1998	80	109	11.94-11.01	*
2.0 Panorama/Combinato (RFW)	Gasolina	FWD	1998	80	109	03.94-04.02	*
2.0 (RFL)	Gasolina	FWD	1998	81	110	12.01-07.06	*
2.0 4x4 (RFL)	Gasolina	4WD	1998	81	110	05.02-07.06	*
2.0 Bipower (RFL)	Gasol./Gas (CNG)	FWD	1998	81	110	11.02-07.06	*
1.9 D (DJY)	Diesel	FWD	1905	50	68	04.98-04.02	*
1.9 D (DHX)	Diesel	FWD	1905	59	80	05.98-11.01	*
1.9 TD (DHX)	Diesel	FWD	1905	66	90	04.98-04.02	*
1.9 TD (DHX (XUD9TF/L))	Diesel	FWD	1905	66	90	04.98-04.02	*
1.9 D Combinato (230 A2.000)	Diesel	FWD	1929	51	69	06.95-04.02	*
1.9 TD Combinato (230 A4.000)	Diesel	FWD	1929	59	80	08.94-04.02	*
1.9 TD Panorama/Combinato (230 A3.000)	Diesel	FWD	1929	60	82	03.94-04.02	*
2.0 JTD (RHV)	Diesel	FWD	1997	62	84	10.01-04.02	*
2.0 JTD (RHV)	Diesel	FWD	1997	62	84	12.01-07.06	*
2.3 JTD (F1AE0481C)	Diesel	FWD	2286	81	110	12.01-07.06	*
2.5 TD	Diesel	FWD	2499	80	109	06.94-08.98	*
2.5 TD 4x4 (8140.47)	Diesel	4WD	2499	80	109	11.94-04.98	*
2.5 TD 4x4 (8140.47)	Diesel	4WD	2499	85	116	06.94-09.01	*
2.5 TDI Panorama/Combinato (8140.47)	Diesel	FWD	2499	85	116	03.94-04.02	*
2.5 D Combinato (8140.67)	Diesel	FWD	2500	62	84	08.94-04.02	*
2.5 TDI Panorama/Combinato (8140.47R)	Diesel	FWD	2500	80	109	07.94-04.02	*
2.5 TDI 4x4 (8140.47)	Diesel	4WD	2500	85	116	04.97-04.02	*
2.8 JTD (8140.43S)	Diesel	FWD	2798	94	128	11.00-04.02	*
2.8 JTD (8140.43S)	Diesel	FWD	2798	94	128	12.01-	*
2.8 JTD 4x4 (8140.43S)	Diesel	4WD	2798	94	128	11.00-04.02	*
2.8 JTD 4x4 (8140.43S)	Diesel	4WD	2798	94	128	12.01-07.06	*
2.8 TD (8140.43)	Diesel	FWD	2799	90	122	11.03-07.06	*
2.8 TD 4x4 (8140.43)	Diesel	4WD	2799	90	122	11.03-07.06	*
2.8 D (8140.63)	Diesel	FWD	2800	64	87	02.98-04.02	*
2.8 TDI (8140.43)	Diesel	FWD	2800	90	122	10.97-04.02	*
2.8 TDI 4x4 (8140.43)	Diesel	4WD	2800	90	122	07.99-04.02	*
2.8 JTD (8140.43N)	Diesel	FWD	2800	107	145	04.04-07.06	*
DUCATO II (230_) 03.94-04.02				Caja/Chasis (LCVs-N1 Segment)			
2.0 (RFW)	Gasolina	FWD	1998	80	109	03.94-04.02	*
1.9 D (DJY)	Diesel	FWD	1905	50	68	04.98-04.02	*
1.9 TD (DHX)	Diesel	FWD	1905	59	80	05.98-11.01	*
1.9 TD (DHX)	Diesel	FWD	1905	66	90	04.98-04.02	*
1.9 TD (DHX (XUD9TF/L))	Diesel	FWD	1905	66	90	04.98-04.02	*
1.9 D (230 A2.000)	Diesel	FWD	1929	51	69	03.94-04.02	*
1.9 TD CAT (230 A4.000)	Diesel	FWD	1929	59	80	08.94-04.02	*
1.9 TD (230 A3.000)	Diesel	FWD	1929	60	82	03.94-04.02	*
2.0 JTD (RHV)	Diesel	FWD	1997	62	84	12.01-07.06	*
2.3 JTD (F1AE0481C)	Diesel	FWD	2286	81	110	12.01-07.06	*
2.5 TD (8140.47)	Diesel	FWD	2499	80	109	06.94-08.98	*
2.5 TD 4x4 (8140.47)	Diesel	4WD	2499	80	109	11.94-04.98	*
2.5 TD (8140.47)	Diesel	FWD	2499	85	116	06.94-04.98	*
2.5 TD 4x4 (8140.47)	Diesel	4WD	2499	85	116	11.94-04.98	*

LISTA DE APLICACIONES - BUYERS GUIDE

2.5 D (8140.67)		Diesel	FWD	2500	62	84	03.94-04.02	*
2.5 D 4x4 (8140.67)		Diesel	4WD	2500	62	84	03.94-04.02	*
2.5 TDI (8140.47R)		Diesel	FWD	2500	80	109	03.94-04.02	*
2.5 TDI		Diesel	FWD	2500	85	116	03.94-04.02	*
2.5 TDI 4x4 (8140.47)		Diesel	4WD	2500	85	116	06.98-04.02	*
2.8 JTD (8140.43S)		Diesel	FWD	2798	94	128	11.00-04.02	*
2.8 JTD		Diesel	FWD	2798	94	128	03.01-04.02	*
2.8 JTD (8140.43S)		Diesel	FWD	2798	94	128	12.01-07.06	*
2.8 JTD 4x4 (8140.43S)		Diesel	4WD	2798	94	128	12.01-07.06	*
2.8 TD 4x4 (8140.63)		Diesel	4WD	2799	64	87	05.98-11.01	*
2.8 iDTD 4x4 (8140.43)		Diesel	4WD	2799	90	122	05.98-09.01	*
2.8 JTD (8140.43)		Diesel	FWD	2799	90	122	11.03-07.06	*
2.8 JTD 4x4		Diesel	4WD	2799	90	122	11.03-07.06	*
2.8 D (8140.63)		Diesel	FWD	2800	64	87	02.98-04.02	*
2.8 TDI (8140.43)		Diesel	FWD	2800	90	122	12.98-04.02	*
2.8 JTD Power (8140.43N)		Diesel	FWD	2800	107	146	04.04-07.06	*
DUCATO III (250_) 07.06-							[CAMBIADO]:Furgón (LCVs-N1 Segment)	
100 Multijet 2,2 D (4HV)		Diesel	FWD	2198	74	101	07.06-05.11	*
110 Multijet 2,3 D (F1AE3481G)		Diesel	FWD	2287	83	113	10.11-07.14	*
120 Multijet 2,3 D (F1AE0481D)		Diesel	FWD	2287	88	120	07.06-	*
120 Multijet 2,3 D (F1AGL4114)		Diesel	FWD	2287	88	120	07.06-	*
120 Multijet 2,3 D 4x4 (F1AE0481D)		Diesel	4WD	2287	88	120	03.10-	*
130 Multijet 2,3 D		Diesel	FWD	2287	93	126	08.06-12.18	*
150 Multijet 2,3 D (F1AGL411A)		Diesel	FWD	2287	110	150	12.15-	*
150 Multijet 2,3 D (F1AGL411C)		Diesel	FWD	2287	110	150	12.15-	*
180 Multijet 2,3 D (F1AGL4111)		Diesel	FWD	2287	130	177	12.15-	*
180 Multijet 2,3 D (F1AGL411B)		Diesel	FWD	2287	130	177	12.15-	*
160 Multijet 3,0 D (F1CE0481D)		Diesel	FWD	2999	116	158	07.06-05.11	*
DUCATO III (250_) 07.06-							Bus (Minibus-M2-Segment)	
100 Multijet 2,2 D (4HV)		Diesel	FWD	2198	74	101	07.06-05.11	*
110 Multijet 2,3 D (F1AE3481G)		Diesel	FWD	2287	83	113	10.11-07.14	*
120 Multijet 2,3 D (F1AE0481D)		Diesel	FWD	2287	88	120	07.06-10.13	*
130 Multijet 2,3 D		Diesel	FWD	2287	93	126	01.10-	*
130 Multijet 2,3 D (F1AE0481N)		Diesel	FWD	2287	96	131	01.07-	*
130 Multijet 2,3 D (F1AE3481D)		Diesel	FWD	2287	96	131	01.07-	*
130 Multijet 2,3 D (F1AGL411D)		Diesel	FWD	2287	96	131	01.07-	*
150 Multijet 2,3 D (F1AGL411A)		Diesel	FWD	2287	110	150	04.15-	*
150 Multijet 2,3 D (F1AGL411C)		Diesel	FWD	2287	110	150	04.15-	*
180 Multijet 2,3 D		Diesel	FWD	2287	130	177	12.15-	*
150 Multijet 3,0 D (F1CE3481N)		Diesel	FWD	2999	107	146	04.10-07.14	*
160 Multijet 3,0 D (F1CE0481D)		Diesel	FWD	2999	115	156	10.06-05.11	*
160 Multijet 3,0 D (F1CE0481D)		Diesel	FWD	2999	116	158	07.06-05.11	*
160 Multijet 3,0 D (F1CE3481M)		Diesel	FWD	2999	116	158	07.06-05.11	*
DUCATO III (250_) 07.06-							Caja/Chasis (LCVs-N1 Segment)	
100 Multijet 2,2 D (4HV)		Diesel	FWD	2198	74	101	07.06-05.11	*
110 Multijet 2,3 D (F1AE3481G)		Diesel	FWD	2287	83	113	10.11-07.14	*
120 Multijet 2,3 D (F1AE0481D)		Diesel	FWD	2287	88	120	07.06-	*
120 Multijet 2,3 D (F1AGL4114)		Diesel	FWD	2287	88	120	07.06-	*
120 Multijet 2,3 D 4x4 (F1AE0481D)		Diesel	4WD	2287	88	120	03.10-	*
130 Multijet 2,3 D		Diesel	FWD	2287	93	126	08.06-	*

LISTA DE APLICACIONES - BUYERS GUIDE

150 Multijet 2,3 D (F1AGL411C)		Diesel	FWD	2287	110	150	12.15-	*
180 Multijet 2,3 D (F1AGL4111)		Diesel	FWD	2287	130	177	12.15-	*
180 Multijet 2,3 D (F1AGL411B)		Diesel	FWD	2287	130	177	12.15-	*
150 Multijet 3,0 D (F1CE3481N)		Diesel	FWD	2999	107	146	04.10-07.14	*
160 Multijet 3,0 D (F1CE0481D)		Diesel	FWD	2999	116	158	07.06-05.14	*
140 Natural Power (F1CE0441A)		CNG	FWD	2999	100	136	04.09-	*
140 Natural Power (F1CFA401A)		CNG	FWD	2999	100	136	04.09-	*
OPEL								
MOVANO C (U9, X250) 12.21-					[CAMBIADO]:Furgón (LCVs-N1 Segment)			
2.2 D		Diesel	FWD	2179	88	120	12.21-10.23	*
2.2 D		Diesel	FWD	2179	103	140	12.21-10.23	*
2.2 D		Diesel	FWD	2179	121	165	12.21-10.23	*
MOVANO C (U9, X250) 12.21-					Caja/Chasis (LCVs-N1 Segment)			
2.2 D		Diesel	FWD	2179	88	120	12.21-10.23	*
2.2 D		Diesel	FWD	2179	103	140	12.21-10.23	*
2.2 D		Diesel	FWD	2179	121	165	12.21-10.23	*
PEUGEOT								
BOXER II (230L) 03.94-08.06					[CAMBIADO]:Furgón (LCVs-N1 Segment)			
2.0 4x4 (RFW (XU10J2))		Gasolina	4WD	1998	80	109	03.96-09.98	*
2.0 i (RFW (XU10J2))		Gasolina	FWD	1998	80	109	06.94-04.02	*
1.9 D (DJY (XUD9A))		Diesel	FWD	1905	50	68	07.99-04.02	*
1.9 D (D9B (XUD9AU))		Diesel	FWD	1905	51	69	03.94-04.02	*
1.9 DT 4x4 (XUD9TE)		Diesel	4WD	1905	66	90	03.96-09.98	*
1.9 TD (XUD9TE)		Diesel	FWD	1905	66	90	07.99-04.02	*
1.9 TD (D8C (XUD9UTF))		Diesel	FWD	1905	68	92	03.94-04.02	*
2.0 HDi (RHV (DW10UTD))		Diesel	FWD	1997	62	84	08.01-04.02	*
2.5 D (T9A (DJ5))		Diesel	FWD	2446	63	86	03.94-04.02	*
2.5 D 4x4 (T9A (DJ5))		Diesel	4WD	2446	63	86	07.99-04.02	*
2.5 TD (T8A (DJ5T))		Diesel	FWD	2446	76	103	03.94-03.02	*
2.5 TDI (THX (DJ5TED))		Diesel	FWD	2446	79	107	01.97-04.02	*
2.5 TDI 4x4 (THX (DJ5TED))		Diesel	4WD	2446	79	107	07.99-04.02	*
2.5 DT		Diesel	FWD	2499	62	84	10.97-11.01	*
2.8 DTiC		Diesel	FWD	2798	90	122	10.97-08.05	*
2.8 HDI (8140.43S (F28DTCR))		Diesel	FWD	2798	93	126	10.00-11.01	*
2.8 HDi 4x4 (8140.43S (F28DTCR))		Diesel	4WD	2798	93	126	10.00-11.01	*
2.8 HDI (8140.43S (F28DTCR))		Diesel	FWD	2798	94	128	11.00-04.02	*
BOXER II (230P) 03.94-12.09					Bus (Minibus-M2-Segment)			
2.0 i (RFW (XU10J2))		Gasolina	FWD	1998	80	109	03.94-04.02	*
2.0 i 4x4 (RFW (XU10J2))		Gasolina	4WD	1998	80	109	08.96-04.02	*
1.9 D (D9B (XUD9AU))		Diesel	FWD	1905	51	69	03.94-04.02	*
1.9 TD (DHY (XUD9TE))		Diesel	FWD	1905	66	90	08.94-04.02	*
1.9 TD (D8C (XUD9UTF))		Diesel	FWD	1905	68	92	03.94-04.02	*
1.9 TD 4x4 (D8C (XUD9UTF))		Diesel	4WD	1905	68	92	07.96-04.02	*
2.5 D (T9A (DJ5))		Diesel	FWD	2446	63	86	08.94-04.02	*
2.5 D 4x4 (T9A (DJ5))		Diesel	4WD	2446	63	86	07.96-04.02	*
2.5 TD (T8A (DJ5T))		Diesel	FWD	2446	76	103	07.94-12.97	*
2.5 TD 4x4 (T8A (DJ5T))		Diesel	4WD	2446	76	103	07.96-04.02	*
2.5 TDI (THX (DJ5TED))		Diesel	FWD	2446	79	107	01.97-04.02	*
2.5 TDI 4x4 (THX (DJ5TED))		Diesel	4WD	2446	79	107	01.97-04.02	*

LISTA DE APLICACIONES - BUYERS GUIDE

2.5 DT		Diesel	FWD	2499	62	84	10.97-11.01	*
2.8 DTiC		Diesel	FWD	2798	90	122	10.97-09.00	*
2.8 HDi (8140.43S (F28DTCR))		Diesel	FWD	2798	93	126	10.00-11.01	*
2.8 HDi A las 4 ruedas (8140.43S (F28DTCR))		Diesel	4WD	2798	93	126	10.00-11.01	*
2.8 HDi (8140.43S (F28DTCR))		Diesel	FWD	2798	94	128	11.00-04.02	*
BOXER II (ZCT_) 03.94-04.02				Caja/Chasis (LCVs-N1 Segment)				
2.0 i (RFW (XU10J2))		Gasolina	FWD	1998	80	109	06.94-04.02	*
2.0 (RFL (XU10J2U))		Gasolina	FWD	1998	81	110	12.01-04.02	*
1.9 D (DJY (XUD9A))		Diesel	FWD	1905	51	69	03.94-04.02	*
1.9 TD (DHY (XUD9TE))		Diesel	FWD	1905	66	90	06.94-04.02	*
1.9 TD (XUD9TE)		Diesel	FWD	1905	66	90	06.94-04.02	*
1.9 TD (D8C (XUD9UTF))		Diesel	FWD	1905	68	92	07.94-04.02	*
1.9 TD (XUD9TE)		Diesel	FWD	1905	68	92	07.94-04.02	*
2.5 D (T9A (DJ5))		Diesel	FWD	2446	63	86	03.94-04.02	*
2.5 D 4x4 (T9A (DJ5))		Diesel	4WD	2446	63	86	07.99-04.02	*
2.5 TD (T8A (DJ5T))		Diesel	FWD	2446	76	103	03.94-12.97	*
2.5 TDI (THX (DJ5TED))		Diesel	FWD	2446	79	107	01.97-04.02	*
2.5 TDI 4x4 (THX (DJ5TED))		Diesel	4WD	2446	79	107	07.99-04.02	*
2.8 HDi (8140.43S (F28DTCR))		Diesel	FWD	2798	93	126	10.00-11.01	*
2.8 HDi A las 4 ruedas (8140.43S (F28DTCR))		Diesel	4WD	2798	93	126	10.00-11.01	*
2.8 HDi (8140.43S (F28DTCR))		Diesel	FWD	2798	94	128	11.00-04.02	*
BOXER III / MANAGER 04.06-				[CAMBIADO]:Furgón (LCVs-N1 Segment)				
2.0 BlueHDi 110 (AHM (DW10FUE))		Diesel	FWD	1997	81	110	03.16-09.19	*
2.0 BlueHDi 130 (AHN (DW10FUD))		Diesel	FWD	1997	96	130	03.16-09.19	*
2.0 BlueHDi 160 (AHP (DW10FUC))		Diesel	FWD	1997	120	163	03.16-12.23	*
2.2 HDi 100 (4HV (P22DTE))		Diesel	FWD	2198	74	101	04.06-	*
2.2 HDi 120 (4HU (P22DTE))		Diesel	FWD	2198	88	120	04.06-12.16	*
3.0 HDi 155 (F1CE0481D (F30DT))		Diesel	FWD	2999	115	156	07.06-12.15	*
3.0 HDi 160 (F1CE0481D (F30DT))		Diesel	FWD	2999	116	156	04.06-12.15	*
BOXER III / MANAGER 09.05-				Bus (Minibus-M2-Segment)				
2.0 BlueHDi 110 (AHM (DW10FUE))		Diesel	FWD	1997	81	110	07.15-09.19	*
2.0 BlueHDi 130 (AHN (DW10FUD))		Diesel	FWD	1997	96	130	07.15-09.19	*
2.0 BlueHDi 160 (AHP (DW10FUC))		Diesel	FWD	1997	120	163	07.15-09.19	*
2.2 HDi 100 (4HV (P22DTE))		Diesel	FWD	2198	74	101	04.06-	*
2.2 HDi 120 (4HU (P22DTE))		Diesel	FWD	2198	88	120	04.06-12.16	*
2.8 HDi		Diesel	FWD	2798	93	127	09.05-09.09	*
3.0 HDi 160 (F1CE0481D (F30DT))		Diesel	FWD	2999	115	156	04.06-12.15	*
BOXER III / MANAGER 04.06-				Caja/Chasis (LCVs-N1 Segment)				
2.0 BlueHDi 110 (AHM (DW10FUE))		Diesel	FWD	1997	81	110	03.16-09.19	*
2.0 BlueHDi 130 (AHN (DW10FUD))		Diesel	FWD	1997	96	130	03.16-09.19	*
2.0 BlueHDi 160 (AHP (DW10FUC))		Diesel	FWD	1997	120	163	03.16-12.23	*
2.2 HDi 100 (4HV (P22DTE))		Diesel	FWD	2198	74	101	04.06-	*
2.2 HDi 120 (4HU (P22DTE))		Diesel	FWD	2198	88	120	04.06-12.16	*
2.2 HDi 130		Diesel	4WD	2198	96	130	03.11-	*
2.2 HDi 150		Diesel	4WD	2198	110	150	03.11-	*
3.0 HDi 155 (F1CE0481D (F30DT))		Diesel	FWD	2999	115	156	04.06-12.15	*
3.0 HDi 160 (F1CE0481D (F30DT))		Diesel	FWD	2999	116	156	04.06-12.15	*

VAUXHALL

LISTA DE APLICACIONES - BUYERS GUIDE

MOVANO Mk III © (U9, X250) 12.21-					[CAMBIADO]:Furgón (LCVs-N1 Segment)			
2.2 D		Diesel	FWD	2179	88	120	12.22-10.23	*
2.2 D		Diesel	FWD	2179	103	140	12.21-10.23	*
2.2 D		Diesel	FWD	2179	121	165	12.21-10.23	*
MOVANO Mk III © (U9, X250) 12.21-					Caja/Chasis (LCVs-N1 Segment)			
2.2 D		Diesel	FWD	2179	103	140	12.21-04.25	*
2.2 D		Diesel	FWD	2179	121	165	12.22-10.23	*