

# LISTA DE APLICACIONES - BUYERS GUIDE

## 78RBD24620



Weight: 14.044

O.E.M.	MAKE
1 309 392 080	LANCIA
1 317 651 080	LANCIA
4246.J2	PEUGEOT
4246.J3	PEUGEOT
7 173 890 8	FIAT

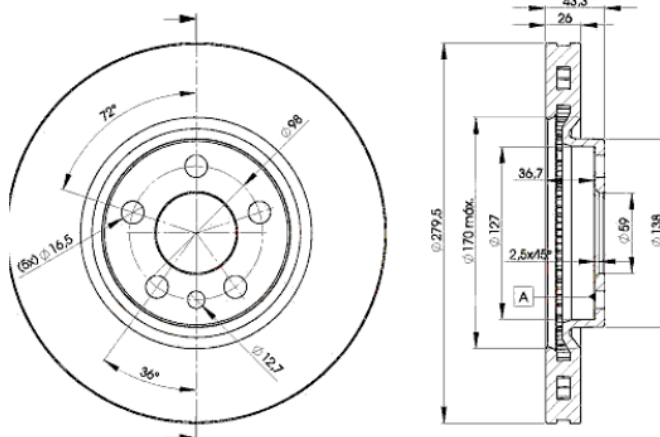

## 78RBD24620

E1 90R-02C0538/0103



Ø281x26x43.5

Sin Filas



Trac.	CC	Kw	CV	
				Front / Rear

### CITROËN

#### EVASION / SYNERGIE (U6\_, AF\_) 03.94-10.02

#### Furgoneta/MPV (Large MPV-M1 Segment)

2.0 (AFRFVB)	Gasolina	FWD	1998	97	132	05.98-04.00	*
TD (U6UJ)	Diesel	FWD	1905	66	90	11.94-07.02	*
DT (U6UC)	Diesel	FWD	1905	68	92	10.95-12.98	*
HDi (AFRHWB)	Diesel	FWD	1997	80	109	09.99-10.02	*
HDi (AFRHZA)	Diesel	FWD	1997	80	109	09.99-10.02	*
DT (U6UW)	Diesel	FWD	2088	80	109	11.96-08.00	*

#### EVASION / SYNERGIE (22, U6) 03.94-07.02

#### MPV (Large MPV-M1 Segment)

1.8 (LFZ (XU7JP))	Gasolina	FWD	1761	73	99	05.97-07.02	*
1.8	Gasolina	FWD	1761	76	103	02.96-12.96	*
2.0 16V (RFN (EW10J4))	Gasolina	FWD	1997	100	136	05.00-07.02	*
2.0 (RFU (XU10J2/C))	Gasolina	FWD	1998	89	121	06.94-07.02	*
2.0 16V (RFV (XU10J4R))	Gasolina	FWD	1998	97	132	05.98-04.00	*
2.0 Turbo C.T. (RGX (XU10J2TE))	Gasolina	FWD	1998	108	147	06.94-07.02	*
1.9 TD (D8B (XUD9TF))	Diesel	FWD	1905	66	90	11.94-07.02	*
1.9 TD (DHX (XUD9TF/BTF))	Diesel	FWD	1905	66	90	11.94-07.02	*
1.9 TD (D8B (XUD9TF))	Diesel	FWD	1905	68	92	10.95-12.98	*
2.0 HDi (RHZ (DW10ATED))	Diesel	FWD	1997	80	109	08.99-07.02	*
2.0 HDi 16V (RHW (DW10ATED4))	Diesel	FWD	1997	80	109	09.99-07.02	*
2.0 HDi	Diesel	FWD	1997	81	110	08.99-07.02	*
2.1 TD (P8C (XUD11BTE))	Diesel	FWD	2088	80	109	05.96-07.02	*

#### JUMPER II / RELAY (230L) 02.94-08.02

#### [CAMBIADO]:Furgón (LCVs-M1 Segment)

1.9 TD (D8C (XUD9UTF))	Diesel	FWD	1905	68	92	03.94-04.02	*
------------------------	--------	-----	------	----	----	-------------	---

# LISTA DE APLICACIONES - BUYERS GUIDE

JUMPER II / RELAY (230P) 02.94-04.02					Bus (Minibus-M2-Segment)			
1.9 TD (D8C (XUD9UTF))		Diesel	FWD	1905	66	90	08.94-04.02	*
1.9 TD (D8C (XUD9UTF))		Diesel	FWD	1905	68	92	02.94-04.02	*
JUMPY / DISPATCH (BS_, BT_, BY_, BZ_) 06.94-10.06					[CAMBIADO]:Furgón (LCVs-N1 Segment)			
2.0 (RFN (EW10J4))		Gasolina	FWD	1997	100	136	04.00-10.06	*
1.9 TD (D8B (XUD9TE))		Diesel	FWD	1905	68	92	10.95-08.00	*
2.0 HDI 110 (RHW (DW10ATED4))		Diesel	FWD	1997	80	109	01.02-10.06	*
JUMPY / DISPATCH (U6U_) 06.94-12.06					Bus (Minibus-M2-Segment)			
2.0 (RFN (EW10J4))		Gasolina	FWD	1997	100	136	04.00-12.06	*
2.0 i 16V (RFN (EW10J4))		Gasolina	FWD	1997	102	138	03.00-10.06	*
2.0 HDi 95 (RHX (DW10BTED))		Diesel	FWD	1997	69	94	10.99-10.06	*
2.0 HDI 110 (RHW (DW10ATED4))		Diesel	FWD	1997	80	109	03.00-10.06	*
2.0 HDI 110 (RHZ (DW10ATED))		Diesel	FWD	1997	80	109	03.00-10.06	*
FIAT								
SCUDO (220_) 02.96-12.06					Bus (Minibus-M2-Segment)			
2.0 JTD 16V (RHW (DW10ATED4))		Diesel	FWD	1997	80	109	05.99-12.06	*
SCUDO (220_) 09.96-12.06					Caja/Chasis (LCVs-N1 Segment)			
2.0 JTD (RHX)		Diesel	FWD	1997	69	94	10.99-12.06	*
ULYSSE (220_) 06.94-08.02					MPV (Large MPV-M1 Segment)			
2.0 16V (220AQ5) (RFN (EW10J4))		Gasolina	FWD	1997	100	136	09.00-08.02	*
2.0 (220.AC5) (RFU (XU10J2C))		Gasolina	FWD	1998	89	121	06.94-08.02	*
2.0 16V (RFV)		Gasolina	FWD	1998	97	132	05.98-09.00	*
2.0 Turbo (220.AD5) (RGX (XU10J2CTE))		Gasolina	FWD	1998	108	147	06.94-08.02	*
1.9 TD (220AH5) (DHX (XUD9TF/L))		Diesel	FWD	1905	66	90	02.95-08.02	*
1.9 TD (DHX (XUD9TF/L))		Diesel	FWD	1905	68	92	05.97-12.99	*
2.0 JTD (RHZ)		Diesel	FWD	1997	80	109	10.99-08.02	*
2.0 JTD 16V (RHW (DW10ATED4))		Diesel	FWD	1997	80	109	05.99-08.02	*
2.1 TD (P8C)		Diesel	FWD	2088	80	109	03.96-10.99	*
LANCIA								
ZETA (22_) 05.95-10.03					MPV (Large MPV-M1 Segment)			
2.0 16V (220AQ5, 220AQ4) (RFN)		Gasolina	FWD	1997	100	136	07.00-09.02	*
2.0 16V (220AL5) (RFV (XU10J4R))		Gasolina	FWD	1998	97	132	05.98-07.00	*
2.0 Turbo (220AD5, 220CD5) (RGX (XU10J2TE))		Gasolina	FWD	1998	108	147	05.95-09.02	*
2.0 JTD (220.AR5, 220.AN5) (RHZ (DW10ATED))		Diesel	FWD	1997	80	109	09.99-09.02	*
2.0 JTD 16V (220AN5)		Diesel	FWD	1997	80	109	09.99-09.02	*
2.0 JTD 16V (220.AR5OOL) (RHW (DW10ATED4))		Diesel	FWD	1997	81	110	04.01-10.03	*
2.1 TD (220AJ5) (P 8 C)		Diesel	FWD	2088	80	109	05.96-09.99	*
PEUGEOT								
806 (AF_) 06.94-02.03					Furgoneta/MPV (Large MPV-M1 Segment)			
2.0 (AFRGXC)		Gasolina	FWD	1998	108	147	02.97-05.00	*
TD (AFDHXC)		Diesel	FWD	1905	66	90	07.95-08.02	*
HDi (AFRHZC)		Diesel	FWD	1997	80	109	06.99-02.03	*
DT (AFP8CB)		Diesel	FWD	2088	80	109	02.97-05.00	*
806 (221) 06.94-08.02					MPV (Large MPV-M1 Segment)			
2.0 (RFU (XU10J2))		Gasolina	FWD	1998	89	121	06.94-08.02	*
2.0 Turbo (RGX (XU10J2TE))		Gasolina	FWD	1998	108	147	06.94-08.02	*
1.9 TD (DHX (XUD9TE))		Diesel	FWD	1905	66	90	07.95-08.02	*

# LISTA DE APLICACIONES - BUYERS GUIDE

1.9 TD (D8B (XUD9TE))		Diesel	FWD	1905	68	92	05.97-08.02	*
2.0 HDi (RHZ (DW10ATED))		Diesel	FWD	1997	80	109	08.99-08.02	*
2.0 HDi 16V (RHW (DW10ATED4))		Diesel	FWD	1997	80	109	08.99-08.02	*
2.1 TD 12V (P8C (XUD11BTE))		Diesel	FWD	2088	80	109	06.96-08.99	*
<b>EXPERT (222) 07.95-03.08</b>					<b>[CAMBIADO]:Furgón (LCVs-N1 Segment)</b>			
1.6 (222A2 (1580 SPI))		Gasolina	FWD	1581	58	79	02.96-09.00	*
1.8 (LFZ (XU7JP))		Gasolina	FWD	1761	74	101	10.96-09.00	*
2.0 (RFN (EW10J4))		Gasolina	FWD	1997	100	136	09.02-12.06	*
1.9 D 70 (WJY (DW8B))		Diesel	FWD	1868	51	69	12.98-12.06	*
1.9 D 70 (WJZ (DW8))		Diesel	FWD	1868	51	69	12.98-12.06	*
1.9 D (D9B (XUD9AU))		Diesel	FWD	1905	51	70	02.96-12.98	*
1.9 TD (DHX (XUD9TE))		Diesel	FWD	1905	66	90	02.96-09.00	*
1.9 TD (D8B (XUD9TE))		Diesel	FWD	1905	68	92	02.96-05.98	*
2.0 HDi (RHX (DW10BTED))		Diesel	FWD	1997	69	94	07.00-12.06	*
2.0 HDi (RHZ (DW10ATED))		Diesel	FWD	1997	80	109	07.00-12.06	*
2.0 HDi (RHZ (DW10BTED))		Diesel	FWD	1997	80	109	07.00-12.06	*
2.0 HDi (RHZ (DW10BTED+))		Diesel	FWD	1997	80	109	07.00-12.06	*
2.0 HDi (RHZ (DW10CTED))		Diesel	FWD	1997	80	109	07.00-12.06	*
2.0 HDi (RHW (DW10ATED4))		Diesel	FWD	1997	80	109	07.00-12.06	*
<b>EXPERT (224_) 10.95-12.06</b>					<b>Bus (Minibus-M2-Segment)</b>			
1.6 (222A2 (1580 SPI))		Gasolina	FWD	1581	58	79	02.96-09.00	*
1.8 (LFZ (XU7JP))		Gasolina	FWD	1761	74	101	10.96-09.00	*
2.0 (RFN (EW10J4))		Gasolina	FWD	1997	100	136	07.00-12.06	*
1.9 D (WJY (DW8B))		Diesel	FWD	1868	51	69	12.03-12.06	*
1.9 D (WJZ (DW8))		Diesel	FWD	1868	51	69	12.03-12.06	*
1.9 D (D9B (XUD9AU))		Diesel	FWD	1905	51	70	02.96-12.98	*
1.9 TD (DHX (XUD9TE))		Diesel	FWD	1905	66	90	02.96-09.00	*
1.9 TD (D8B (XUD9TE))		Diesel	FWD	1905	68	92	02.96-05.98	*
1.9 D		Diesel	RWD	1905	69	94	10.95-05.98	*
2.0 HDi (RHX (DW10BTED))		Diesel	FWD	1997	69	94	10.00-10.06	*
2.0 HDi (RHZ (DW10ATED))		Diesel	FWD	1997	80	109	07.00-12.06	*
2.0 HDi (RHZ (DW10BTED))		Diesel	FWD	1997	80	109	07.00-12.06	*
2.0 HDi (RHZ (DW10BTED+))		Diesel	FWD	1997	80	109	07.00-12.06	*
2.0 HDi (RHZ (DW10CTED))		Diesel	FWD	1997	80	109	07.00-12.06	*
2.0 HDi 16V (RHW (DW10ATED4))		Diesel	FWD	1997	80	109	07.00-12.06	*
<b>EXPERT (223) 12.95-12.06</b>					<b>Caja/Chasis (LCVs-N1 Segment)</b>			
1.6 (222A2 (1580 SPI))		Gasolina	FWD	1581	58	79	02.96-09.00	*
1.9 D (WJY (DW8B))		Diesel	FWD	1868	51	69	06.98-09.01	*
1.9 D (WJZ (DW8))		Diesel	FWD	1868	51	69	06.98-09.01	*
1.9 D (D9B (XUD9AU))		Diesel	FWD	1905	51	70	02.96-12.98	*
1.9 TD (DHX (XUD9TE))		Diesel	FWD	1905	66	90	02.96-09.00	*
1.9 TD (D8B (XUD9TE))		Diesel	FWD	1905	68	92	02.96-05.98	*
2.0 HDi (RHX (DW10BTED))		Diesel	FWD	1997	69	94	10.00-10.06	*
2.0 HDi (RHW (DW10ATED4))		Diesel	FWD	1997	80	109	10.00-10.06	*
2.0 HDi		Diesel	FWD	1997	80	109	10.00-10.06	*