

LISTA DE APLICACIONES - BUYERS GUIDE

78RBD24116



8 424073 153968

Weight: 17.460

| O.E.M. | MAKE |
|------------|-----------|
| 13 501 307 | OPEL |
| 13 502 213 | VAUXHALL |
| 13 579 147 | OPEL |
| 1350 1307 | CHEVROLET |
| 5 69 063 | OPEL |
| 5 69 078 | OPEL |
| 5 69 421 | OPEL |

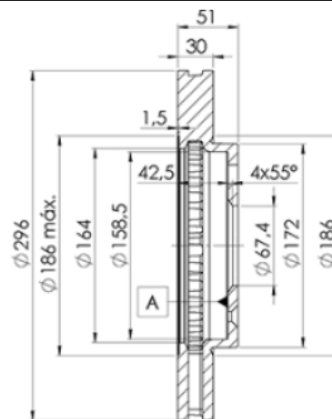
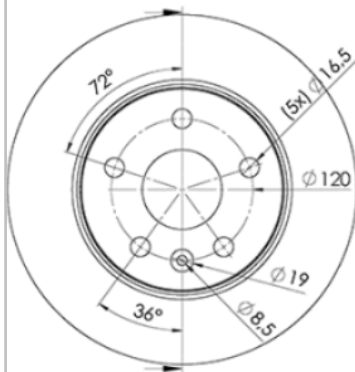

78RBD24116

E1 90R-02C0452/0114



Ø296x30x51

Sin Filas



| Trac. | CC | Kw | CV |
|-------|----|----|----|
|-------|----|----|----|



Front / Rear

BUICK

LA CROSSE II 06.09-

Sedán (Executive car-E Segment)

| | | | | | | | |
|----------------------|---------------|-----|------|-----|-----|-------------|---|
| 2.4 (LE5) | Gasolina | FWD | 2384 | 125 | 170 | 09.09- | * |
| 2.4 (LAF) | Gasolina | FWD | 2384 | 136 | 185 | 09.09- | * |
| 2.4 | Gasolina | FWD | 2384 | 136 | 185 | 09.10-12.11 | * |
| 3.0 | Gasolina | FWD | 2980 | 131 | 178 | 09.09- | * |
| 3.0 (LF1) | Gasolina | FWD | 2997 | 190 | 258 | 09.09- | * |
| 3.0 AWD (LF1) | Gasolina | 4WD | 2997 | 190 | 258 | 09.09- | * |
| 3.6 VVTi (LLT) | Gasolina | FWD | 3564 | 209 | 284 | 01.10-12.11 | * |
| 3.6 VVTi | Gasolina | FWD | 3564 | 209 | 284 | 09.10-12.11 | * |
| 3.6 | Gasolina | FWD | 3564 | 226 | 307 | 07.15- | * |
| 3.6 (LGX) | Gasolina | FWD | 3640 | 227 | 309 | 02.16-09.17 | * |
| 3.6 (LGX) | Gasolina | FWD | 3640 | 231 | 314 | 09.17- | * |
| 3.6 AWD (LGX) | Gasolina | 4WD | 3640 | 231 | 314 | 09.17- | * |
| 3.6 FLEX (LFX) | Gasol./Etanol | FWD | 3564 | 227 | 309 | 09.11- | * |
| 3.6 FLEX AWD (LFX) | Gasol./Etanol | 4WD | 3564 | 227 | 309 | 09.11- | * |
| 2.4 Hybrid (LUK) | Gasol./eléc. | FWD | 2384 | 136 | 185 | 09.12- | * |
| 2.4 Hybrid AWD (LUK) | Gasol./eléc. | 4WD | 2384 | 136 | 185 | 09.11- | * |
| 2.4 Hybrid (LUK) | Gasol./eléc. | FWD | 2384 | 147 | 200 | 09.11-12.16 | * |
| 2.4 Hybrid AWD (LUK) | Gasol./eléc. | 4WD | 2384 | 147 | 200 | 09.11-12.16 | * |

REGAL V (U.S.A.) 09.10-

Sedán (Large family car-D Segment)

| | | | | | | | |
|-----|----------|-----|--|-----|-----|--------|---|
| 2.4 | Gasolina | FWD | | 136 | 185 | 09.10- | * |
|-----|----------|-----|--|-----|-----|--------|---|

LISTA DE APLICACIONES - BUYERS GUIDE

| | | | | | | | |
|---|---------------|-----|------|--|-----|-------------|---|
| 2.4 FLEX | Gasolina | FWD | | 136 | 185 | 09.11- | * |
| 2.4 AWD (LAF) | Gasolina | 4WD | 2384 | 136 | 185 | 09.10- | * |
| 2.4 Hybrid (LUK) | Gasol./el éc. | FWD | 2384 | 147 | 200 | 09.11- | * |
| 2.4 Hybrid AWD (LUK) | Gasol./el éc. | 4WD | 2384 | 147 | 200 | 07.13- | * |
| BUICK (SGM) | | | | | | | |
| REGAL II (EG1) 12.08- | | | | Sedán (Large family car-D Segment) | | | |
| 2.0 | Gasolina | FWD | 1998 | 108 | 147 | 12.08- | * |
| 2.0 (LTD) | Gasolina | FWD | 1998 | 113 | 154 | 09.13-12.17 | * |
| 2.4 | Gasolina | FWD | 2384 | 127 | 173 | 12.08- | * |
| 2.4 | Gasolina | FWD | 2384 | 137 | 186 | 01.11- | * |
| CHEVROLET | | | | | | | |
| AVEO / KALOS (T250, T255) 03.05- | | | | Sedán (Supermini car-B Segment) | | | |
| 1.6 Aveo (LXV) | Gasolina | FWD | 1598 | 79 | 106 | 09.08-12.09 | * |
| MALIBU VII 01.08- | | | | Sedán (Executive car-E Segment) | | | |
| 2.0 | Gasolina | FWD | 1998 | 193 | 262 | 09.12- | * |
| MALIBU VIII (V300) 01.12- | | | | Sedán (Executive car-E Segment) | | | |
| 2.0 LPG | Gasolina | FWD | 1998 | 101 | 137 | 02.12- | * |
| 2.0 | Gasolina | FWD | 1998 | 104 | 141 | 02.12- | * |
| 2.0 (LTG) | Gasolina | FWD | 1998 | 193 | 262 | 01.12-12.15 | * |
| 2.4 (LE9(145CUL4)) | Gasolina | FWD | 2384 | 123 | 167 | 01.12- | * |
| 2.4 (LE9(145CUL4)) | Gasolina | FWD | 2384 | 125 | 170 | 01.12- | * |
| 2.5 (LCV) | Gasolina | FWD | 2457 | 142 | 193 | 09.12-12.13 | * |
| 2.5 | Gasolina | FWD | 2457 | 146 | 199 | 09.13-12.15 | * |
| 2.5 (LCV,LKW) | Gasolina | FWD | 2457 | 147 | 200 | 07.13- | * |
| 3.0 (LFW) | Gasolina | FWD | 2997 | 196 | 267 | 04.13- | * |
| 2.4 Hybrid (LUK) | Gasol./el éc. | FWD | 2384 | 136 | 185 | 01.12- | * |
| 2.0 D | Diesel | FWD | 1956 | 115 | 156 | 04.12- | * |
| 2.0 D (LBS) | Diesel | FWD | 1956 | 118 | 160 | 04.12- | * |
| CHEVROLET (SGM) | | | | | | | |
| MALIBU (EG3) 02.12- | | | | Sedán (Executive car-E Segment) | | | |
| 1.5 T (LFV) | Gasolina | FWD | 1490 | 125 | 170 | 08.16- | * |
| 2.0 | Gasolina | FWD | 1998 | 108 | 147 | 02.12- | * |
| 2.4 | Gasolina | FWD | 2384 | 137 | 186 | 02.12- | * |
| HOLDEN | | | | | | | |
| MALIBU (EM) 05.13- | | | | Sedán (Executive car-E Segment) | | | |
| 2.4 i (LE9) | Gasolina | FWD | 2384 | 123 | 167 | 05.13-12.16 | * |
| 2.0 D (A 20 DTH) | Diesel | FWD | 1956 | 117 | 159 | 05.13-12.16 | * |
| LOTUS (YOUNGMAN) | | | | | | | |
| L3 05.09- | | | | [CAMBIADO]:Fastback () | | | |
| 1.6 | Gasolina | FWD | 1597 | 82 | 112 | 05.09- | * |
| OPEL | | | | | | | |
| INSIGNIA A (G09) 07.08- | | | | [CAMBIADO]:Fastback (Executive car-E Segment) | | | |
| 1.4 (68) (A 14 NET) | Gasolina | FWD | 1364 | 103 | 140 | 04.11-03.17 | * |
| 1.4 (68) (B 14 NET) | Gasolina | FWD | 1364 | 103 | 140 | 04.11-03.17 | * |
| 1.6 (68) (A 16 XER) | Gasolina | FWD | 1598 | 85 | 116 | 07.08-03.17 | * |
| 1.6 SIDI (68) (A 16 XHT) | Gasolina | FWD | 1598 | 125 | 170 | 03.13-03.17 | * |

LISTA DE APLICACIONES - BUYERS GUIDE

| | | | | | | | | |
|--------------------------------------|--|------------------|-----|------|--|-----|-------------|---|
| 1.6 SIDI (68) (B 16 SHL) | | Gasolina | FWD | 1598 | 125 | 170 | 03.13-03.17 | * |
| 1.6 Turbo (68) (A 16 LET) | | Gasolina | FWD | 1598 | 132 | 180 | 07.08-03.17 | * |
| 1.8 (68) (A 18 XER) | | Gasolina | FWD | 1796 | 103 | 140 | 07.08-03.17 | * |
| 1.8 (68) (B 18 XER) | | Gasolina | FWD | 1796 | 103 | 140 | 07.08-03.17 | * |
| 2.0 Turbo (68) (A 20 NHT) | | Gasolina | FWD | 1998 | 162 | 220 | 07.08-03.17 | * |
| 2.0 Turbo 4x4 (68) (A 20 NHT) | | Gasolina | 4WD | 1998 | 162 | 220 | 07.08-03.17 | * |
| 2.0 Turbo (68) (A 20 NHT) | | Gasolina | FWD | 1998 | 184 | 250 | 04.14-03.17 | * |
| 2.0 Turbo (68) (B 20 NHT) | | Gasolina | FWD | 1998 | 184 | 250 | 04.14-03.17 | * |
| 2.0 Turbo 4x4 (68) (A 20 NFT) | | Gasolina | 4WD | 1998 | 184 | 250 | 07.11-03.17 | * |
| 2.0 Turbo 4x4 (68) (A 20 NHT) | | Gasolina | 4WD | 1998 | 184 | 250 | 07.11-03.17 | * |
| 2.0 Turbo 4x4 (68) (B 20 NHT) | | Gasolina | 4WD | 1998 | 184 | 250 | 07.11-03.17 | * |
| 1.4 LPG (68) (A 14 NET) | | Gasol./Gas (LPG) | FWD | 1364 | 103 | 140 | 07.12-03.17 | * |
| 1.4 LPG (68) (B 14 NET) | | Gasol./Gas (LPG) | FWD | 1364 | 103 | 140 | 07.12-03.17 | * |
| 2.0 E85 Turbo (68) (A 20 NFT) | | Gasol./Etanol | FWD | 1998 | 162 | 220 | 10.10-03.17 | * |
| 1.6 CDTi (68) (B 16 DTJ) | | Diesel | FWD | 1598 | 88 | 120 | 07.15-03.17 | * |
| 1.6 CDTi (68) (B 16 DTH) | | Diesel | FWD | 1598 | 100 | 136 | 07.15-03.17 | * |
| 2.0 CDTi (68) (A 20 DTC) | | Diesel | FWD | 1956 | 81 | 110 | 07.08-03.17 | * |
| 2.0 CDTi (68) (A 20 DTL) | | Diesel | FWD | 1956 | 81 | 110 | 07.08-03.17 | * |
| 2.0 CDTi (68) (A 20 DTE) | | Diesel | FWD | 1956 | 88 | 120 | 03.12-03.17 | * |
| 2.0 CDTi (68) (A 20 DT) | | Diesel | FWD | 1956 | 96 | 131 | 07.08-03.17 | * |
| 2.0 CDTi (68) (A 20 DTJ) | | Diesel | FWD | 1956 | 96 | 131 | 07.08-03.17 | * |
| 2.0 CDTi (68) (A 20 DTE) | | Diesel | FWD | 1956 | 103 | 140 | 06.13-03.17 | * |
| 2.0 CDTi (68) (A 20 DTH) | | Diesel | FWD | 1956 | 118 | 160 | 07.08-03.17 | * |
| 2.0 CDTi 4x4 (68) (A 20 DTH) | | Diesel | 4WD | 1956 | 118 | 160 | 06.10-03.17 | * |
| 2.0 CDTi (68) (A 20 DTH) | | Diesel | FWD | 1956 | 120 | 163 | 07.13-03.17 | * |
| 2.0 CDTi 4x4 (68) (A 20 DTH) | | Diesel | 4WD | 1956 | 120 | 163 | 07.13-03.17 | * |
| 2.0 CDTi (68) (B 20 DTH) | | Diesel | FWD | 1956 | 125 | 170 | 11.14-03.17 | * |
| 2.0 CDTi 4x4 (68) (B 20 DTH) | | Diesel | 4WD | 1956 | 125 | 170 | 11.14-03.17 | * |
| 2.0 Biturbo CDTi (68) (A 20 DTR) | | Diesel | FWD | 1956 | 140 | 190 | 07.08-12.11 | * |
| 2.0 Biturbo CDTi 4x4 (68) (A 20 DTR) | | Diesel | 4WD | 1956 | 140 | 190 | 05.09-12.11 | * |
| 2.0 Biturbo CDTi (68) (A 20 DTR) | | Diesel | FWD | 1956 | 143 | 195 | 01.12-03.17 | * |
| 2.0 Biturbo CDTi 4x4 (68) (A 20 DTR) | | Diesel | 4WD | 1956 | 143 | 195 | 01.12-03.17 | * |
| INSIGNIA A (G09) 07.08- | | | | | Sedán (Executive car-E Segment) | | | |
| 1.4 (69) (A 14 NET) | | Gasolina | FWD | 1364 | 103 | 140 | 04.11-03.17 | * |
| 1.4 (69) (B 14 NET) | | Gasolina | FWD | 1364 | 103 | 140 | 04.11-03.17 | * |
| 1.6 (69) (A 16 XER) | | Gasolina | FWD | 1598 | 85 | 116 | 07.08-03.17 | * |
| 1.6 SIDI (69) (A 16 XHT) | | Gasolina | FWD | 1598 | 125 | 170 | 03.13-03.17 | * |
| 1.6 SIDI (69) (B 16 SHL) | | Gasolina | FWD | 1598 | 125 | 170 | 03.13-03.17 | * |
| 1.6 Turbo (69) (A 16 LET) | | Gasolina | FWD | 1598 | 132 | 180 | 07.08-03.17 | * |
| 1.8 (69) (A 18 XER) | | Gasolina | FWD | 1796 | 103 | 140 | 07.08-03.17 | * |
| 1.8 (69) (B 18 XER) | | Gasolina | FWD | 1796 | 103 | 140 | 07.08-03.17 | * |
| 2.0 Turbo (69) (A 20 NHT) | | Gasolina | FWD | 1998 | 162 | 220 | 07.08-03.17 | * |
| 2.0 Turbo 4x4 (69) (A 20 NHT) | | Gasolina | 4WD | 1998 | 162 | 220 | 07.08-03.17 | * |
| 2.0 Turbo (69) (A 20 NHT) | | Gasolina | FWD | 1998 | 184 | 250 | 04.14-03.17 | * |
| 2.0 Turbo (69) (B 20 NHT) | | Gasolina | FWD | 1998 | 184 | 250 | 04.14-03.17 | * |
| 2.0 Turbo 4x4 (69) (A 20 NFT) | | Gasolina | 4WD | 1998 | 184 | 250 | 07.11-03.17 | * |
| 2.0 Turbo 4x4 (69) (A 20 NHT) | | Gasolina | 4WD | 1998 | 184 | 250 | 07.11-03.17 | * |
| 2.0 Turbo 4x4 (69) (B 20 NHT) | | Gasolina | 4WD | 1998 | 184 | 250 | 07.11-03.17 | * |
| 1.4 LPG (69) (A 14 NET) | | Gasol./Gas (LPG) | FWD | 1364 | 103 | 140 | 07.12-03.17 | * |

LISTA DE APLICACIONES - BUYERS GUIDE

| | | | | | | | | |
|--|--|------------------|-----|------|---|-----|-------------|---|
| 1.4 LPG (69) (B 14 NET) | | Gasol./Gas (LPG) | FWD | 1364 | 103 | 140 | 07.12-03.17 | * |
| 2.0 Turbo E85 (69) (A 20 NFT) | | Gasol./Etanol | FWD | 1998 | 162 | 220 | 07.08-03.17 | * |
| 1.6 CDTi (69) (B 16 DTJ) | | Diesel | FWD | 1598 | 88 | 120 | 07.15-03.17 | * |
| 1.6 CDTi (69) (B 16 DTH) | | Diesel | FWD | 1598 | 100 | 136 | 07.15-03.17 | * |
| 2.0 CDTi (69) (A 20 DTC) | | Diesel | FWD | 1956 | 81 | 110 | 07.08-03.17 | * |
| 2.0 CDTi (69) (A 20 DTL) | | Diesel | FWD | 1956 | 81 | 110 | 07.08-03.17 | * |
| 2.0 CDTi (69) (A 20 DTE) | | Diesel | FWD | 1956 | 88 | 120 | 03.12-03.17 | * |
| 2.0 CDTi (69) (A 20 DT) | | Diesel | FWD | 1956 | 96 | 131 | 07.08-03.17 | * |
| 2.0 CDTi (69) (A 20 DTJ) | | Diesel | FWD | 1956 | 96 | 131 | 07.08-03.17 | * |
| 2.0 CDTi (69) (A 20 DTE) | | Diesel | FWD | 1956 | 103 | 140 | 06.13-03.17 | * |
| 2.0 CDTi (69) (A 20 DTH) | | Diesel | FWD | 1956 | 118 | 160 | 07.08-03.17 | * |
| 2.0 CDTi 4x4 (69) (A 20 DTH) | | Diesel | 4WD | 1956 | 118 | 160 | 06.10-03.17 | * |
| 2.0 CDTi (69) (A 20 DTH) | | Diesel | FWD | 1956 | 120 | 163 | 07.13-03.17 | * |
| 2.0 CDTi 4x4 (69) (A 20 DTH) | | Diesel | 4WD | 1956 | 120 | 163 | 07.13-03.17 | * |
| 2.0 CDTi (69) (B 20 DTH) | | Diesel | FWD | 1956 | 125 | 170 | 11.14-03.17 | * |
| 2.0 CDTi 4x4 (69) (B 20 DTH) | | Diesel | 4WD | 1956 | 125 | 170 | 11.14-03.17 | * |
| 2.0 Biturbo CDTi (69) (A 20 DTR) | | Diesel | FWD | 1956 | 140 | 190 | 07.08-12.11 | * |
| 2.0 Biturbo CDTi 4x4 (69) (A 20 DTR) | | Diesel | 4WD | 1956 | 140 | 190 | 07.08-12.11 | * |
| 2.0 Biturbo CDTi (69) (A 20 DTR) | | Diesel | FWD | 1956 | 143 | 195 | 01.12-03.17 | * |
| 2.0 Biturbo CDTi 4x4 (69) (A 20 DTR) | | Diesel | 4WD | 1956 | 143 | 195 | 01.12-03.17 | * |
| INSIGNIA A Country Tourer (G09) 07.08-03.17 | | | | | [CAMBIADO]:Break (Executive car-E Segment) | | | |
| 1.6 CDTi (47) (B 16 DTJ) | | Diesel | FWD | 1598 | 88 | 120 | 07.15-03.17 | * |
| 1.6 CDTi (47) (B 16 DTH) | | Diesel | FWD | 1598 | 100 | 136 | 07.15-03.17 | * |
| 2.0 CDTi (47) (A 20 DTE) | | Diesel | FWD | 1956 | 88 | 120 | 03.12-03.17 | * |
| 2.0 CDTi (47) (A 20 DT) | | Diesel | FWD | 1956 | 96 | 131 | 07.08-03.17 | * |
| 2.0 CDTi (47) (A 20 DTJ) | | Diesel | FWD | 1956 | 96 | 131 | 07.08-03.17 | * |
| 2.0 CDTi (47) (A 20 DTH) | | Diesel | FWD | 1956 | 120 | 163 | 07.14-03.17 | * |
| 2.0 CDTi 4x4 (47) (A 20 DTH) | | Diesel | 4WD | 1956 | 120 | 163 | 09.13-03.17 | * |
| 2.0 CDTi (47) (B 20 DTH) | | Diesel | FWD | 1956 | 125 | 170 | 11.14-03.17 | * |
| 2.0 CDTi 4x4 (47) (B 20 DTH) | | Diesel | 4WD | 1956 | 125 | 170 | 11.14-03.17 | * |
| INSIGNIA A Sports Tourer (G09) 07.08- | | | | | [CAMBIADO]:Break (Executive car-E Segment) | | | |
| 1.4 (35) (A 14 NET) | | Gasolina | FWD | 1364 | 103 | 140 | 04.11-03.17 | * |
| 1.4 (35) (B 14 NET) | | Gasolina | FWD | 1364 | 103 | 140 | 04.11-03.17 | * |
| 1.6 (35) (A 16 XER) | | Gasolina | FWD | 1598 | 85 | 116 | 07.08-06.12 | * |
| 1.6 SIDI (35) (A 16 XHT) | | Gasolina | FWD | 1598 | 125 | 170 | 06.13-03.17 | * |
| 1.6 SIDI (35) (B 16 SHL) | | Gasolina | FWD | 1598 | 125 | 170 | 06.13-03.17 | * |
| 1.6 Turbo (35) (A 16 LET) | | Gasolina | FWD | 1598 | 132 | 180 | 01.09-06.13 | * |
| 1.8 (35) (A 18 XER) | | Gasolina | FWD | 1796 | 103 | 140 | 07.08-03.17 | * |
| 1.8 (35) (B 18 XER) | | Gasolina | FWD | 1796 | 103 | 140 | 07.08-03.17 | * |
| 2.0 Turbo (35) (A 20 NFT) | | Gasolina | FWD | 1998 | 162 | 220 | 07.08-06.13 | * |
| 2.0 Turbo (35) (A 20 NHT) | | Gasolina | FWD | 1998 | 162 | 220 | 07.08-06.13 | * |
| 2.0 Turbo 4x4 (35) (A 20 NHT) | | Gasolina | 4WD | 1998 | 162 | 220 | 07.08-06.11 | * |
| 2.0 Turbo (35) (A 20 NHT) | | Gasolina | FWD | 1998 | 184 | 250 | 04.14-03.17 | * |
| 2.0 Turbo (35) (B 20 NHT) | | Gasolina | FWD | 1998 | 184 | 250 | 04.14-03.17 | * |
| 2.0 Turbo 4x4 (35) (A 20 NFT) | | Gasolina | 4WD | 1998 | 184 | 250 | 09.11-03.17 | * |
| 2.0 Turbo 4x4 (35) (A 20 NHT) | | Gasolina | 4WD | 1998 | 184 | 250 | 09.11-03.17 | * |
| 2.0 Turbo 4x4 (35) (B 20 NHT) | | Gasolina | 4WD | 1998 | 184 | 250 | 09.11-03.17 | * |
| 1.4 LPG (35) (A 14 NET) | | Gasol./Gas (LPG) | FWD | 1364 | 103 | 140 | 09.12-03.17 | * |

LISTA DE APLICACIONES - BUYERS GUIDE

| | | | | | | | | |
|--|--|------------------|-----|------|-----|--|-------------|---|
| 1.4 LPG (35) (B 14 NET) | | Gasol./Gas (LPG) | FWD | 1364 | 103 | 140 | 09.12-03.17 | * |
| 2.0 E85 Turbo (35) (A 20 NFT) | | Gasol./Etanol | FWD | 1998 | 162 | 220 | 09.10-11.11 | * |
| 1.6 CDTi (35) (B 16 DTJ) | | Diesel | FWD | 1598 | 88 | 120 | 07.15-01.17 | * |
| 1.6 CDTi (35) (B 16 DTH) | | Diesel | FWD | 1598 | 100 | 136 | 07.15-12.16 | * |
| 2.0 CDTI (35) (A 20 DTC) | | Diesel | FWD | 1956 | 81 | 110 | 07.08-06.13 | * |
| 2.0 CDTI (35) (A 20 DTL) | | Diesel | FWD | 1956 | 81 | 110 | 07.08-06.13 | * |
| 2.0 CDTI (35) (A 20 DTE) | | Diesel | FWD | 1956 | 88 | 120 | 03.12-06.15 | * |
| 2.0 CDTI (35) (A 20 DT) | | Diesel | FWD | 1956 | 96 | 131 | 07.08-06.15 | * |
| 2.0 CDTI (35) (A 20 DTJ) | | Diesel | FWD | 1956 | 96 | 131 | 07.08-06.15 | * |
| 2.0 CDTI (35) (A 20 DTE) | | Diesel | FWD | 1956 | 103 | 140 | 07.13-06.15 | * |
| 2.0 CDTI (35) (A 20 DTH) | | Diesel | FWD | 1956 | 118 | 160 | 07.08-06.15 | * |
| 2.0 CDTI 4x4 (35) (A 20 DTH) | | Diesel | 4WD | 1956 | 118 | 160 | 06.10-06.15 | * |
| 2.0 CDTI (35) (A 20 DTH) | | Diesel | FWD | 1956 | 120 | 163 | 07.13-06.15 | * |
| 2.0 CDTI 4x4 (35) (A 20 DTH) | | Diesel | 4WD | 1956 | 120 | 163 | 07.13-06.15 | * |
| 2.0 CDTI (35) (B 20 DTH) | | Diesel | FWD | 1956 | 125 | 170 | 11.14-12.16 | * |
| 2.0 CDTI 4x4 (35) (B 20 DTH) | | Diesel | 4WD | 1956 | 125 | 170 | 11.14-12.16 | * |
| 2.0 Biturbo CDTI (35) (A 20 DTR) | | Diesel | FWD | 1956 | 140 | 190 | 07.08-03.17 | * |
| 2.0 Biturbo CDTI 4x4 (35) (A 20 DTR) | | Diesel | 4WD | 1956 | 140 | 190 | 07.08-03.17 | * |
| 2.0 Biturbo CDTI (35) (A 20 DTR) | | Diesel | FWD | 1956 | 143 | 195 | 01.12-06.15 | * |
| 2.0 Biturbo CDTI 4x4 (35) (A 20 DTR) | | Diesel | 4WD | 1956 | 143 | 195 | 01.12-06.15 | * |
| SAAB | | | | | | | | |
| 9-5 (YS3E) 10.98-12.09 | | | | | | [CAMBIADO]:Break (Executive car-E Segment) | | |
| 2.0 t Biopower | | Gasolina | FWD | 1998 | 162 | 220 | 01.09- | * |
| 9-5 II (YS3G) 01.10-01.12 | | | | | | Sedán (Executive car-E Segment) | | |
| 1.6 Turbo (A 16 LET) | | Gasolina | FWD | 1598 | 132 | 180 | 05.10-01.12 | * |
| 2.0 Turbo (A 20 NHT) | | Gasolina | FWD | 1998 | 162 | 220 | 05.10-01.12 | * |
| 2.0 Turbo XWD (A 20 NHT) | | Gasolina | 4WD | 1998 | 162 | 220 | 05.10-01.12 | * |
| 2.0 (A 20 NFT) | | Gasolina | FWD | 1998 | 164 | 223 | 09.10-01.12 | * |
| 2.8 Turbo V6 XWD (A 28 NER) | | Gasolina | 4WD | 2792 | 221 | 301 | 05.10-01.12 | * |
| 2.8 AWD (A28 NER) | | Gasolina | 4WD | 2792 | 224 | 305 | 05.10-01.12 | * |
| 2.0 t Biopower (A 20 NFT) | | Gasol./Etanol | FWD | 1998 | 162 | 220 | 05.10-01.12 | * |
| 2.0 t BioPower XWD (A 20 NHT) | | Gasol./Etanol | 4WD | 1998 | 162 | 220 | 05.10-01.12 | * |
| 2.0 TiD (A 20 DTH) | | Diesel | FWD | 1956 | 118 | 160 | 05.10-01.12 | * |
| 2.0 TTiD (A 20 DTR) | | Diesel | FWD | 1956 | 140 | 190 | 05.10-01.12 | * |
| 2.0 TTiD XWD (A 20 DTR) | | Diesel | 4WD | 1956 | 140 | 190 | 05.10-01.12 | * |
| VAUXHALL | | | | | | | | |
| INSIGNIA Mk I (A) (G09) 07.08-05.17 | | | | | | [CAMBIADO]:Fastback (Executive car-E Segment) | | |
| 1.4 (68) (A 14 NET) | | Gasolina | FWD | 1364 | 103 | 140 | 04.11-05.17 | * |
| 1.4 (68) (B 14 NET) | | Gasolina | FWD | 1364 | 103 | 140 | 04.11-05.17 | * |
| 1.6 | | Gasolina | FWD | 1598 | 85 | 116 | 07.08-05.17 | * |
| 1.6 (A 16 XER) | | Gasolina | FWD | 1598 | 85 | 116 | 07.08-07.12 | * |
| 1.6 Turbo (68) (A 16 LET) | | Gasolina | FWD | 1598 | 132 | 180 | 01.09-05.17 | * |
| 1.8 (68) (A 18 XER) | | Gasolina | FWD | 1796 | 103 | 140 | 07.08-05.17 | * |
| 1.8 (68) (B 18 XER) | | Gasolina | FWD | 1796 | 103 | 140 | 07.08-05.17 | * |
| 2.0 Turbo (68) (A 20 NHT) | | Gasolina | FWD | 1998 | 184 | 250 | 07.11-05.17 | * |
| 2.0 Turbo (68) (B 20 NHT) | | Gasolina | FWD | 1998 | 184 | 250 | 07.11-05.17 | * |
| 1.4 LPG (68) (A 14 NET) | | Gasol./Gas (LPG) | FWD | 1364 | 103 | 140 | 07.12-05.17 | * |

LISTA DE APLICACIONES - BUYERS GUIDE

| | | | | | | | | |
|---|--|------------------|-----|------|---|-----|-------------|---|
| 1.6 CDTi (68) (B 16 DTJ) | | Diesel | FWD | 1598 | 88 | 120 | 07.15-05.17 | * |
| 1.6 CDTi (68) (B 16 DTH) | | Diesel | FWD | 1598 | 100 | 136 | 07.15-05.17 | * |
| 2.0 CDTi (68) (A 20 DTC) | | Diesel | FWD | 1956 | 81 | 110 | 07.08-05.17 | * |
| 2.0 CDTi (68) (A 20 DTL) | | Diesel | FWD | 1956 | 81 | 110 | 07.08-05.17 | * |
| 2.0 CDTi (68) (A 20 DTE) | | Diesel | FWD | 1956 | 88 | 120 | 03.12-03.16 | * |
| 2.0 CDTi (68) (A 20 DT) | | Diesel | FWD | 1956 | 96 | 130 | 07.08-12.14 | * |
| 2.0 CDTi (68) (A 20 DTJ) | | Diesel | FWD | 1956 | 96 | 130 | 07.08-12.14 | * |
| 2.0 CDTi (68) (A 20 DTE) | | Diesel | FWD | 1956 | 103 | 140 | 07.13-05.17 | * |
| 2.0 CDTi (68) (A 20 DTH) | | Diesel | FWD | 1956 | 118 | 160 | 07.08-05.17 | * |
| 2.0 CDTi 4x4 (68) (A 20 DTH) | | Diesel | 4WD | 1956 | 118 | 160 | 07.08-05.17 | * |
| 2.0 CDTi (68) (A 20 DTH) | | Diesel | FWD | 1956 | 120 | 163 | 07.13-05.17 | * |
| 2.0 CDTi (68) (B 20 DTH) | | Diesel | FWD | 1956 | 125 | 170 | 11.14-05.17 | * |
| 2.0 CDTi 4x4 (68) (B 20 DTH) | | Diesel | 4WD | 1956 | 125 | 170 | 11.14-05.17 | * |
| INSIGNIA Mk I (A) (G09) 07.08-05.17 | | | | | Sedán (Executive car-E Segment) | | | |
| 1.4 (69) (A 14 NET) | | Gasolina | FWD | 1364 | 103 | 140 | 04.11-05.17 | * |
| 1.6 | | Gasolina | FWD | 1598 | 85 | 116 | 07.08-05.17 | * |
| 1.6 (A 16 XER) | | Gasolina | FWD | 1598 | 85 | 116 | 07.08-07.12 | * |
| 1.6 SIDI | | Gasolina | FWD | 1598 | 125 | 170 | 03.13-05.17 | * |
| 1.6 Turbo (69) (A 16 LET) | | Gasolina | FWD | 1598 | 132 | 180 | 01.09-05.17 | * |
| 1.8 (69) (A 18 XER) | | Gasolina | FWD | 1796 | 103 | 140 | 07.08-05.17 | * |
| 2.0 Turbo (69) (A 20 NHT) | | Gasolina | FWD | 1998 | 184 | 250 | 09.11-05.17 | * |
| 2.0 Turbo (69) (B 20 NHT) | | Gasolina | FWD | 1998 | 184 | 250 | 09.11-05.17 | * |
| 1.4 LPG (69) (A 14 NET) | | Gasol./Gas (LPG) | FWD | 1364 | 103 | 140 | 07.12-05.17 | * |
| 1.6 CDTi (69) (B 16 DTJ) | | Diesel | FWD | 1598 | 88 | 120 | 07.15-05.17 | * |
| 1.6 CDTi (69) (B 16 DTH) | | Diesel | FWD | 1598 | 100 | 136 | 07.15-05.17 | * |
| 2.0 CDTi (69) | | Diesel | FWD | 1956 | 81 | 110 | 07.08-05.17 | * |
| 2.0 CDTi (69) (A 20 DT) | | Diesel | FWD | 1956 | 96 | 130 | 07.08-12.14 | * |
| 2.0 CDTi (69) (A 20 DTJ) | | Diesel | FWD | 1956 | 96 | 130 | 07.08-12.14 | * |
| 2.0 CDTi (69) (A 20 DTE) | | Diesel | FWD | 1956 | 103 | 140 | 07.13-05.17 | * |
| 2.0 CDTi (69) (A 20 DTH) | | Diesel | FWD | 1956 | 118 | 160 | 07.08-05.17 | * |
| 2.0 CDTi 4x4 (69) (A 20 DTH) | | Diesel | 4WD | 1956 | 118 | 160 | 07.08-05.17 | * |
| 2.0 CDTi (69) (A 20 DTH) | | Diesel | FWD | 1956 | 120 | 163 | 07.13-05.17 | * |
| 2.0 CDTi (69) (B 20 DTH) | | Diesel | FWD | 1956 | 125 | 170 | 11.14-05.17 | * |
| 2.0 CDTi 4x4 (69) (B 20 DTH) | | Diesel | 4WD | 1956 | 125 | 170 | 11.14-05.17 | * |
| INSIGNIA Mk I (A) Country Tourer (G09) 07.08-05.17 | | | | | [CAMBIADO]:Break (Executive car-E Segment) | | | |
| 1.6 CDTi (47) (B 16 DTH) | | Diesel | FWD | 1598 | 100 | 136 | 07.15-05.17 | * |
| 2.0 CDTi (47) (A 20 DTH) | | Diesel | FWD | 1956 | 120 | 163 | 07.13-05.17 | * |
| 2.0 CDTi (47) (A 20 DTH) | | Diesel | 4WD | 1956 | 120 | 163 | 07.13-05.17 | * |
| 2.0 CDTi (47) (B 20 DTH) | | Diesel | FWD | 1956 | 125 | 170 | 11.14-05.17 | * |
| 2.0 CDTi 4x4 (47) (B 20 DTH) | | Diesel | 4WD | 1956 | 125 | 170 | 11.14-05.17 | * |
| INSIGNIA Mk I (A) Sports Tourer (G09) 07.08-05.17 | | | | | [CAMBIADO]:Break (Executive car-E Segment) | | | |
| 1.4 (35) (A 14 NET) | | Gasolina | FWD | 1364 | 103 | 140 | 04.11-05.17 | * |
| 1.4 (35) (B 14 NET) | | Gasolina | FWD | 1364 | 103 | 140 | 04.11-05.17 | * |
| 1.6 | | Gasolina | FWD | 1598 | 85 | 116 | 07.08-05.17 | * |
| 1.6 (A 16 XER) | | Gasolina | FWD | 1598 | 85 | 116 | 07.08-07.12 | * |
| 1.6 Turbo (35) (A 16 LET) | | Gasolina | FWD | 1598 | 132 | 180 | 01.09-05.17 | * |
| 1.8 (35) (A 18 XER) | | Gasolina | FWD | 1796 | 103 | 140 | 07.08-05.17 | * |
| 2.0 Turbo (35) (A 20 NHT) | | Gasolina | FWD | 1998 | 184 | 250 | 07.11-05.17 | * |
| 2.0 Turbo (35) (B 20 NHT) | | Gasolina | FWD | 1998 | 184 | 250 | 07.11-05.17 | * |

LISTA DE APLICACIONES - BUYERS GUIDE

| | | | | | | | |
|------------------------------|------------------|-----|------|-----|-----|-------------|---|
| 1.4 LPG (35) (A 14 NET) | Gasol./Gas (LPG) | FWD | 1364 | 103 | 140 | 07.12-05.17 | * |
| 1.6 CDTi (35) (B 16 DTH) | Diesel | FWD | 1598 | 100 | 136 | 07.15-05.17 | * |
| 2.0 CDTI (35) (A 20 DTC) | Diesel | FWD | 1956 | 81 | 110 | 07.08-05.17 | * |
| 2.0 CDTI (35) (A 20 DTE) | Diesel | FWD | 1956 | 88 | 120 | 03.12-03.16 | * |
| 2.0 CDTI (35) (A 20 DT) | Diesel | FWD | 1956 | 96 | 130 | 07.08-12.14 | * |
| 2.0 CDTI (35) (A 20 DTJ) | Diesel | FWD | 1956 | 96 | 130 | 07.08-12.14 | * |
| 2.0 CDTI (35) (A 20 DTE) | Diesel | FWD | 1956 | 103 | 140 | 07.13-05.17 | * |
| 2.0 CDTI (35) (A 20 DTH) | Diesel | FWD | 1956 | 118 | 160 | 07.08-05.17 | * |
| 2.0 CDTI 4x4 (35) (A 20 DTH) | Diesel | 4WD | 1956 | 118 | 160 | 07.08-05.17 | * |
| 2.0 CDTI (35) (A 20 DTH) | Diesel | FWD | 1956 | 120 | 163 | 07.13-05.17 | * |
| 2.0 CDTI (35) (B 20 DTH) | Diesel | FWD | 1956 | 125 | 170 | 11.14-05.17 | * |
| 2.0 CDTI 4x4 (35) (B 20 DTH) | Diesel | 4WD | 1956 | 125 | 170 | 11.14-05.17 | * |