

LISTA DE APLICACIONES - BUYERS GUIDE

78RBD23790



8 424073 153586

Weight: 8.976

| O.E.M. | MAKE |
|---------------|------|
| 321 615 301 D | VW |
| 6N0 615 301 D | VW |

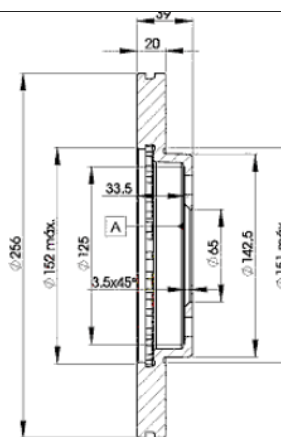

78RBD23790

E1 90R-02C0452/0026



Ø256x20x38.7

Sin Filas



| Trac. | CC | Kw | CV | |
|-------|----|----|----|--------------|
| | | | | Front / Rear |

SEAT

CORDOBA (6K1, 6K2) 02.93-12.02

Sedán (Supermini car-B Segment)

| | | | | | | | |
|-----------------|----------|-----|------|----|-----|-------------|---|
| 1.0 (AST) | Gasolina | FWD | 999 | 51 | 69 | 06.01-08.02 | * |
| 1.0 (AVZ) | Gasolina | FWD | 999 | 51 | 69 | 06.01-08.02 | * |
| 1.6 i (AEH) | Gasolina | FWD | 1595 | 74 | 101 | 07.96-10.02 | * |
| 1.6 i (AFT) | Gasolina | FWD | 1595 | 74 | 101 | 07.96-10.02 | * |
| 1.6 i (AKL) | Gasolina | FWD | 1595 | 74 | 101 | 07.96-10.02 | * |
| 1.6 i (APF) | Gasolina | FWD | 1595 | 74 | 101 | 07.96-10.02 | * |
| 1.6 i (AUR) | Gasolina | FWD | 1595 | 74 | 101 | 07.96-10.02 | * |
| 1.8 i 16V (ADL) | Gasolina | FWD | 1781 | 95 | 129 | 10.93-08.96 | * |
| 2.0 i (2E) | Gasolina | FWD | 1984 | 85 | 115 | 02.93-06.99 | * |
| 2.0 i (AGG) | Gasolina | FWD | 1984 | 85 | 115 | 02.93-06.99 | * |
| 1.9 TDI (AFN) | Diesel | FWD | 1896 | 81 | 110 | 03.97-10.02 | * |
| 1.9 TDI (ASV) | Diesel | FWD | 1896 | 81 | 110 | 03.97-10.02 | * |

CORDOBA II (6K5) 08.00-12.02

[CAMBIADO]:Furgón/Break (Supermini car-B Segment)

| | | | | | | | |
|---------|--------|-----|------|----|-----|-------------|---|
| 1.9 TDI | Diesel | FWD | 1896 | 81 | 110 | 08.00-12.02 | * |
|---------|--------|-----|------|----|-----|-------------|---|

CORDOBA II (6K2) 06.99-10.02

Sedán (Supermini car-B Segment)

| | | | | | | | |
|---------|----------|-----|------|----|-----|-------------|---|
| 1.4 16V | Gasolina | FWD | 1390 | 74 | 100 | 02.00-10.02 | * |
| 1.6 | Gasolina | FWD | 1595 | 74 | 101 | 06.99-10.02 | * |
| 1.9 TDI | Diesel | FWD | 1896 | 66 | 90 | 06.99-10.02 | * |
| 1.9 TDI | Diesel | FWD | 1896 | 81 | 110 | 06.99-10.02 | * |

CORDOBA II Vario (6K5) 06.99-12.02

[CAMBIADO]:Break (Supermini car-B Segment)

| | | | | | | | |
|-----|----------|-----|------|----|-----|-------------|---|
| 1.6 | Gasolina | FWD | 1595 | 74 | 101 | 06.99-12.02 | * |
|-----|----------|-----|------|----|-----|-------------|---|

LISTA DE APLICACIONES - BUYERS GUIDE

| | | | | | | | | |
|--|--|----------|-----|------|--|-----|-------------|---|
| 1.9 TDI | | Diesel | FWD | 1896 | 66 | 90 | 06.99-12.02 | * |
| 1.9 TDI | | Diesel | FWD | 1896 | 81 | 110 | 06.99-12.02 | * |
| CORDOBA Vario (6K5) 07.96-12.02 | | | | | [CAMBIADO]:Break (Supermini car-B Segment) | | | |
| 1.4 (AQQ) | | Gasolina | FWD | 1390 | 74 | 101 | 02.00-07.00 | * |
| 1.6 i (1F) | | Gasolina | FWD | 1595 | 55 | 75 | 05.97-06.99 | * |
| 1.6 i (AEH) | | Gasolina | FWD | 1595 | 74 | 101 | 09.96-12.02 | * |
| 1.6 i (AFT) | | Gasolina | FWD | 1595 | 74 | 101 | 09.96-12.02 | * |
| 1.6 i (AKL) | | Gasolina | FWD | 1595 | 74 | 101 | 09.96-12.02 | * |
| 1.6 i (APF) | | Gasolina | FWD | 1595 | 74 | 101 | 09.96-12.02 | * |
| 1.6 i (AUR) | | Gasolina | FWD | 1595 | 74 | 101 | 09.96-12.02 | * |
| 1.6 i (ABU) | | Gasolina | FWD | 1598 | 55 | 75 | 09.96-12.02 | * |
| 1.6 i (AEE) | | Gasolina | FWD | 1598 | 55 | 75 | 09.96-12.02 | * |
| 1.6 i (ALM) | | Gasolina | FWD | 1598 | 55 | 75 | 09.96-12.02 | * |
| 1.9 TDI (1Z) | | Diesel | FWD | 1896 | 66 | 90 | 08.96-12.02 | * |
| 1.9 TDI (AGR) | | Diesel | FWD | 1896 | 66 | 90 | 08.96-12.02 | * |
| 1.9 TDI (AHU) | | Diesel | FWD | 1896 | 66 | 90 | 08.96-12.02 | * |
| 1.9 TDI (ALH) | | Diesel | FWD | 1896 | 66 | 90 | 08.96-12.02 | * |
| 1.9 TDI (AFN) | | Diesel | FWD | 1896 | 81 | 110 | 07.97-12.02 | * |
| 1.9 TDI (ASV) | | Diesel | FWD | 1896 | 81 | 110 | 07.97-12.02 | * |
| IBIZA II (6K1) 03.93-05.02 | | | | | [CAMBIADO]:Fastback (Supermini car-B Segment) | | | |
| 1.4 16V | | Gasolina | FWD | 1390 | 74 | 100 | 08.99-02.02 | * |
| 1.4 i 16V (AFH) | | Gasolina | FWD | 1390 | 74 | 101 | 06.97-02.02 | * |
| 1.4 i 16V (AQQ) | | Gasolina | FWD | 1390 | 74 | 101 | 06.97-02.02 | * |
| 1.4 i 16V (AUB) | | Gasolina | FWD | 1390 | 74 | 101 | 06.97-02.02 | * |
| 1.6 i (AEH) | | Gasolina | FWD | 1595 | 74 | 101 | 04.96-02.02 | * |
| 1.6 i (AFT) | | Gasolina | FWD | 1595 | 74 | 101 | 04.96-02.02 | * |
| 1.6 i (AKL) | | Gasolina | FWD | 1595 | 74 | 101 | 04.96-02.02 | * |
| 1.6 i (APF) | | Gasolina | FWD | 1595 | 74 | 101 | 04.96-02.02 | * |
| 1.6 i (AUR) | | Gasolina | FWD | 1595 | 74 | 101 | 04.96-02.02 | * |
| 1.8 i 16V (ADL) | | Gasolina | FWD | 1781 | 95 | 129 | 11.93-08.96 | * |
| 2.0 i (2E) | | Gasolina | FWD | 1984 | 85 | 115 | 03.93-08.99 | * |
| 2.0 i (AGG) | | Gasolina | FWD | 1984 | 85 | 115 | 03.93-08.99 | * |
| 1.9 TDI | | Diesel | RWD | 1896 | 81 | 110 | 08.99-02.02 | * |
| INCA (6K9) 11.95-11.03 | | | | | [CAMBIADO]:Furgón/Break (Supermini car-B Segment) | | | |
| 1.4 i (AEX) | | Gasolina | FWD | 1389 | 44 | 60 | 11.95-06.03 | * |
| 1.4 i (AKV) | | Gasolina | FWD | 1389 | 44 | 60 | 11.95-06.03 | * |
| 1.4 i (APQ) | | Gasolina | FWD | 1389 | 44 | 60 | 11.95-06.03 | * |
| 1.4 i (AUD) | | Gasolina | FWD | 1389 | 44 | 60 | 11.95-06.03 | * |
| 1.4 16V (AUA) | | Gasolina | FWD | 1390 | 55 | 75 | 04.00-06.03 | * |
| 1.6 i (1F) | | Gasolina | FWD | 1595 | 55 | 75 | 11.95-05.98 | * |
| 1.6 | | Gasolina | FWD | 1595 | 70 | 95 | 08.99-04.02 | * |
| 1.6 i (AEE) | | Gasolina | FWD | 1598 | 55 | 75 | 06.97-09.00 | * |
| 1.6 i (ALM) | | Gasolina | FWD | 1598 | 55 | 75 | 06.97-09.00 | * |
| 1.6 | | Gasolina | FWD | 1598 | 66 | 90 | 11.98-11.03 | * |
| 1.7 D (AHB) | | Diesel | FWD | 1715 | 42 | 57 | 09.96-06.03 | * |
| 1.9 D (1Y) | | Diesel | FWD | 1896 | 47 | 64 | 11.95-06.03 | * |
| 1.9 SDI (AEY) | | Diesel | FWD | 1896 | 47 | 64 | 11.95-06.03 | * |
| 1.9 SDI (AYQ) | | Diesel | FWD | 1896 | 47 | 64 | 11.95-06.03 | * |
| 1.9 TDI (ALH) | | Diesel | FWD | 1896 | 66 | 90 | 09.96-06.03 | * |

LISTA DE APLICACIONES - BUYERS GUIDE

| TOLEDO (1L2) 01.91-10.99 | | | | | [CAMBIADO]:Fastback (Compact car-C Segment) | | | |
|---------------------------------------|--|----------|-----|------|---|-----|-------------|---|
| 1.6 i (AFT) | | Gasolina | FWD | 1595 | 74 | 101 | 11.96-03.99 | * |
| 1.8 16V (PL) | | Gasolina | FWD | 1781 | 92 | 125 | 05.91-03.99 | * |
| 1.8 16V (KR) | | Gasolina | FWD | 1781 | 98 | 133 | 05.91-03.99 | * |
| 1.8 GT | | Gasolina | FWD | 1781 | 102 | 139 | 05.91-11.92 | * |
| 2.0 i (2E) | | Gasolina | FWD | 1984 | 85 | 115 | 05.91-03.99 | * |
| 2.0 i (AGG) | | Gasolina | FWD | 1984 | 85 | 115 | 05.91-03.99 | * |
| 1.9 TDI (1Z) | | Diesel | FWD | 1896 | 66 | 90 | 08.95-03.99 | * |
| 1.9 TDI (AHU) | | Diesel | FWD | 1896 | 66 | 90 | 08.95-03.99 | * |
| 1.9 TDI (AFN) | | Diesel | FWD | 1896 | 81 | 110 | 11.96-03.99 | * |
| VW | | | | | | | | |
| CADDY II (9K9B) 11.95-12.04 | | | | | MPV (Mini MPV-M1 Segment) | | | |
| 1.4 (AEX) | | Gasolina | FWD | 1390 | 44 | 60 | 11.95-06.03 | * |
| 1.4 (AKV) | | Gasolina | FWD | 1390 | 44 | 60 | 11.95-06.03 | * |
| 1.4 (APQ) | | Gasolina | FWD | 1390 | 44 | 60 | 11.95-06.03 | * |
| 1.4 (AUD) | | Gasolina | FWD | 1390 | 44 | 60 | 11.95-06.03 | * |
| 1.4 16V (AUA) | | Gasolina | FWD | 1390 | 55 | 75 | 08.00-01.04 | * |
| 1.6 (1F) | | Gasolina | FWD | 1595 | 55 | 75 | 11.95-05.97 | * |
| 1.6 | | Gasolina | FWD | 1595 | 65 | 88 | 04.96-07.03 | * |
| 1.6 (AEE) | | Gasolina | FWD | 1598 | 55 | 75 | 06.97-09.00 | * |
| 1.7 SDI (AHB) | | Diesel | FWD | 1715 | 42 | 57 | 07.96-09.00 | * |
| 1.9 D (1Y) | | Diesel | FWD | 1896 | 47 | 64 | 11.95-01.04 | * |
| 1.9 SDI (AEY) | | Diesel | FWD | 1896 | 47 | 64 | 11.95-01.04 | * |
| 1.9 SDI (AYQ) | | Diesel | FWD | 1896 | 47 | 64 | 11.95-01.04 | * |
| 1.9 TDI (1Z) | | Diesel | FWD | 1896 | 66 | 90 | 10.96-01.04 | * |
| 1.9 TDI (AHU) | | Diesel | FWD | 1896 | 66 | 90 | 10.96-01.04 | * |
| 1.9 TDI (ALE) | | Diesel | FWD | 1896 | 66 | 90 | 10.96-01.04 | * |
| 1.9 TDI (ALH) | | Diesel | FWD | 1896 | 66 | 90 | 10.96-01.04 | * |
| CADDY II (9U7) 06.96-12.00 | | | | | Pick-up (LCVs-N1 Segment) | | | |
| 1.6 (AEE) | | Gasolina | FWD | 1598 | 55 | 75 | 06.96-12.00 | * |
| 1.9 D (AEF) | | Diesel | FWD | 1896 | 47 | 64 | 06.96-12.00 | * |
| CADDY II / PANEL (9K9A) 11.95-01.04 | | | | | Furgoneta/MPV (LCVs-N1 Segment) | | | |
| 60 1.4 (AEX) | | Gasolina | FWD | 1390 | 44 | 60 | 11.95-01.04 | * |
| 60 1.4 (APQ) | | Gasolina | FWD | 1390 | 44 | 60 | 11.95-01.04 | * |
| 60 1.4 (AUD) | | Gasolina | FWD | 1390 | 44 | 60 | 11.95-01.04 | * |
| 1.4 (AUA) | | Gasolina | FWD | 1390 | 55 | 75 | 08.00-01.04 | * |
| 75 1.6 (1F) | | Gasolina | FWD | 1595 | 55 | 75 | 11.95-05.97 | * |
| 1.6 | | Gasolina | FWD | 1596 | 65 | 88 | 11.98-12.03 | * |
| 75 1.6 (AEE) | | Gasolina | FWD | 1598 | 55 | 75 | 11.95-09.00 | * |
| 1.7 SDI (AHB) | | Diesel | FWD | 1715 | 42 | 57 | 07.96-09.00 | * |
| 1.9 D (1Y) | | Diesel | FWD | 1896 | 47 | 64 | 11.95-01.04 | * |
| 1.9 SDI (AEY) | | Diesel | FWD | 1896 | 47 | 64 | 11.95-01.04 | * |
| 1.9 SDI (AYQ) | | Diesel | FWD | 1896 | 47 | 64 | 11.95-01.04 | * |
| 1.9 TDI (1Z) | | Diesel | FWD | 1896 | 66 | 90 | 09.96-01.04 | * |
| 1.9 TDI (AHU) | | Diesel | FWD | 1896 | 66 | 90 | 09.96-01.04 | * |
| 1.9 TDI (ALE) | | Diesel | FWD | 1896 | 66 | 90 | 09.96-01.04 | * |
| 1.9 TDI (ALH) | | Diesel | FWD | 1896 | 66 | 90 | 09.96-01.04 | * |
| CADDY III (6K9, 9E7, 9E9) 09.02-12.09 | | | | | Furgoneta/MPV (LCVs-N1 Segment) | | | |
| 1.9 D | | Diesel | FWD | 1896 | 47 | 64 | 02.98-06.09 | * |

LISTA DE APLICACIONES - BUYERS GUIDE

| CADDY III (6K9, 9E7, 9E9) 09.02-12.09 | | | | | MPV (Mini MPV-M1 Segment) | | | |
|--|--|---------------|-----|------|--|-----|-------------|---|
| 1.9 D | | Diesel | FWD | 1896 | 47 | 64 | 10.05-06.09 | * |
| CORRADO (53I) 08.87-12.95 | | | | | Coupé (Compact car-C Segment) | | | |
| 1.8 16V (KR) | | Gasolina | FWD | 1781 | 100 | 136 | 04.89-07.92 | * |
| 1.8 G60 (PG) | | Gasolina | FWD | 1781 | 118 | 160 | 09.88-09.93 | * |
| 2.0 i (2E) | | Gasolina | FWD | 1984 | 85 | 115 | 04.93-12.95 | * |
| 2.0 i (ADY) | | Gasolina | FWD | 1984 | 85 | 115 | 04.93-12.95 | * |
| 2.0 i 16V (9A) | | Gasolina | FWD | 1984 | 100 | 136 | 08.91-12.95 | * |
| GOL II 06.94-06.13 | | | | | [CAMBIADO]:Fastback (Supermini car-B Segment) | | | |
| 1.6 (BW1, BX1) (BWX) | | Gasolina | FWD | 1595 | 73 | 99 | 12.99-06.10 | * |
| GOL III 09.98-09.06 | | | | | [CAMBIADO]:Fastback (Supermini car-B Segment) | | | |
| 1.6 (UNF) | | Gasolina | FWD | 1595 | 68 | 92 | 01.02-08.06 | * |
| 1.6 Álcool | | Etanol | FWD | 1595 | 73 | 99 | 09.99-08.05 | * |
| GOL IV 05.03-12.14 | | | | | [CAMBIADO]:Fastback (Supermini car-B Segment) | | | |
| 1.6 (UNF) | | Gasolina | FWD | 1595 | 68 | 92 | 10.05-12.13 | * |
| 1.6 TotalFlex (UNF) | | Gasol./Etanol | FWD | 1595 | 68 | 92 | 09.05-05.08 | * |
| GOLF II (19E, 1G1) 08.83-12.92 | | | | | [CAMBIADO]:Fastback (Compact car-C Segment) | | | |
| 1.8 GTI 16V (PL) | | Gasolina | FWD | 1781 | 95 | 129 | 02.86-10.91 | * |
| 1.8 GTI 16V (KR) | | Gasolina | FWD | 1781 | 102 | 139 | 02.86-06.90 | * |
| GOLF III (1H1) 10.89-11.00 | | | | | [CAMBIADO]:Fastback (Compact car-C Segment) | | | |
| 1.0 | | Gasolina | FWD | 997 | 37 | 50 | 10.94-09.96 | * |
| 1.4 (ABD) | | Gasolina | FWD | 1390 | 40 | 55 | 11.91-08.97 | * |
| 1.4 (AEX) | | Gasolina | FWD | 1390 | 40 | 55 | 11.91-08.97 | * |
| 1.4 (ABD) | | Gasolina | FWD | 1390 | 44 | 60 | 10.91-08.97 | * |
| 1.4 (AEX) | | Gasolina | FWD | 1390 | 44 | 60 | 10.91-08.97 | * |
| 1.6 (AEK) | | Gasolina | FWD | 1595 | 74 | 101 | 07.95-08.97 | * |
| 1.6 (AFT) | | Gasolina | FWD | 1595 | 74 | 101 | 07.95-08.97 | * |
| 1.6 (AKS) | | Gasolina | FWD | 1595 | 74 | 101 | 07.95-08.97 | * |
| 1.6 (ABU) | | Gasolina | FWD | 1598 | 55 | 75 | 09.92-08.97 | * |
| 1.6 (AEA) | | Gasolina | FWD | 1598 | 55 | 75 | 09.92-08.97 | * |
| 1.6 (AEE) | | Gasolina | FWD | 1598 | 55 | 75 | 09.92-08.97 | * |
| 1.8 (AAM) | | Gasolina | FWD | 1781 | 55 | 75 | 11.91-08.97 | * |
| 1.8 (ABS) | | Gasolina | FWD | 1781 | 66 | 90 | 11.91-08.97 | * |
| 1.8 (ACC) | | Gasolina | FWD | 1781 | 66 | 90 | 11.91-08.97 | * |
| 1.8 (ADD) | | Gasolina | FWD | 1781 | 66 | 90 | 11.91-08.97 | * |
| 1.8 (ADZ) | | Gasolina | FWD | 1781 | 66 | 90 | 11.91-08.97 | * |
| 2.0 GL (AEP) | | Gasolina | FWD | 1984 | 79 | 107 | 08.95-09.97 | * |
| 2.0 (2E) | | Gasolina | FWD | 1984 | 85 | 115 | 11.91-08.97 | * |
| 2.0 (ABA) | | Gasolina | FWD | 1984 | 85 | 115 | 11.91-08.97 | * |
| 2.0 (ADC) | | Gasolina | FWD | 1984 | 85 | 115 | 11.91-08.97 | * |
| 2.0 (ADY) | | Gasolina | FWD | 1984 | 85 | 115 | 11.91-08.97 | * |
| 2.0 (AGG) | | Gasolina | FWD | 1984 | 85 | 115 | 11.91-08.97 | * |
| 2.0 (AKR) | | Gasolina | FWD | 1984 | 85 | 115 | 11.91-08.97 | * |
| 2.0 Syncro (1HX1) (AGG) | | Gasolina | 4WD | 1984 | 85 | 115 | 08.95-08.97 | * |
| 1.9 D (1Y) | | Diesel | FWD | 1896 | 47 | 64 | 11.91-08.97 | * |
| 1.9 SDI (AEY) | | Diesel | FWD | 1896 | 47 | 64 | 07.95-08.97 | * |
| 1.9 TD, GTD (AAZ) | | Diesel | FWD | 1896 | 55 | 75 | 11.91-08.97 | * |

LISTA DE APLICACIONES - BUYERS GUIDE

| | | | | | | | | |
|--|--|----------|-----|------|--|-----|-------------|---|
| 1.9 TDI (1Z) | | Diesel | FWD | 1896 | 66 | 90 | 08.93-12.97 | * |
| 1.9 TDI (AHU) | | Diesel | FWD | 1896 | 66 | 90 | 08.93-12.97 | * |
| 1.9 TDI (ALE) | | Diesel | FWD | 1896 | 66 | 90 | 08.93-12.97 | * |
| 1.9 TDI (AFN) | | Diesel | FWD | 1896 | 81 | 110 | 04.96-08.97 | * |
| GOLF III / CABRIO III (1E7) 07.93-05.98 | | | | | Cabrio (Compact car-C Segment) | | | |
| 1.6 (AEK) | | Gasolina | FWD | 1595 | 74 | 101 | 10.94-02.98 | * |
| 1.6 (AFT) | | Gasolina | FWD | 1595 | 74 | 101 | 10.94-02.98 | * |
| 1.6 (AKS) | | Gasolina | FWD | 1595 | 74 | 101 | 10.94-02.98 | * |
| 1.8 (AAM) | | Gasolina | FWD | 1781 | 55 | 75 | 07.93-05.98 | * |
| 1.8 (ABS) | | Gasolina | FWD | 1781 | 66 | 90 | 07.93-05.98 | * |
| 1.8 (ADZ) | | Gasolina | FWD | 1781 | 66 | 90 | 07.93-05.98 | * |
| 2.0 (2E) | | Gasolina | FWD | 1984 | 85 | 115 | 07.93-05.98 | * |
| 2.0 (ABA) | | Gasolina | FWD | 1984 | 85 | 115 | 07.93-05.98 | * |
| 2.0 (ADY) | | Gasolina | FWD | 1984 | 85 | 115 | 07.93-05.98 | * |
| 2.0 (AGG) | | Gasolina | FWD | 1984 | 85 | 115 | 07.93-05.98 | * |
| 2.0 (AKR) | | Gasolina | FWD | 1984 | 85 | 115 | 07.93-05.98 | * |
| 1.9 TDI (1Z) | | Diesel | FWD | 1896 | 66 | 90 | 08.95-05.98 | * |
| 1.9 TDI (AHU) | | Diesel | FWD | 1896 | 66 | 90 | 08.95-05.98 | * |
| 1.9 TDI (ALE) | | Diesel | FWD | 1896 | 66 | 90 | 08.95-05.98 | * |
| 1.9 TDI (AFN) | | Diesel | FWD | 1896 | 81 | 110 | 07.96-05.98 | * |
| GOLF III Van (1H5) 08.91-12.99 | | | | | [CAMBIADO]:Furgón/Break (Compact car-C Segment) | | | |
| 1.4 (ABD) | | Gasolina | FWD | 1390 | 44 | 60 | 05.93-07.95 | * |
| 1.4 (AEX) | | Gasolina | FWD | 1390 | 44 | 60 | 05.93-07.95 | * |
| 1.8 (AAM) | | Gasolina | FWD | 1781 | 55 | 75 | 07.93-02.99 | * |
| 1.8 (ABS) | | Gasolina | FWD | 1781 | 66 | 90 | 08.93-12.99 | * |
| 1.8 (ADZ) | | Gasolina | FWD | 1781 | 66 | 90 | 08.93-12.99 | * |
| 1.9 (1Y) | | Diesel | FWD | 1896 | 47 | 64 | 08.93-02.99 | * |
| 1.9 TDI (1Z) | | Diesel | FWD | 1896 | 66 | 90 | 08.93-12.99 | * |
| 1.9 TDI (AHU) | | Diesel | FWD | 1896 | 66 | 90 | 08.93-12.99 | * |
| 1.9 TDI (AFN) | | Diesel | FWD | 1896 | 81 | 110 | 05.96-02.99 | * |
| GOLF III Van (1H1) 08.91-12.97 | | | | | Furgón/hatchback (Compact car-C Segment) | | | |
| 1.4 (ABD) | | Gasolina | FWD | 1390 | 44 | 60 | 08.91-05.96 | * |
| 1.4 (AEX) | | Gasolina | FWD | 1390 | 44 | 60 | 08.91-05.96 | * |
| 1.6 | | Gasolina | FWD | 1598 | 55 | 75 | 08.92-09.97 | * |
| 1.8 (AAM) | | Gasolina | FWD | 1781 | 55 | 75 | 08.91-07.95 | * |
| 1.8 (ABS) | | Gasolina | FWD | 1781 | 66 | 90 | 08.91-12.97 | * |
| 1.8 (ADZ) | | Gasolina | FWD | 1781 | 66 | 90 | 08.91-12.97 | * |
| 2.0 (AGG) | | Gasolina | FWD | 1984 | 85 | 116 | 08.95-09.97 | * |
| 1.9 SDI (AEY) | | Diesel | FWD | 1896 | 47 | 64 | 08.95-09.97 | * |
| 1.9 TDI (1Z) | | Diesel | FWD | 1896 | 66 | 90 | 08.91-09.97 | * |
| GOLF III Variant (1H5) 07.93-04.99 | | | | | [CAMBIADO]:Break (Compact car-C Segment) | | | |
| 1.4 (ABD) | | Gasolina | FWD | 1390 | 40 | 55 | 07.93-04.99 | * |
| 1.4 (ABD) | | Gasolina | FWD | 1390 | 44 | 60 | 07.93-04.99 | * |
| 1.4 (AEX) | | Gasolina | FWD | 1390 | 44 | 60 | 07.93-04.99 | * |
| 1.4 (APQ) | | Gasolina | FWD | 1390 | 44 | 60 | 07.93-04.99 | * |
| 1.6 (AEK) | | Gasolina | FWD | 1595 | 74 | 101 | 07.94-04.99 | * |
| 1.6 (AFT) | | Gasolina | FWD | 1595 | 74 | 101 | 07.94-04.99 | * |
| 1.6 (AKS) | | Gasolina | FWD | 1595 | 74 | 101 | 07.94-04.99 | * |
| 1.8 (AAM) | | Gasolina | FWD | 1781 | 55 | 75 | 07.93-04.99 | * |

LISTA DE APLICACIONES - BUYERS GUIDE

| | | | | | | | | |
|---|--|----------|-----|------|---|-----|-------------|---|
| 1.8 (ANN) | | Gasolina | FWD | 1781 | 55 | 75 | 07.93-04.99 | * |
| 1.8 (ABS) | | Gasolina | FWD | 1781 | 66 | 90 | 07.93-04.99 | * |
| 1.8 (ADZ) | | Gasolina | FWD | 1781 | 66 | 90 | 07.93-04.99 | * |
| 1.8 (ANP) | | Gasolina | FWD | 1781 | 66 | 90 | 07.93-04.99 | * |
| 2.0 (AEP) | | Gasolina | FWD | 1984 | 79 | 107 | 08.95-04.96 | * |
| 2.0 (2E) | | Gasolina | FWD | 1984 | 85 | 115 | 07.93-04.99 | * |
| 2.0 (ADY) | | Gasolina | FWD | 1984 | 85 | 115 | 07.93-04.99 | * |
| 2.0 (AGG) | | Gasolina | FWD | 1984 | 85 | 115 | 07.93-04.99 | * |
| 2.0 (AKR) | | Gasolina | FWD | 1984 | 85 | 115 | 07.93-04.99 | * |
| 2.0 Syncro (AGG) | | Gasolina | 4WD | 1984 | 85 | 115 | 08.95-04.99 | * |
| 1.9 SDI (AEY) | | Diesel | FWD | 1896 | 47 | 64 | 07.95-04.99 | * |
| 1.9 TD (AAZ) | | Diesel | FWD | 1896 | 55 | 75 | 07.93-04.99 | * |
| 1.9 TDI (1Z) | | Diesel | FWD | 1896 | 66 | 90 | 03.94-04.99 | * |
| 1.9 TDI (AHU) | | Diesel | FWD | 1896 | 66 | 90 | 03.94-04.99 | * |
| 1.9 TDI (ALE) | | Diesel | FWD | 1896 | 66 | 90 | 03.94-04.99 | * |
| 1.9 TDI (AFN) | | Diesel | FWD | 1896 | 81 | 110 | 04.96-04.99 | * |
| GOLF IV / CABRIO IV (1E7) 06.98-12.02 | | | | | Cabrio (Compact car-C Segment) | | | |
| 1.6 (AFT) | | Gasolina | FWD | 1595 | 74 | 100 | 06.98-06.02 | * |
| 1.6 (AKS) | | Gasolina | FWD | 1595 | 74 | 100 | 06.98-06.02 | * |
| 1.8 (AAM) | | Gasolina | FWD | 1781 | 55 | 75 | 06.98-06.02 | * |
| 1.8 (ANN) | | Gasolina | FWD | 1781 | 55 | 75 | 06.98-06.02 | * |
| 2.0 (ABA) | | Gasolina | FWD | 1984 | 85 | 115 | 06.98-06.02 | * |
| 2.0 (AGG) | | Gasolina | FWD | 1984 | 85 | 115 | 06.98-06.02 | * |
| 2.0 (AKR) | | Gasolina | FWD | 1984 | 85 | 115 | 06.98-06.02 | * |
| 2.0 (ATU) | | Gasolina | FWD | 1984 | 85 | 115 | 06.98-06.02 | * |
| 2.0 (AWF) | | Gasolina | FWD | 1984 | 85 | 115 | 06.98-06.02 | * |
| 2.0 (AWG) | | Gasolina | FWD | 1984 | 85 | 115 | 06.98-06.02 | * |
| 1.9 TDI (AHU) | | Diesel | FWD | 1896 | 66 | 90 | 06.98-06.02 | * |
| 1.9 TDI (ALE) | | Diesel | FWD | 1896 | 66 | 90 | 06.98-06.02 | * |
| 1.9 TDI (AFN) | | Diesel | FWD | 1896 | 81 | 110 | 06.98-06.02 | * |
| 1.9 TDI (AVG) | | Diesel | FWD | 1896 | 81 | 110 | 06.98-06.02 | * |
| JETTA II (19E, 1G2, 165) 08.83-12.92 | | | | | Sedán (Compact car-C Segment) | | | |
| 1.8 16V (PL) | | Gasolina | FWD | 1781 | 95 | 129 | 08.86-10.91 | * |
| 1.8 16V (KR) | | Gasolina | FWD | 1781 | 102 | 140 | 06.87-12.89 | * |
| LUPO (6X1, 6E1) 09.98-07.05 | | | | | [CAMBIADO]:Fastback (City car-A Segment) | | | |
| 1.4 FSI (ARR) | | Gasolina | FWD | 1390 | 77 | 105 | 02.01-07.05 | * |
| PASSAT B2 / CARAT / CORSAR / QUANTUM / SANTANA (32B) 09.79-07.89 | | | | | [CAMBIADO]:Fastback (Large family car-D Segment) | | | |
| 2.2 (KV) | | Gasolina | FWD | 2226 | 100 | 136 | 01.85-03.88 | * |
| PASSAT B2 Variant / CARAT / CORSAR / QUANTUM (33B) 08.80-06.89 | | | | | [CAMBIADO]:Break (Large family car-D Segment) | | | |
| 1.8 Syncro (DS) | | Gasolina | 4WD | 1781 | 66 | 90 | 01.86-03.88 | * |
| 1.8 Syncro (JN) | | Gasolina | 4WD | 1781 | 66 | 90 | 01.86-03.88 | * |
| 2.0 Syncro (JS) | | Gasolina | 4WD | 1994 | 85 | 116 | 05.84-03.88 | * |
| 2.2 Syncro (JT) | | Gasolina | 4WD | 2226 | 88 | 120 | 08.85-03.88 | * |
| 2.2 Syncro (KX) | | Gasolina | 4WD | 2226 | 88 | 120 | 08.85-03.88 | * |
| 2.2 (KV) | | Gasolina | FWD | 2226 | 100 | 136 | 01.85-03.88 | * |
| 2.2 Syncro (HY) | | Gasolina | 4WD | 2226 | 100 | 136 | 08.84-07.88 | * |
| PASSAT B3/B4 (315, 3A5) 08.88-12.96 | | | | | [CAMBIADO]:Furgón/Break (Large family car-D Segment) | | | |
| 2.0 (2E) | | Gasolina | FWD | 1984 | 85 | 116 | 08.91-12.95 | * |

LISTA DE APLICACIONES - BUYERS GUIDE

| | | | | | | | |
|--|----------|-----|------|--|-----|-------------|---|
| 2.0 Syncro (2E) | Gasolina | 4WD | 1984 | 85 | 116 | 09.89-10.93 | * |
| PASSAT B3/B4 (3A2, 35I) 02.88-12.97 | | | | Sedán (Large family car-D Segment) | | | |
| 1.6 (AEK) | Gasolina | FWD | 1595 | 74 | 101 | 10.94-08.96 | * |
| 1.6 (AFT) | Gasolina | FWD | 1595 | 74 | 101 | 10.94-08.96 | * |
| 1.8 (PF) | Gasolina | FWD | 1781 | 79 | 107 | 04.88-07.93 | * |
| 1.8 (PB) | Gasolina | FWD | 1781 | 82 | 112 | 04.88-07.92 | * |
| 1.8 16V (KR) | Gasolina | FWD | 1781 | 100 | 136 | 04.88-12.89 | * |
| 1.8 GL (KR) | Gasolina | FWD | 1781 | 102 | 139 | 08.91-09.93 | * |
| 2.0 (AEP) | Gasolina | FWD | 1984 | 79 | 107 | 03.95-08.96 | * |
| 2.0 (2E) | Gasolina | FWD | 1984 | 85 | 115 | 02.90-08.96 | * |
| 2.0 (ABA) | Gasolina | FWD | 1984 | 85 | 115 | 02.90-08.96 | * |
| 2.0 (ADY) | Gasolina | FWD | 1984 | 85 | 115 | 02.90-08.96 | * |
| 2.0 (AGG) | Gasolina | FWD | 1984 | 85 | 115 | 02.90-08.96 | * |
| 2.0 16V (9A) | Gasolina | FWD | 1984 | 100 | 136 | 08.88-09.93 | * |
| 1.9 TDI (1Z) | Diesel | FWD | 1896 | 66 | 90 | 10.93-08.96 | * |
| 1.9 TDI (AHU) | Diesel | FWD | 1896 | 66 | 90 | 10.93-08.96 | * |
| PASSAT B3/B4 Variant (3A5, 35I) 02.88-06.97 | | | | [CAMBIADO]:Break (Large family car-D Segment) | | | |
| 1.8 (PF) | Gasolina | FWD | 1781 | 79 | 107 | 04.88-07.90 | * |
| 1.8 (PB) | Gasolina | FWD | 1781 | 82 | 112 | 04.88-07.92 | * |
| 1.8 16V (KR) | Gasolina | FWD | 1781 | 100 | 136 | 04.88-12.89 | * |
| 1.8 (KR) | Gasolina | FWD | 1781 | 102 | 139 | 08.91-09.93 | * |
| 2.0 (AEP) | Gasolina | FWD | 1984 | 79 | 107 | 03.95-08.96 | * |
| 2.0 (2E) | Gasolina | FWD | 1984 | 85 | 115 | 02.90-05.97 | * |
| 2.0 (ADY) | Gasolina | FWD | 1984 | 85 | 115 | 02.90-05.97 | * |
| 2.0 (AGG) | Gasolina | FWD | 1984 | 85 | 115 | 02.90-05.97 | * |
| 2.0 (2E) | Gasolina | FWD | 1984 | 85 | 116 | 10.93-10.96 | * |
| 2.0 (ADY) | Gasolina | FWD | 1984 | 85 | 116 | 10.93-10.96 | * |
| 2.0 (AGG) | Gasolina | FWD | 1984 | 85 | 116 | 10.93-10.96 | * |
| 2.0 16V (9A) | Gasolina | FWD | 1984 | 100 | 136 | 08.88-09.93 | * |
| 1.9 TDI (1Z) | Diesel | FWD | 1896 | 66 | 90 | 10.93-05.97 | * |
| 1.9 TDI (AHU) | Diesel | FWD | 1896 | 66 | 90 | 10.93-05.97 | * |
| POLO III (6N1) 10.94-10.99 | | | | [CAMBIADO]:Fastback (Supermini car-B Segment) | | | |
| 1.4 16V (AHW) | Gasolina | FWD | 1390 | 55 | 75 | 10.99-09.01 | * |
| 1.4 16V (APE) | Gasolina | FWD | 1390 | 55 | 75 | 10.99-09.01 | * |
| 1.4 16V (AUA) | Gasolina | FWD | 1390 | 55 | 75 | 10.99-09.01 | * |
| 1.4 16V (AFK) | Gasolina | FWD | 1390 | 74 | 101 | 10.99-09.01 | * |
| 1.4 16V (AQQ) | Gasolina | FWD | 1390 | 74 | 101 | 10.99-09.01 | * |
| 1.4 16V (AUB) | Gasolina | FWD | 1390 | 74 | 101 | 10.99-09.01 | * |
| 100 1.4 16V (AFH) | Gasolina | FWD | 1390 | 74 | 100 | 04.96-10.99 | * |
| 1.4 TDI (AMF) | Diesel | FWD | 1422 | 55 | 75 | 10.99-09.01 | * |
| 1.4 TDI | Diesel | FWD | 1422 | 66 | 90 | 01.00-10.00 | * |
| POLO III CLASSIC / DERBY / FLIGHT (6V2) 01.95-11.09 | | | | Sedán (Supermini car-B Segment) | | | |
| 54 1.4 (ANX) | Gasolina | FWD | 1390 | 40 | 54 | 01.98-08.99 | * |
| 1.4 | Gasolina | FWD | 1390 | 62 | 84 | 05.96-07.02 | * |
| 75 1.6 (1F) | Gasolina | FWD | 1595 | 55 | 75 | 11.95-09.97 | * |
| 1.6 | Gasolina | FWD | 1595 | 65 | 88 | 05.96-09.01 | * |
| 100 1.6 (AEH) | Gasolina | FWD | 1595 | 74 | 100 | 12.95-09.01 | * |
| 100 1.6 (AFT) | Gasolina | FWD | 1595 | 74 | 100 | 12.95-09.01 | * |
| 100 1.6 (AKL) | Gasolina | FWD | 1595 | 74 | 100 | 12.95-09.01 | * |

LISTA DE APLICACIONES - BUYERS GUIDE

| | | | | | | | | |
|--|--|----------|-----|------|--|-----|-------------|---|
| 100 1.6 (APF) | | Gasolina | FWD | 1595 | 74 | 100 | 12.95-09.01 | * |
| 100 1.6 (AUR) | | Gasolina | FWD | 1595 | 74 | 100 | 12.95-09.01 | * |
| 75 1.6 (AEE) | | Gasolina | FWD | 1598 | 55 | 75 | 11.95-09.01 | * |
| 75 1.6 (ALM) | | Gasolina | FWD | 1598 | 55 | 75 | 11.95-09.01 | * |
| 90 1.8 (ABS) | | Gasolina | FWD | 1781 | 66 | 90 | 01.97-09.01 | * |
| 90 1.8 (ADD) | | Gasolina | FWD | 1781 | 66 | 90 | 01.97-09.01 | * |
| 90 1.8 (ADZ) | | Gasolina | FWD | 1781 | 66 | 90 | 01.97-09.01 | * |
| 2.0 (ADC) | | Gasolina | FWD | 1984 | 85 | 116 | 08.99-09.01 | * |
| 110 1.9 TDI (AFN) | | Diesel | FWD | 1896 | 81 | 110 | 06.98-01.02 | * |
| 110 1.9 TDI (ASV) | | Diesel | FWD | 1896 | 81 | 110 | 06.98-01.02 | * |
| POLO III Variant (6V5) 04.97-09.01 | | | | | [CAMBIADO]:Break (Supermini car-B Segment) | | | |
| 1.6 (AEH) | | Gasolina | FWD | 1595 | 74 | 101 | 05.97-09.01 | * |
| 1.6 (AFT) | | Gasolina | FWD | 1595 | 74 | 101 | 05.97-09.01 | * |
| 1.6 (AKL) | | Gasolina | FWD | 1595 | 74 | 101 | 05.97-09.01 | * |
| 1.6 (APF) | | Gasolina | FWD | 1595 | 74 | 101 | 05.97-09.01 | * |
| 1.6 (AUR) | | Gasolina | FWD | 1595 | 74 | 101 | 05.97-09.01 | * |
| 1.6 (AEE) | | Gasolina | FWD | 1598 | 55 | 75 | 05.97-09.01 | * |
| 1.6 (ALM) | | Gasolina | FWD | 1598 | 55 | 75 | 05.97-09.01 | * |
| 1.8 (ADZ) | | Gasolina | FWD | 1781 | 66 | 90 | 05.97-09.01 | * |
| 1.9 TDI (AFN) | | Diesel | FWD | 1896 | 81 | 110 | 06.98-09.01 | * |
| 1.9 TDI (ASV) | | Diesel | FWD | 1896 | 81 | 110 | 06.98-09.01 | * |
| QUANTUM II Variant 04.85-08.94 | | | | | [CAMBIADO]:Break (Large family car-D Segment) | | | |
| 2.0 | | Gasolina | FWD | 1984 | 76 | 103 | 08.89-07.90 | * |
| QUANTUM IV Variant 08.90-07.05 | | | | | [CAMBIADO]:Break (Large family car-D Segment) | | | |
| 2.0 | | Gasolina | FWD | 1984 | 76 | 103 | 08.90-07.95 | * |
| 2.0 | | Gasolina | FWD | 1984 | 82 | 111 | 08.90-07.05 | * |
| SANTANA III 01.91-09.12 | | | | | Sedán (Large family car-D Segment) | | | |
| 1.8 (UDB) | | Gasolina | FWD | 1781 | 71 | 97 | 02.93-09.06 | * |
| SCIROCCO II (53B) 08.80-07.92 | | | | | Coupé (Sport compact car-C Segment) | | | |
| 1.8 16V (PL) | | Gasolina | FWD | 1781 | 95 | 129 | 03.86-07.92 | * |
| 1.8 16V (KR) | | Gasolina | FWD | 1781 | 102 | 139 | 10.85-07.89 | * |
| VENTO / JETTA III (1H2) 11.91-11.00 | | | | | Sedán (Compact car-C Segment) | | | |
| 1.6 (AEK) | | Gasolina | FWD | 1595 | 74 | 101 | 10.94-09.98 | * |
| 1.6 (AFT) | | Gasolina | FWD | 1595 | 74 | 101 | 10.94-09.98 | * |
| 1.6 (ABU) | | Gasolina | FWD | 1598 | 55 | 75 | 09.92-09.98 | * |
| 1.6 (AEA) | | Gasolina | FWD | 1598 | 55 | 75 | 09.92-09.98 | * |
| 1.6 (AEE) | | Gasolina | FWD | 1598 | 55 | 75 | 09.92-09.98 | * |
| 1.8 (ABS) | | Gasolina | FWD | 1781 | 66 | 90 | 11.91-09.98 | * |
| 1.8 (ACC) | | Gasolina | FWD | 1781 | 66 | 90 | 11.91-09.98 | * |
| 1.8 (ADD) | | Gasolina | FWD | 1781 | 66 | 90 | 11.91-09.98 | * |
| 1.8 (ADZ) | | Gasolina | FWD | 1781 | 66 | 90 | 11.91-09.98 | * |
| 2.0 GL | | Gasolina | FWD | 1968 | 62 | 84 | 11.91-07.98 | * |
| 2.0 GL (AEP) | | Gasolina | FWD | 1984 | 79 | 107 | 05.96-12.97 | * |
| 2.0 (2E) | | Gasolina | FWD | 1984 | 85 | 115 | 11.91-09.98 | * |
| 2.0 (ABA) | | Gasolina | FWD | 1984 | 85 | 115 | 11.91-09.98 | * |
| 2.0 (ADY) | | Gasolina | FWD | 1984 | 85 | 115 | 11.91-09.98 | * |
| 2.0 (AGG) | | Gasolina | FWD | 1984 | 85 | 115 | 11.91-09.98 | * |
| 2.0 (AKR) | | Gasolina | FWD | 1984 | 85 | 115 | 11.91-09.98 | * |

LISTA DE APLICACIONES - BUYERS GUIDE

| | | | | | | | |
|---------------|--------|-----|------|----|-----|-------------|---|
| 1.9 D (1Y) | Diesel | FWD | 1896 | 48 | 65 | 11.91-09.98 | * |
| 1.9 TDI (1Z) | Diesel | FWD | 1896 | 66 | 90 | 09.93-09.98 | * |
| 1.9 TDI (AHU) | Diesel | FWD | 1896 | 66 | 90 | 09.93-09.98 | * |
| 1.9 TDI (ALE) | Diesel | FWD | 1896 | 66 | 90 | 09.93-09.98 | * |
| 1.9 TDI (AFN) | Diesel | FWD | 1896 | 81 | 110 | 04.96-09.98 | * |