

# LISTA DE APLICACIONES - BUYERS GUIDE

## 78RBD23406



Weight: 12.856

O.E.M.	MAKE
34 21 6 764 651	BMW
34 21 6 855 007	BMW
6764651	BMW
6855007	BMW

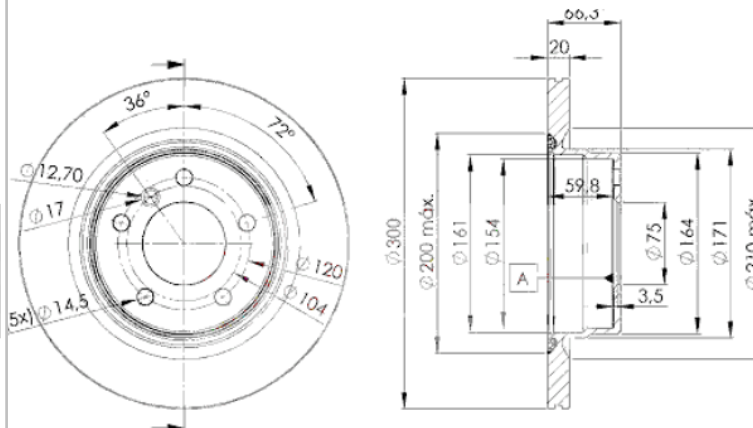

## 78RBD23406

(E1) 90R-02C0656/0123



Ø300x20x66

Sin Filas



Trac.	CC	Kw	CV
-------	----	----	----



Front / Rear

### BMW

#### 1 Serie (E87) 02.03-01.13

[CAMBIADO]:Fastback (Compact car-C Segment)

116 i (N45 B16 A)	Gasolina	RWD	1596	85	115	06.04-06.11	*
116 i (N43 B16 AA)	Gasolina	RWD	1599	90	122	09.07-06.11	*
116 i (N43 B20 A)	Gasolina	RWD	1995	90	122	01.09-06.11	*
120 i (N46 B20 B)	Gasolina	RWD	1995	110	150	06.04-02.07	*
120 i (N46 B20 BD)	Gasolina	RWD	1995	110	150	06.04-02.07	*
120 i (N46 B20 C)	Gasolina	RWD	1995	110	150	06.04-02.07	*
120 i (N46 B20 CC)	Gasolina	RWD	1995	110	150	06.04-02.07	*
120 i (N46 B20 A)	Gasolina	RWD	1995	115	156	03.07-06.11	*
120 i (N46 B20 B)	Gasolina	RWD	1995	115	156	03.07-06.11	*
120 i (N46 B20 BD)	Gasolina	RWD	1995	115	156	03.07-06.11	*
120 i (N46 B20 C)	Gasolina	RWD	1995	115	156	03.07-06.11	*
120 i (N46 B20 CC)	Gasolina	RWD	1995	115	156	03.07-06.11	*
120 i (N43 B20 A)	Gasolina	RWD	1995	120	163	03.07-06.11	*
118 i (N43 B20 A)	Gasolina	RWD	1995	125	170	03.07-12.07	*
120 i (N43 B20 A)	Gasolina	RWD	1995	125	170	03.07-06.11	*
130 i (N52 B30 A)	Gasolina	RWD	2996	195	265	09.06-12.11	*
130 i (N52 B30 B)	Gasolina	RWD	2996	195	265	09.06-12.11	*
130 i (N52 B30 BF)	Gasolina	RWD	2996	195	265	09.06-12.11	*
116 d (N47 D20 C)	Diesel	RWD	1995	66	90	01.11-12.11	*
116 d (N47 D20 A)	Diesel	RWD	1995	85	116	03.09-06.11	*
116 d (N47 D20 C)	Diesel	RWD	1995	85	116	03.09-06.11	*
118 d (N47 D20 A)	Diesel	RWD	1995	100	136	03.07-06.11	*
118 d (N47 D20 C)	Diesel	RWD	1995	100	136	03.07-06.11	*

# LISTA DE APLICACIONES - BUYERS GUIDE

118 d (N47 D20 A)		Diesel	RWD	1995	100	136	09.06-12.11	*
118 d (N47 D20 C)		Diesel	RWD	1995	100	136	09.06-12.11	*
118 d (N47 D20 A)		Diesel	RWD	1995	105	143	03.07-06.11	*
118 d (N47 D20 C)		Diesel	RWD	1995	105	143	03.07-06.11	*
118 d (N47 D20 A)		Diesel	RWD	1995	105	143	09.06-12.11	*
118 d (N47 D20 C)		Diesel	RWD	1995	105	143	09.06-12.11	*
120 d (M47 D20 (204D4))		Diesel	RWD	1995	110	150	06.04-02.07	*
120 d (M47 D20 (204D4))		Diesel	RWD	1995	115	156	05.06-02.07	*
120 d (M47 D20 (204D4))		Diesel	RWD	1995	120	163	06.04-06.11	*
120 d (N47 D20 A)		Diesel	RWD	1995	120	163	06.04-06.11	*
120 d (N47 D20 A)		Diesel	RWD	1995	120	163	03.07-12.11	*
120 d (N47 D20 C)		Diesel	RWD	1995	120	163	03.07-12.11	*
120 d (N47 D20 A)		Diesel	RWD	1995	125	170	03.07-10.10	*
120 d (N47 D20 A)		Diesel	RWD	1995	130	177	03.07-06.11	*
120 d (N47 D20 C)		Diesel	RWD	1995	130	177	03.07-06.11	*
120 d (N47 D20 A)		Diesel	RWD	1995	130	177	03.07-12.11	*
120 d (N47 D20 C)		Diesel	RWD	1995	130	177	03.07-12.11	*
120 d (N47 D20 A)		Diesel	RWD	1995	145	197	03.07-12.11	*
120 d (N47 D20 C)		Diesel	RWD	1995	145	197	03.07-12.11	*
123 d (N47 D20 B)		Diesel	RWD	1995	150	204	03.07-12.11	*
123 d (N47 D20 D)		Diesel	RWD	1995	150	204	03.07-12.11	*
<b>1 Serie (E88) 12.07-12.13</b>					<b>Cabrio (Compact car-C Segment)</b>			
118 i (N43 B20 A)		Gasolina	RWD	1995	105	143	03.08-10.13	*
120 i (N43 B20 A)		Gasolina	RWD	1995	125	170	12.07-10.13	*
125 i (N52 B30 A)		Gasolina	RWD	2996	160	218	12.07-10.13	*
125 i (N52 B30 B)		Gasolina	RWD	2996	160	218	12.07-10.13	*
125 i (N52 B30 BF)		Gasolina	RWD	2996	160	218	12.07-10.13	*
120 d (N47 D20 A)		Diesel	RWD	1995	130	177	03.08-12.13	*
120 d (N47 D20 C)		Diesel	RWD	1995	130	177	03.08-12.13	*
120 d (N47 D20 C)		Diesel	RWD	1995	145	197	03.08-12.13	*
<b>1 Serie (E82) 10.06-10.13</b>					<b>Coupé (Compact car-C Segment)</b>			
125 i (N52 B30 A)		Gasolina	RWD	2996	160	218	03.08-10.13	*
125 i (N52 B30 B)		Gasolina	RWD	2996	160	218	03.08-10.13	*
125 i (N52 B30 BF)		Gasolina	RWD	2996	160	218	03.08-10.13	*
128 i (N51 B30 A,N52 B30 A)		Gasolina	RWD	2996	172	234	10.07-10.13	*
120 d (N47 D20 A)		Diesel	RWD	1995	130	177	09.07-10.13	*
120 d (N47 D20 C)		Diesel	RWD	1995	130	177	09.07-10.13	*
120 d (N47 D20 A)		Diesel	RWD	1995	145	197	09.07-10.13	*
120 d (N47 D20 C)		Diesel	RWD	1995	145	197	09.07-10.13	*
123 d (N47 D20 B)		Diesel	RWD	1995	150	204	10.07-09.13	*
123 d (N47 D20 D)		Diesel	RWD	1995	150	204	10.07-09.13	*
<b>3 Serie V (E93) 05.06-12.13</b>					<b>Cabrio (Compact executive car-D Segment)</b>			
318i (N43 B20 A)		Gasolina	RWD	1995	105	143	03.10-12.13	*
320i (N46 B20 B)		Gasolina	RWD	1995	115	156	01.07-08.13	*
320i (N43 B20 A)		Gasolina	RWD	1995	120	163	09.06-10.13	*
320i (N43 B20 A)		Gasolina	RWD	1995	125	170	03.07-10.13	*
320 d (N47 D20 A)		Diesel	RWD	1995	130	177	03.08-02.10	*
320 d (N47 D20 C)		Diesel	RWD	1995	130	177	03.08-02.10	*

# LISTA DE APLICACIONES - BUYERS GUIDE

3 Serie V (E92) 01.05-12.13					Coupé (Compact executive car-D Segment)			
320i		Gasolina	FWD	1955	112	152	01.10-	*
318i (N43 B20 A)		Gasolina	RWD	1995	105	143	03.10-12.13	*
320i		Gasolina	RWD	1995	110	150	11.06-06.07	*
320i (N46 B20 B)		Gasolina	RWD	1995	115	156	06.07-12.13	*
320i (N43 B20 A)		Gasolina	RWD	1995	120	163	01.07-06.13	*
320i (N43 B20 A)		Gasolina	RWD	1995	125	170	03.07-06.13	*
323 i		Gasolina	FWD	2497	130	177	04.06-02.12	*
323 i (N52 B25 AE)		Gasolina	RWD	2497	140	190	04.06-02.12	*
323 i (N52 B25 BE)		Gasolina	RWD	2497	140	190	04.06-02.12	*
325i (N52 B25 A)		Gasolina	RWD	2497	150	204	03.10-10.13	*
325i (N52 B25 AF)		Gasolina	RWD	2497	150	204	03.10-10.13	*
325i (N52 B25 BF)		Gasolina	RWD	2497	150	204	03.10-10.13	*
325i (N52 B25 A)		Gasolina	RWD	2497	155	211	03.10-06.13	*
325i (N52 B25 AF)		Gasolina	RWD	2497	155	211	03.10-06.13	*
325i (N52 B25 BF)		Gasolina	RWD	2497	155	211	03.10-06.13	*
325i (N52 B25 A)		Gasolina	RWD	2497	160	218	06.06-02.10	*
325i (N52 B25 AF)		Gasolina	RWD	2497	160	218	06.06-02.10	*
325i (N52 B25 BF)		Gasolina	RWD	2497	160	218	06.06-02.10	*
325i (N53 B30 A)		Gasolina	RWD	2996	155	211	03.10-06.13	*
325i (N53 B30 A)		Gasolina	RWD	2996	160	218	09.07-06.13	*
328i (N51 B30 A)		Gasolina	RWD	2996	171	233	09.06-12.10	*
328i (N51 B30 A)		Gasolina	RWD	2996	172	234	06.06-06.13	*
328i (N52 B30 A)		Gasolina	RWD	2996	172	234	06.06-06.13	*
320 d (N47 D20 A)		Diesel	RWD	1995	120	163	03.07-06.13	*
320 d (N47 D20 C)		Diesel	RWD	1995	120	163	03.07-06.13	*
320 d (N47 D20 A)		Diesel	RWD	1995	130	177	09.06-02.10	*
320 d (N47 D20 C)		Diesel	RWD	1995	130	177	09.06-02.10	*
320 d (N47 D20 C)		Diesel	RWD	1995	135	184	03.10-06.13	*
320 d (N47 D20 A)		Diesel	RWD	1995	145	197	09.06-02.10	*
320 d (N47 D20 C)		Diesel	RWD	1995	145	197	09.06-02.10	*
320 d (N47 D20 C)		Diesel	RWD	1995	147	200	03.10-06.13	*
3 Serie V (E90) 02.04-02.12					Sedán (Compact executive car-D Segment)			
318i (N46 B20 B)		Gasolina	RWD	1995	95	129	09.05-08.07	*
318i (N46 B20 B)		Gasolina	RWD	1995	100	136	09.07-10.11	*
318i (N46 B20 C)		Gasolina	RWD	1995	100	136	09.07-10.11	*
318i (N46 B20 CC)		Gasolina	RWD	1995	100	136	09.07-10.11	*
318i (N46 B20 CD)		Gasolina	RWD	1995	100	136	09.07-10.11	*
318i (N46 B20 E)		Gasolina	RWD	1995	100	136	09.07-10.11	*
318i (N43 B20 A)		Gasolina	RWD	1995	105	143	09.07-10.11	*
320i (N46 B20 B)		Gasolina	RWD	1995	110	150	12.04-08.07	*
320i (N46 B20 BD)		Gasolina	RWD	1995	110	150	12.04-08.07	*
320i (N46 B20 C)		Gasolina	RWD	1995	110	150	12.04-08.07	*
320i (N46 B20 CB)		Gasolina	RWD	1995	110	150	12.04-08.07	*
320i (N46 B20 B)		Gasolina	RWD	1995	115	156	02.07-12.11	*
320i (N46 B20 C)		Gasolina	RWD	1995	115	156	02.07-12.11	*
320i (N46 B20 CC)		Gasolina	RWD	1995	115	156	02.07-12.11	*
320i (N46 B20 CD)		Gasolina	RWD	1995	115	156	02.07-12.11	*
320i (N46 B20 E)		Gasolina	RWD	1995	115	156	02.07-12.11	*
320i (N43 B20 A)		Gasolina	RWD	1995	120	163	03.07-12.11	*

# LISTA DE APLICACIONES - BUYERS GUIDE

320i (N43 B20 A)	Gasolina	RWD	1995	125	170	09.07-10.11	*
325i	Gasolina	FWD	2494	141	189	09.07-12.08	*
325i	Gasolina	FWD	2494	224	300	09.08-12.10	*
323 i (N52 B25 A)	Gasolina	RWD	2497	130	177	09.05-02.07	*
323 i (N52 B25 B)	Gasolina	RWD	2497	130	177	09.05-02.07	*
323 i (N52 B25 BE)	Gasolina	RWD	2497	130	177	09.05-02.07	*
323 i (N52 B25 BF)	Gasolina	RWD	2497	130	177	09.05-02.07	*
323 i (N52 B25 A)	Gasolina	RWD	2497	140	190	03.07-12.11	*
323 i (N52 B25 BF)	Gasolina	RWD	2497	140	190	03.07-12.11	*
325i (N52 B25 A)	Gasolina	RWD	2497	155	211	01.06-12.11	*
325i (N52 B25 A)	Gasolina	RWD	2497	160	218	12.04-12.11	*
325i (N52 B25 B)	Gasolina	RWD	2497	160	218	12.04-12.11	*
325i (N52 B25 BF)	Gasolina	RWD	2497	160	218	12.04-12.11	*
325 xi (N52 B25 A)	Gasolina	4WD	2497	160	218	09.05-08.08	*
325i (N52 B25)	Gasolina	RWD	2497	163	222	09.08-12.09	*
325i (N53 B30 A)	Gasolina	RWD	2996	155	211	03.07-12.11	*
325i (N53 B30 A)	Gasolina	RWD	2996	160	218	03.07-12.11	*
325 xi (N53 B30 A)	Gasolina	4WD	2996	160	218	09.07-08.08	*
328i (N51 B30 A)	Gasolina	RWD	2996	172	234	09.06-12.11	*
318 d (M47 D20 (204D4))	Diesel	RWD	1995	90	122	03.05-08.07	*
318 d (N47 D20 A)	Diesel	RWD	1995	100	136	09.07-10.11	*
318 d (N47 D20 C)	Diesel	RWD	1995	100	136	09.07-10.11	*
318 d (N47 D20 A)	Diesel	RWD	1995	105	143	02.07-10.11	*
318 d (N47 D20 C)	Diesel	RWD	1995	105	143	02.07-10.11	*
320 d (M47 D20 (204D4))	Diesel	RWD	1995	110	150	12.04-09.07	*
320 d	Diesel	RWD	1995	115	156	12.04-09.07	*
320 d (M47 D20 (204D4))	Diesel	RWD	1995	120	163	12.04-10.11	*
320 d (N47 D20 A)	Diesel	RWD	1995	120	163	12.04-10.11	*
320 d (N47 D20 C)	Diesel	RWD	1995	120	163	12.04-10.11	*
320 d (N47 D20 C)	Diesel	RWD	1995	125	170	01.07-12.09	*
320 d (N47 D20 A)	Diesel	RWD	1995	130	177	09.07-02.10	*
320 d (N47 D20 C)	Diesel	RWD	1995	130	177	09.07-02.10	*
320 d (N47 D20 C)	Diesel	RWD	1995	135	184	03.10-10.11	*
<b>3 Serie V Touring (E91) 12.04-12.12</b>					<b>[CAMBIADO]:Break (Compact executive car-D Segment)</b>		
316 i (N43 B16 AA)	Gasolina	RWD	1599	90	122	09.08-06.12	*
318i (N46 B20 B)	Gasolina	RWD	1995	100	136	09.07-03.12	*
318i (N43 B20 A)	Gasolina	RWD	1995	105	143	05.07-05.12	*
320i (N46 B20 B)	Gasolina	RWD	1995	110	150	09.05-06.12	*
320i (N46 B20 C)	Gasolina	RWD	1995	110	150	09.05-06.12	*
320i (N43 B20 A)	Gasolina	RWD	1995	125	170	02.07-12.12	*
325i (N52 B25 A)	Gasolina	RWD	2497	160	218	12.04-08.08	*
325 xi (N52 B25 A)	Gasolina	4WD	2497	160	218	08.05-08.08	*
325i (N53 B30 A)	Gasolina	RWD	2996	155	211	09.07-06.12	*
325i (N53 B30 A)	Gasolina	RWD	2996	160	218	09.07-06.12	*
325 xi (N53 B30 A)	Gasolina	4WD	2996	160	218	09.07-08.08	*
316 d (N47 D20 C)	Diesel	RWD	1995	85	116	09.09-06.12	*
318 d (N47 D20 A)	Diesel	RWD	1995	100	136	07.07-06.12	*
318 d (N47 D20 C)	Diesel	RWD	1995	100	136	07.07-06.12	*
318 d (N47 D20 A)	Diesel	RWD	1995	105	143	09.07-06.12	*
318 d (N47 D20 C)	Diesel	RWD	1995	105	143	09.07-06.12	*
320 d (M47 D20 (204D4))	Diesel	RWD	1995	120	163	06.05-06.12	*

# LISTA DE APLICACIONES - BUYERS GUIDE

320 d (N47 D20 A)	Diesel	RWD	1995	120	163	06.05-06.12	*
320 d (N47 D20 C)	Diesel	RWD	1995	120	163	06.05-06.12	*
320 d (N47 D20 A)	Diesel	RWD	1995	130	177	02.07-12.10	*
320 d (N47 D20 C)	Diesel	RWD	1995	130	177	02.07-12.10	*
320 d (N47 D20 C)	Diesel	RWD	1995	135	184	03.10-05.12	*
320 d (N47 D20 C)	Diesel	RWD	1995	147	200	03.10-05.12	*
<b>BMW (BRILLIANCE)</b>							
<b>3 SERIES V (E90) 10.04-09.12</b>				<b>Sedán (Compact executive car-D Segment)</b>			
318i	Gasolina	FWD	1995	100	136	01.09-09.12	*
320i	Gasolina	FWD	1995	112	152	01.10-09.12	*
320i	Gasolina	FWD	1995	115	156	12.07-12.08	*
325i (N52 B25 BF)	Gasolina	RWD	2497	160	218	06.05-09.12	*