

# LISTA DE APLICACIONES - BUYERS GUIDE

## 78RBD22040



8 424073 151889

Weight: 9.256

O.E.M.	MAKE
43512-0D050	TOYOTA
43512-17130	TOYOTA
43512-52040	TOYOTA
43512-52090	TOYOTA

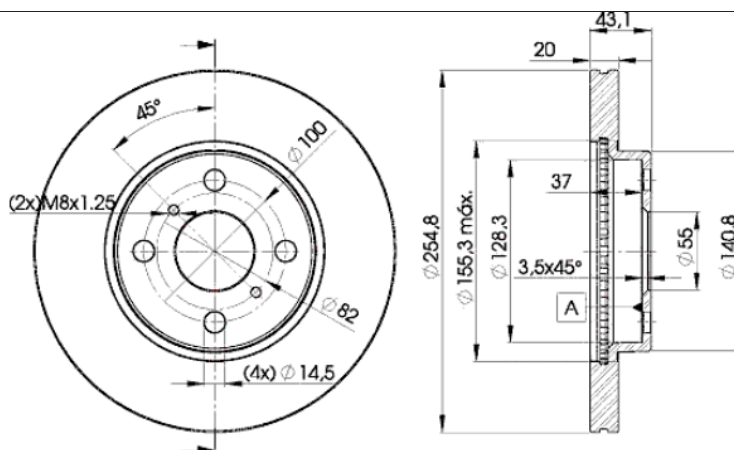

## 78RBD22040

E1 90R-02C0452/0026



Ø255x20x43.4

Sin Filas



Trac.	CC	Kw	CV	
				Front / Rear

### FAW (TIANJIN)

#### WEIZHI 01.06-

[CAMBIADO]:Fastback ()

1.3	Gasolina	FWD	1342	64	87	10.06-12.09	*
1.3	Gasolina	FWD	1342	68	92	01.07-12.10	*

#### WEIZHI V5 04.12-

Sedán ()

1.5 (CA4GA5)	Gasolina	FWD	1497	75	102	04.12-04.18	*
--------------	----------	-----	------	----	-----	-------------	---

### GEELY

#### KINGKONG 06.05-

Sedán ()

1.5 (5A-FE)	Gasolina	FWD	1498	69	93	05.06-12.10	*
1.5 (MR479QA)	Gasolina	FWD	1498	69	93	05.06-12.10	*

#### MK II 01.12-

Sedán (Compact car-C Segment)

1.5 (MR479QA)	Gasolina	FWD	1498	69	94	01.12-	*
---------------	----------	-----	------	----	----	--------	---

### GREAT WALL

#### COOLBEAR / CB150 01.08-12.13

MPV (Large MPV-M1 Segment)

1.5 (GW4G15)	Gasolina	FWD	1497	77	105	03.09-12.13	*
--------------	----------	-----	------	----	-----	-------------	---

#### FLORID 09.08-

[CAMBIADO]:Fastback ()

1.3 (GW413EF)	Gasolina	FWD	1342	65	88	09.08-12.10	*
1.3	Gasolina	FWD	1342	68	92	05.09-12.12	*
1.5 (GW4G15)	Gasolina	FWD	1497	77	105	02.09-12.12	*

#### FLORID CROSS 08.09-12.14

[CAMBIADO]:Fastback ()

1.5	Gasolina	FWD	1497	77	105	08.09-12.14	*
-----	----------	-----	------	----	-----	-------------	---

# LISTA DE APLICACIONES - BUYERS GUIDE

HOVER M2 / HAVAL M2 03.10-					SUV (Compact SUV-J Segment)			
1.5 (GW4G15)		Gasolina	FWD	1497	73	99	01.13-	*
1.5 (GW4G15)		Gasolina	FWD	1497	77	105	03.10-12.14	*
1.5 A las 4 ruedas (GW4G15)		Gasolina	4WD	1497	77	105	03.10-12.12	*
HOVER M4 05.12-					SUV (Compact SUV-J Segment)			
1.5 (GW4G15)		Gasolina	FWD	1497	78	106	05.12-	*
PERI CROSS 03.08-01.10					[CAMBIADO]:Fastback ()			
1.3 (GW413EF)		Gasolina	FWD	1342	65	88	03.08-01.10	*
TOYOTA								
bB (NCP3_) 01.00-12.05					MPV (Compact MPV-M1 Segment)			
1.5 4WD (NCP35) (1NZ-FE)		Gasolina	4WD	1497	77	105	03.00-12.05	*
ECHO (_P1_) 08.99-01.06					Sedán (Supermini car-B Segment)			
1.5 (NCP12_) (1NZ-FE)		Gasolina	FWD	1497	81	110	08.99-12.05	*
IST / XA (NCP6_) 04.02-07.07					[CAMBIADO]:Fastback (Supermini car-B Segment)			
1.3 VVTi (NCP60) (2NZ-FE)		Gasolina	FWD	1299	63	86	05.04-07.07	*
1.5 VVTi (NCP61_, NCP61) (1NZ-FE)		Gasolina	FWD	1497	80	109	05.04-07.07	*
MR 2 III / MR (ZZW3_) 10.99-06.07					Cabrío (Sports car-S Segment)			
1.8 16V VT-i (ZZW30) (1ZZ-FE)		Gasolina	RWD	1794	103	140	10.99-06.07	*
VIOS / SOLUNA VIOS / YARIS / BELTA (_P4_) 07.02-08.13					Sedán (Supermini car-B Segment)			
1.3 VVTi (AXP41_) (8A-FE)		Gasolina	FWD	1342	64	87	07.02-01.08	*
1.5 VVTi (NCP42_) (1NZ-FE)		Gasolina	FWD	1497	68	92	10.02-10.06	*
1.5 VVTi (NCP42_, NCP42R) (1NZ-FE)		Gasolina	FWD	1497	80	109	10.02-10.06	*
1.5 (AXP42_, NCP42_) (5A-FE)		Gasolina	FWD	1498	68	92	07.02-01.08	*
Will CYPHA (NCP7_) 05.01-07.05					[CAMBIADO]:Fastback (Compact car-C Segment)			
1.3 VVTi (NCP70) (2NZ-FE)		Gasolina	FWD	1299	62	84	05.01-07.05	*
1.5 VVTi 4WD (NCP75) (1NZ-FE)		Gasolina	4WD	1497	78	106	05.01-07.05	*
Will Vi (NCP19_) 01.00-12.01					Sedán (Compact car-C Segment)			
1.3 (NCP19) (2NZ-FE)		Gasolina	FWD	1298	64	87	01.00-12.01	*
YARIS II / VITZ (_P9_) 01.05-					[CAMBIADO]:Fastback (Supermini car-B Segment)			
1.3 VVT-i (SCP90_, SCP90R) (2SZ-FE)		Gasolina	FWD	1298	64	87	08.05-11.10	*
YARIS VERSO / ECHO VERSO / FUN CARGO (_P2_) 03.00-09.05					Furgón/hatchback (Mini MPV-M1 Segment)			
1.3 VVTi (NCP22_) (2NZ-FE)		Gasolina	FWD	1299	62	84	04.03-09.05	*
1.3 VVTi (NCP22_) (2NZ-FE)		Gasolina	FWD	1299	63	86	03.00-09.05	*
1.5 VVTi (NCP21_) (1NZ-FE)		Gasolina	FWD	1497	78	106	03.00-03.03	*
1.4 D4d (NLP22_) (1ND-TV)		Diesel	FWD	1364	55	75	10.01-09.05	*
YARIS VERSO / ECHO VERSO / FUN CARGO (_P2_) 08.99-09.05					MPV (Mini MPV-M1 Segment)			
1.3 (NCP20_, NCP22_, NCP20R, NCP22R) (2NZ-FE)		Gasolina	FWD	1299	62	84	11.02-09.05	*
1.3 (NCP20_, NCP22_, NCP20R, NCP22R) (2NZ-FE)		Gasolina	FWD	1299	63	86	08.99-10.02	*
1.5 (NCP21_) (1NZ-FE)		Gasolina	FWD	1497	77	105	03.00-09.05	*
1.5 (NCP21_) (1NZ-FE)		Gasolina	FWD	1497	78	106	03.00-09.05	*
1.5 4WD (NCP25) (1NZ-FE)		Gasolina	4WD	1497	78	106	03.00-09.05	*
1.5 (NCP21)		Gasolina	FWD	1497	80	109	08.02-09.05	*
1.5 (NCP21)		Gasolina	FWD	1497	81	110	01.00-07.02	*
1.4 D-4D (NLP20_, NLP22_) (1ND-TV)		Diesel	FWD	1364	55	75	09.00-09.05	*

# LISTA DE APLICACIONES - BUYERS GUIDE

YARIS / ECHO / VITZ ( _P1_) 01.99-12.05					[CAMBIADO]:Fastback (Supermini car-B Segment)			
1.0 (SCP10_, SCP10R) (1SZ-FE)	Gasolina	FWD	998	48	65	03.03-09.05	*	
1.0 (SCP10_, SCP10R) (1SZ-FE)	Gasolina	FWD	998	50	68	04.99-09.05	*	
1.3 (SCP12_, SCP13_, SCP12R, SCP13R) (2SZ-FE)	Gasolina	FWD	1298	64	87	04.02-09.05	*	
1.3	Gasolina	FWD	1299	57	76	09.03-12.04	*	
1.3 (NCP10, SCP12_) (2NZ-FE)	Gasolina	FWD	1299	63	86	08.99-11.05	*	
1.5 (NCP13_, NCP13R) (1NZ-FE)	Gasolina	FWD	1497	77	105	01.03-11.05	*	
1.5 (NCP13_, NCP13R) (1NZ-FE)	Gasolina	FWD	1497	78	106	04.01-09.05	*	
1.5 (NCP13_, NCP13R) (1NZ-FE)	Gasolina	FWD	1497	110	150	03.00-07.05	*	
1.4 D-4D (NLP10_, NLP10R) (1ND-TV)	Diesel	FWD	1364	55	75	10.01-09.05	*	