

# LISTA DE APLICACIONES - BUYERS GUIDE

## 78RBD13806



Weight: 7.664

O.E.M.	MAKE
4 683 380 6	FIAT
4246.Y7	CITROËN
4246.Y9	PEUGEOT
4249.3	PEUGEOT
4249.30	PEUGEOT
4249.31	PEUGEOT
4249.K7	PEUGEOT
5 174 024 5	FIAT
5 174 927 4	FIAT
7 174 011 8	FIAT

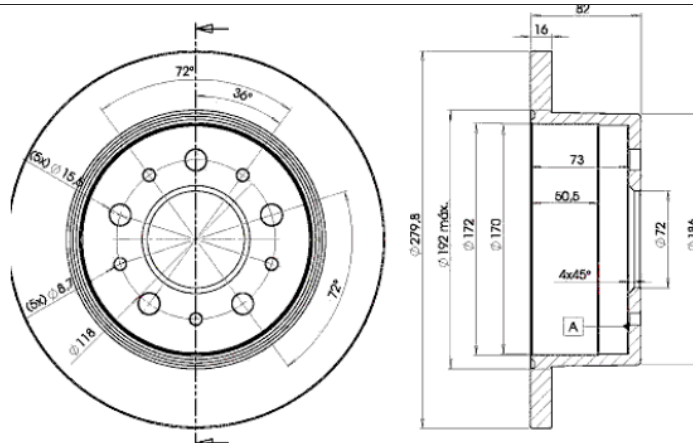

## 78RBD13806



Ø280x16x82

Sin Filas



Trac.	CC	Kw	CV	
				Front / Rear

### CITROËN

JUMPER II / RELAY (230L) 02.94-08.02					[CAMBIADO]:Furgón (LCVs-N1 Segment)				
2.0 (RFW (XU10J2U))		Gasolina	FWD	1998	80	109	03.94-04.02		*
2.0 4x4 (RFW (XU10J2U))		Gasolina	4WD	1998	80	109	10.96-01.02		*
2.0 (XU10J2)		Gasolina	FWD	1998	81	110	04.02-06.06		*
2.0 bivalent (XU10J2)		Gasol./Gas (CNG)	FWD	1998	81	110	02.03-06.06		*
1.9 D (DJY (XUD9A))		Diesel	FWD	1905	50	68	07.99-04.02		*
1.9 D (D9B (XUD9A/U))		Diesel	FWD	1905	51	69	02.94-04.02		*
1.9 TD (DHX (XUD9TF/BTF))		Diesel	FWD	1905	66	90	03.94-04.02		*
1.9 TD (D8C (XUD9UTF))		Diesel	FWD	1905	68	92	03.94-04.02		*
2.0 HDi (RHV (DW10TD))		Diesel	FWD	1997	62	84	11.01-04.02		*
2.0 HDi (RHV (DW10UTD))		Diesel	FWD	1997	62	84	04.02-06.06		*
2.2 HDi (4HY (DW12UTED))		Diesel	FWD	2179	74	101	04.02-06.06		*
2.5 D (T9A (DJ5))		Diesel	FWD	2446	63	86	03.94-04.02		*
2.5 D 4x4 (T9A (DJ5))		Diesel	4WD	2446	63	86	03.00-04.02		*
2.8 D (8140.63 (F28D))		Diesel	FWD	2798	64	87	01.99-02.02		*
2.8 HDi (8140.43S)		Diesel	FWD	2798	94	128	09.00-04.02		*
2.8 HDi (8140.43S)		Diesel	FWD	2798	94	128	04.02-06.06		*
2.8 HDi 4x4 (8140.43S)		Diesel	4WD	2798	94	128	09.00-04.02		*
2.8 HDi 4x4 (8140.43S)		Diesel	4WD	2798	94	128	04.02-06.06		*
2.8 HDi (8140.43N)		Diesel	FWD	2798	107	146	04.04-06.06		*
JUMPER II / RELAY (230P) 02.94-04.02					Bus (Minibus-M2-Segment)				
2.0 (RFW (XU10J2U))		Gasolina	FWD	1998	80	109	02.94-04.02		*

# LISTA DE APLICACIONES - BUYERS GUIDE

2.0 (XU10J2)		Gasolina	FWD	1998	81	110	04.02-06.06	*
2.0 bivalent (XU10J2)		Gasol./Gas (CNG)	FWD	1998	81	110	02.03-06.06	*
1.9 D (D9B (XUD9A/U))		Diesel	FWD	1905	51	69	01.99-04.02	*
1.9 TD (D8C (XUD9UTF))		Diesel	FWD	1905	66	90	08.94-04.02	*
1.9 TD (D8C (XUD9UTF))		Diesel	FWD	1905	68	92	02.94-04.02	*
1.9 TD 4x4 (D8C (XUD9UTF))		Diesel	4WD	1905	68	92	08.96-04.02	*
2.0 HDi (RHV (DW10UTD))		Diesel	FWD	1997	62	84	04.02-06.06	*
2.2 HDi (4HY (DW12UTED))		Diesel	FWD	2179	74	101	04.02-06.06	*
2.5 D (T9A (DJ5))		Diesel	FWD	2446	63	86	08.94-04.02	*
2.5 D 4x4 (T9A (DJ5))		Diesel	4WD	2446	63	86	08.96-04.02	*
2.8 D (8140.63 (F28D))		Diesel	FWD	2798	64	87	01.99-02.02	*
2.8 HDi (8140.43S)		Diesel	FWD	2798	94	128	04.02-06.06	*
2.8 HDi A las 4 ruedas (8140.43S)		Diesel	4WD	2798	94	128	04.02-06.06	*
<b>JUMPER II / RELAY (230) 03.94-04.02</b>					<b>Caja/Chasis (LCVs-N1 Segment)</b>			
2.0 (RFW (XU10J2U))		Gasolina	FWD	1998	80	109	03.94-04.02	*
2.0 HDi (RHV (DW10UTD))		Diesel	FWD	1997	62	84	04.02-06.06	*
2.2 HDi (4HY (DW12UTED))		Diesel	FWD	2179	74	101	04.02-06.06	*
2.5 D (T9A (DJ5))		Diesel	FWD	2446	63	86	03.94-04.02	*
2.5 D 4x4 (T9A (DJ5))		Diesel	4WD	2446	63	86	03.00-04.02	*
2.8 D (8140.63 (F28D))		Diesel	FWD	2798	64	87	01.99-02.02	*
2.8 HDi (8140.43S)		Diesel	FWD	2798	94	128	09.00-04.02	*
2.8 HDi (8140.43S)		Diesel	FWD	2798	94	128	04.02-06.06	*
2.8 HDi 4x4 (F28TDCR)		Diesel	4WD	2798	94	128	02.02-06.06	*
<b>JUMPER III / RELAY 04.06-</b>					<b>[CAMBIADO]:Furgón (LCVs-N1 Segment)</b>			
2.0 BlueHDi 110 (AHM (DW10FUE))		Diesel	FWD	1997	81	110	11.15-09.19	*
2.0 BlueHDi 130 (AHN (DW10FUD))		Diesel	FWD	1997	96	130	11.15-09.19	*
2.0 BlueHDi 160 (AHP (DW10FUC))		Diesel	FWD	1997	120	163	11.15-09.19	*
2.0 BlueHDi 160 4x4 (AHP (DW10FUC))		Diesel	4WD	1997	120	163	11.15-09.19	*
2.2 HDi 100 (4HV (P22DTE))		Diesel	FWD	2198	74	101	04.06-12.12	*
2.2 HDi 110 (4HG (P22DTE))		Diesel	FWD	2198	81	110	07.11-12.20	*
2.2 HDi 120 (4HU (P22DTE))		Diesel	FWD	2198	88	120	04.06-12.16	*
2.2 HDi 130 (4HH (P22DTE))		Diesel	FWD	2198	96	130	07.11-	*
2.2 HDi 150 (4HJ (P22DTE))		Diesel	FWD	2198	110	150	07.11-	*
3.0 HDi 145 (F30DTE (F1CE3481N))		Diesel	FWD	2999	107	146	07.10-12.13	*
3.0 HDi 155 (F1CE0481D (F30DT))		Diesel	FWD	2999	115	156	07.06-12.15	*
3.0 HDi 160 (F1CE0481D (F30DT))		Diesel	FWD	2999	116	157	09.06-12.15	*
3.0 HDi 180 (F1CE3481E (F30DTE))		Diesel	FWD	2999	130	177	07.11-	*
<b>JUMPER III / RELAY 04.06-</b>					<b>Bus (Minibus-M2-Segment)</b>			
2.0 BlueHDi 110 (AHM (DW10FUE))		Diesel	FWD	1997	81	110	07.15-09.19	*
2.0 BlueHDi 130 (AHN (DW10FUD))		Diesel	FWD	1997	96	130	07.15-09.19	*
2.0 BlueHDi 160 (AHP (DW10FUC))		Diesel	FWD	1997	120	163	07.15-09.19	*
2.2 HDi 100 (4HV (P22DTE))		Diesel	FWD	2198	74	101	04.06-	*
2.2 HDi 110 (4HG (P22DTE))		Diesel	FWD	2198	81	110	07.11-12.20	*
2.2 HDi 120 (4HU (P22DTE))		Diesel	FWD	2198	88	120	04.06-12.16	*
2.2 HDi 130 (4HH (P22DTE))		Diesel	FWD	2198	96	130	07.11-	*
2.2 HDi 150 (4HJ (P22DTE))		Diesel	FWD	2198	110	150	07.11-	*
3.0 HDi 155 (F1CE0481D (F30DT))		Diesel	FWD	2999	115	157	07.06-	*
3.0 HDi 160 (F1CE0481D (F30DT))		Diesel	FWD	2999	116	157	09.06-	*
3.0 HDi 180 (F1CE3481E (F30DTE))		Diesel	FWD	2999	130	177	07.11-	*

# LISTA DE APLICACIONES - BUYERS GUIDE

JUMPER III / RELAY 04.06-					Caja/Chasis (LCVs-N1 Segment)			
2.0 BlueHDi 110 (AHM (DW10FUE))		Diesel	FWD	1997	81	110	11.15-09.19	*
2.0 BlueHDi 130 (AHN (DW10FUD))		Diesel	FWD	1997	96	130	11.15-09.19	*
2.0 BlueHDi 130 4x4 (AHN (DW10FUD))		Diesel	4WD	1997	96	130	11.15-09.19	*
2.0 BlueHDi 160 (AHP (DW10FUC))		Diesel	FWD	1997	120	163	11.15-09.19	*
2.0 BlueHDi 160 4x4 (AHP (DW10FUC))		Diesel	4WD	1997	120	163	11.15-09.19	*
2.2 HDi 100 (4HV (P22DTE))		Diesel	FWD	2198	74	101	04.06-	*
2.2 HDi 110 (4HG (P22DTE))		Diesel	FWD	2198	81	110	07.11-12.20	*
2.2 HDi 120 (4HU (P22DTE))		Diesel	FWD	2198	88	120	04.06-12.16	*
2.2 HDi 130 (4HH (P22DTE))		Diesel	FWD	2198	96	130	07.11-	*
2.2 HDi 150 (4HJ (P22DTE))		Diesel	FWD	2198	110	150	07.11-	*
3.0 HDi 145 (F30DTE (F1CE3481N))		Diesel	FWD	2999	107	146	07.10-12.13	*
3.0 HDi 160 (F1CE0481D (F30DT))		Diesel	FWD	2999	116	157	09.06-12.15	*
3.0 HDi 180 (F1CE3481E (F30DTE))		Diesel	FWD	2999	130	177	07.11-	*
FIAT								
DUCATO II (230_) 03.94-05.05					[CAMBIADO]:Furgón (LCVs-N1 Segment)			
2.0 (RFL)		Gasolina	FWD	1998	81	110	12.01-07.06	*
2.0 LPG (RFL)		Gasol./Gas (LPG)	FWD	1998	71	97	11.02-07.06	*
2.3 JTD (F1AE0481C)		Diesel	FWD	2286	81	110	12.01-07.06	*
2.3 JTD		Diesel	FWD	2287	93	126	09.09-12.18	*
2.8 JTD (8140.43S)		Diesel	FWD	2798	94	128	12.01-12.11	*
2.8 JTD 4x4 (8140.43S)		Diesel	4WD	2798	94	128	11.00-04.02	*
2.8 JTD 4x4 (8140.43S)		Diesel	4WD	2798	94	128	12.01-07.06	*
DUCATO II (230_) 03.94-05.05					Bus (Minibus-M2-Segment)			
2.0 Panorama/Combinato (RFW)		Gasolina	FWD	1998	80	109	03.94-04.02	*
2.0 (RFL)		Gasolina	FWD	1998	81	110	12.01-07.06	*
2.0 LPG (RFL)		Gasol./Gas (LPG)	FWD	1998	71	97	11.02-07.06	*
2.3 JTD (F1AE0481C)		Diesel	FWD	2286	81	110	12.01-07.06	*
2.3 JTD		Diesel	FWD	2287	93	126	12.09-12.17	*
2.5 D		Diesel	FWD	2499	55	75	03.94-04.02	*
2.5 TD 4x4 (8140.47)		Diesel	4WD	2499	85	116	06.94-09.01	*
2.5 TDI 4x4 (8140.47)		Diesel	4WD	2500	85	116	04.97-04.02	*
2.8 JTD (8140.43S)		Diesel	FWD	2798	94	128	11.00-04.02	*
2.8 JTD (8140.43S)		Diesel	FWD	2798	94	128	12.01-	*
2.8 JTD 4x4 (8140.43S)		Diesel	4WD	2798	94	128	11.00-04.02	*
DUCATO II (230_) 03.94-04.02					Caja/Chasis (LCVs-N1 Segment)			
2.0 4x4 (RFW)		Gasolina	4WD	1998	80	109	11.94-09.01	*
2.0 (RFL)		Gasolina	FWD	1998	81	110	04.02-07.06	*
2.0 JTD (RHV)		Diesel	FWD	1997	62	84	07.01-04.02	*
2.0 JTD (RHV)		Diesel	FWD	1997	62	84	12.01-07.06	*
2.3 JTD (F1AE0481C)		Diesel	FWD	2286	81	110	12.01-07.06	*
2.8 JTD (8140.43S)		Diesel	FWD	2798	94	128	11.00-04.02	*
2.8 JTD (8140.43S)		Diesel	FWD	2798	94	128	12.01-07.06	*
2.8 JTD 4x4 (8140.43S)		Diesel	4WD	2798	94	128	10.01-04.02	*
2.8 JTD 4x4 (8140.43S)		Diesel	4WD	2798	94	128	12.01-07.06	*
2.8 JTD 4x4		Diesel	4WD	2799	90	122	11.03-07.06	*
DUCATO III (250_) 07.06-					[CAMBIADO]:Furgón (LCVs-N1 Segment)			
115 Multijet 2,0 D (250 A1.000)		Diesel	FWD	1956	85	116	06.11-	*

# LISTA DE APLICACIONES - BUYERS GUIDE

115 Multijet 2,0 D (250 A2.000)		Diesel	FWD	1956	85	116	06.11-	*
120 Multijet 2,2 D		Diesel	FWD	2184	88	120	07.21-	*
140 Multijet 2,2 D		Diesel	FWD	2184	103	140	07.21-	*
160 Multijet 2,2 D		Diesel	FWD	2184	118	160	07.21-10.23	*
180 Multijet 2,2 D		Diesel	FWD	2184	132	179	07.21-	*
100 Multijet 2,2 D (4HV)		Diesel	FWD	2198	74	100	07.06-	*
120 Multijet 2,3 D (F1AE0481D)		Diesel	FWD	2287	88	120	07.06-	*
120 Multijet 2,3 D (F1AGL4114)		Diesel	FWD	2287	88	120	07.06-	*
130 Multijet 2,3 D (F1AE0481N)		Diesel	FWD	2287	96	131	08.06-	*
130 Multijet 2,3 D (F1AE3481D)		Diesel	FWD	2287	96	131	08.06-	*
130 Multijet 2,3 D (F1AGL411D)		Diesel	FWD	2287	96	131	08.06-	*
150 Multijet 2,3 D (F1AE3481E)		Diesel	FWD	2287	109	148	06.11-	*
150 Multijet 3,0 D (F1CE3481N)		Diesel	FWD	2999	107	146	04.10-	*
160 Multijet 3,0 D (F1CE0481D)		Diesel	FWD	2999	116	158	07.06-	*
180 Multijet 3,0 D (F1CE3481E)		Diesel	FWD	2999	130	177	06.11-	*
140 Natural Power (F1CE0441A)		CNG	FWD	2999	100	136	04.09-	*
140 Natural Power (F1CFA401A)		CNG	FWD	2999	100	136	04.09-	*
<b>DUCATO III (250_) 07.06-</b>					<b>Bus (Minibus-M2-Segment)</b>			
115 Multijet 2,0 D (250 A1.000)		Diesel	FWD	1956	85	116	06.11-	*
115 Multijet 2,0 D (250 A2.000)		Diesel	FWD	1956	85	116	06.11-	*
140 Multijet 2,2 D		Diesel	FWD	2184	103	140	07.21-	*
100 Multijet 2,2 D (4HV)		Diesel	FWD	2198	74	100	07.06-05.11	*
120 Multijet 2,3 D (F1AE0481D)		Diesel	FWD	2287	88	120	07.06-	*
130 Multijet 2,3 D (F1AE0481N)		Diesel	FWD	2287	96	131	01.07-	*
130 Multijet 2,3 D (F1AE3481D)		Diesel	FWD	2287	96	131	01.07-	*
130 Multijet 2,3 D (F1AGL411D)		Diesel	FWD	2287	96	131	01.07-	*
150 Multijet 2,3 D (F1AE3481E)		Diesel	FWD	2287	109	148	06.11-	*
150 Multijet 3,0 D (F1CE3481N)		Diesel	FWD	2999	107	146	04.10-	*
160 Multijet 3,0 D (F1CE0481D)		Diesel	FWD	2999	116	158	07.06-	*
160 Multijet 3,0 D (F1CE3481M)		Diesel	FWD	2999	116	158	07.06-	*
180 Multijet 3,0 D (F1CE3481E)		Diesel	FWD	2999	130	177	06.11-	*
140 Natural Power (F1CE0441A)		CNG	FWD	2999	100	136	04.09-	*
140 Natural Power (F1CFA401A)		CNG	FWD	2999	100	136	04.09-	*
<b>DUCATO III (250_) 07.06-</b>					<b>Caja/Chasis (LCVs-N1 Segment)</b>			
115 Multijet 2,0 D (250 A1.000)		Diesel	FWD	1956	85	116	06.11-	*
115 Multijet 2,0 D (250 A2.000)		Diesel	FWD	1956	85	116	06.11-	*
120 Multijet 2,2 D		Diesel	FWD	2184	88	120	09.21-	*
140 Multijet 2,2 D		Diesel	FWD	2184	103	140	09.21-	*
160 Multijet 2,2 D		Diesel	FWD	2184	118	160	09.21-10.23	*
180 Multijet 2,2 D		Diesel	FWD	2184	132	179	09.21-	*
100 Multijet 2,2 D (4HV)		Diesel	FWD	2198	74	100	07.06-	*
120 Multijet 2,3 D (F1AE0481D)		Diesel	FWD	2287	88	120	07.06-	*
120 Multijet 2,3 D (F1AGL4114)		Diesel	FWD	2287	88	120	07.06-	*
130 Multijet 2,3 D (F1AE0481N)		Diesel	FWD	2287	96	131	08.06-	*
130 Multijet 2,3 D (F1AE3481D)		Diesel	FWD	2287	96	131	08.06-	*
130 Multijet 2,3 D (F1AGL411D)		Diesel	FWD	2287	96	131	08.06-	*
150 Multijet 2,3 D (F1AE3481E)		Diesel	FWD	2287	109	148	06.11-	*
150 Multijet 3,0 D (F1CE3481N)		Diesel	FWD	2999	107	146	04.10-	*
160 Multijet 3,0 D (F1CE0481D)		Diesel	FWD	2999	116	158	07.06-	*
180 Multijet 3,0 D (F1CE3481E)		Diesel	FWD	2999	130	177	06.11-	*

PEUGEOT

# LISTA DE APLICACIONES - BUYERS GUIDE

BOXER II (230L) 03.94-08.06					[CAMBIADO]:Furgón (LCVs-N1 Segment)			
2.0 (RFL (XU10J2U))		Gasolina	FWD	1998	81	110	12.01-06.06	*
2.0 BiFuel		Gasol./Gas (LPG)	FWD	1998	81	110	12.01-06.06	*
2.0 HDi (RHV (DW10UTD))		Diesel	FWD	1997	62	84	08.01-04.02	*
2.0 HDi (RHV (DW10TD))		Diesel	FWD	1997	62	84	04.02-06.06	*
2.0 HDi (RHV (DW10UTD))		Diesel	FWD	1997	62	84	04.02-06.06	*
2.2 HDi (4HY (DW12UTED))		Diesel	FWD	2179	74	101	12.01-06.06	*
2.3 HDi		Diesel	FWD	2287	93	126	02.07-	*
2.8 D (8140.63 (F28D))		Diesel	FWD	2798	64	87	01.99-02.02	*
2.8 DTiC		Diesel	FWD	2798	90	122	10.97-08.05	*
2.8 HDI		Diesel	FWD	2798	90	122	03.02-08.05	*
2.8 HDi (8140.43S (F28DTCR))		Diesel	FWD	2798	93	126	09.05-09.09	*
2.8 HDi (8140.43S (F28DTCR))		Diesel	FWD	2798	94	128	12.01-06.06	*
2.8 HDi 4x4 (8140.43S (F28DTCR))		Diesel	4WD	2798	94	128	10.00-04.02	*
2.8 HDi 4x4 (8140.43S (F28DTCR))		Diesel	4WD	2798	94	128	12.01-06.06	*
2.8 HDi (8140.43N)		Diesel	FWD	2798	107	146	04.04-06.06	*
BOXER II (230P) 03.94-12.09					Bus (Minibus-M2-Segment)			
2.0 (RFL (XU10J2U))		Gasolina	FWD	1998	81	110	12.01-06.06	*
2.0 BiFuel		Gasol./Gas (LPG)	FWD	1998	81	110	12.01-06.06	*
2.0 HDi (RHV (DW10TD))		Diesel	FWD	1997	62	84	12.01-06.06	*
2.0 HDi (RHV (DW10UTD))		Diesel	FWD	1997	62	84	12.01-06.06	*
2.2 HDi (4HY (DW12UTED))		Diesel	FWD	2179	74	101	12.01-06.06	*
2.8 D (8140.63 (F28D))		Diesel	FWD	2798	64	87	01.99-02.02	*
2.8 DTiC		Diesel	FWD	2798	90	122	10.97-09.00	*
2.8 HDI		Diesel	FWD	2798	90	122	03.02-08.05	*
2.8 HDi (8140.43S (F28DTCR))		Diesel	FWD	2798	94	128	12.01-06.06	*
2.8 HDi 4x4 (8140.43S (F28DTCR))		Diesel	4WD	2798	94	128	10.00-04.02	*
2.8 HDi 4x4 (8140.43S (F28DTCR))		Diesel	4WD	2798	94	128	12.01-06.06	*
BOXER II (ZCT_) 03.94-04.02					Caja/Chasis (LCVs-N1 Segment)			
2.0 BiFuel		Gasol./Gas (LPG)	FWD	1998	81	110	12.01-06.06	*
2.0 HDi (RHV (DW10TD))		Diesel	FWD	1997	62	84	12.01-06.06	*
2.0 HDi (RHV (DW10UTD))		Diesel	FWD	1997	62	84	12.01-06.06	*
2.2 HDi (4HY (DW12UTED))		Diesel	FWD	2179	74	101	12.01-06.06	*
2.8 D (8140.63 (F28D))		Diesel	FWD	2798	64	87	01.99-02.02	*
2.8 HDi (8140.43S (F28DTCR))		Diesel	FWD	2798	94	128	12.01-06.06	*
2.8 HDi 4x4 (8140.43S (F28DTCR))		Diesel	4WD	2798	94	128	12.01-06.06	*
2.8 HDi (8140.43N)		Diesel	FWD	2798	107	146	04.04-06.06	*
BOXER III / MANAGER 04.06-					[CAMBIADO]:Furgón (LCVs-N1 Segment)			
2.0 BlueHDi 110 (AHM (DW10FUE))		Diesel	FWD	1997	81	110	03.16-09.19	*
2.0 BlueHDi 130 (AHN (DW10FUD))		Diesel	FWD	1997	96	130	03.16-	*
2.0 BlueHDi 160 (AHP (DW10FUC))		Diesel	FWD	1997	120	163	03.16-12.23	*
2.2 HDi 100 (4HV (P22DTE))		Diesel	FWD	2198	74	101	04.06-	*
2.2 HDi 110 (4HG (P22DTE))		Diesel	FWD	2198	81	110	03.11-12.20	*
2.2 HDi 120 (4HU (P22DTE))		Diesel	FWD	2198	88	120	04.06-12.16	*
2.2 HDi 130 (4HH (P22DTE))		Diesel	FWD	2198	96	131	03.11-	*
2.2 HDi 150 (4HJ (P22DTE))		Diesel	FWD	2198	110	150	03.11-	*
3.0 HDi 145 (F1CE3481N (F30DTE))		Diesel	FWD	2999	107	146	04.10-12.13	*
3.0 HDi 155 (F1CE0481D (F30DT))		Diesel	FWD	2999	115	156	07.06-12.15	*

# LISTA DE APLICACIONES - BUYERS GUIDE

3.0 HDi 160 (F1CE0481D (F30DT))	Diesel	FWD	2999	116	156	04.06-12.15	*
3.0 HDi 175 (F1CE3481E (F30DTE))	Diesel	FWD	2999	130	177	03.11-	*
<b>BOXER III / MANAGER 09.05-</b>				<b>Bus (Minibus-M2-Segment)</b>			
2.0 BlueHDi 110 (AHM (DW10FUE))	Diesel	FWD	1997	81	110	07.15-09.19	*
2.0 BlueHDi 130 (AHN (DW10FUD))	Diesel	FWD	1997	96	130	07.15-09.19	*
2.0 BlueHDi 160 (AHP (DW10FUC))	Diesel	FWD	1997	120	163	07.15-09.19	*
2.2 HDi 100 (4HV (P22DTE))	Diesel	FWD	2198	74	101	04.06-	*
2.2 HDi 110 (4HG (P22DTE))	Diesel	FWD	2198	81	110	03.11-12.20	*
2.2 HDi 120 (4HU (P22DTE))	Diesel	FWD	2198	88	120	04.06-12.16	*
2.2 HDi 130 (4HH (P22DTE))	Diesel	FWD	2198	96	131	03.11-	*
2.2 HDi 150 (4HJ (P22DTE))	Diesel	FWD	2198	110	150	03.11-	*
3.0 HDi 145 (F1CE3481N (F30DTE))	Diesel	FWD	2999	107	146	04.10-12.13	*
3.0 HDi 160 (F1CE0481D (F30DT))	Diesel	FWD	2999	115	156	04.06-12.15	*
<b>BOXER III / MANAGER 04.06-</b>				<b>Caja/Chasis (LCVs-N1 Segment)</b>			
2.0 BlueHDi 110 (AHM (DW10FUE))	Diesel	FWD	1997	81	110	03.16-09.19	*
2.0 BlueHDi 130 (AHN (DW10FUD))	Diesel	FWD	1997	96	130	03.16-09.19	*
2.0 BlueHDi 160 (AHP (DW10FUC))	Diesel	FWD	1997	120	163	03.16-12.23	*
2.2 HDi 100 (4HV (P22DTE))	Diesel	FWD	2198	74	101	04.06-	*
2.2 HDi 110 (4HG (P22DTE))	Diesel	FWD	2198	81	110	03.11-12.20	*
2.2 HDi 120 (4HU (P22DTE))	Diesel	FWD	2198	88	120	04.06-12.16	*
2.2 HDi 130 (4HH (P22DTE))	Diesel	FWD	2198	96	131	03.11-	*
2.2 HDi 150 (4HJ (P22DTE))	Diesel	FWD	2198	110	150	03.11-	*
3.0 HDi 145 (F1CE3481N (F30DTE))	Diesel	FWD	2999	107	146	04.10-12.13	*
3.0 HDi 155 (F1CE0481D (F30DT))	Diesel	FWD	2999	115	156	04.06-12.15	*
3.0 HDi 160 (F1CE0481D (F30DT))	Diesel	FWD	2999	116	156	04.06-12.15	*
3.0 HDi 175 (F1CE3481E (F30DTE))	Diesel	FWD	2999	130	177	03.11-	*