

# LISTA DE APLICACIONES - BUYERS GUIDE

## 3R15269020

Weight: 8.698

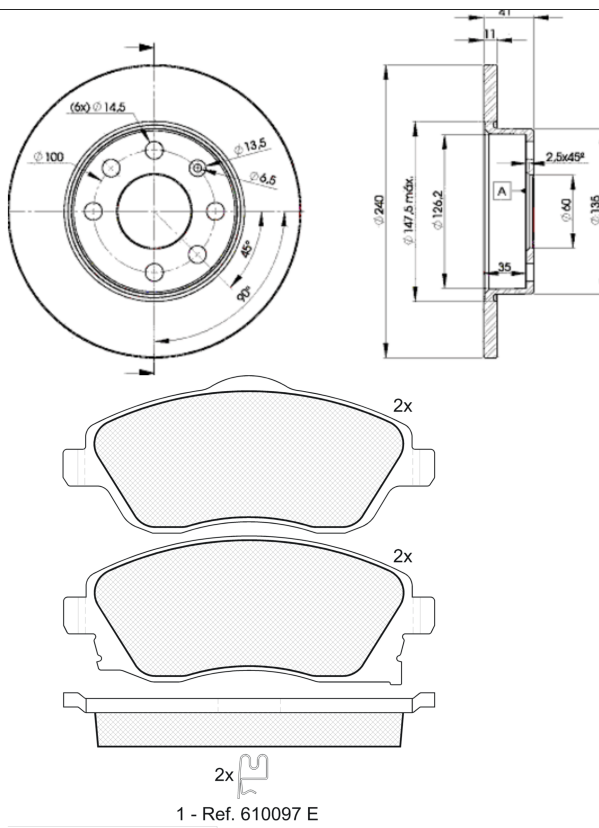

1 - Ref. 610097 E

## 3R15269020



Lucas - Girling

131.5x52.5x17

Ø240x11x41

**WVA**

23225

Sin Filas



Trac.	CC	Kw	CV
-------	----	----	----



Front / Rear

### OPEL

#### CORSA C (X01) 09.00-

#### Furgón/hatchback (LCVs-N1 Segment)

1.2 (F08, W5L) (Z 12 XEP)	Gasolina	FWD	1229	59	80	07.05-06.06	*
1.2 (F08, W5L) (Z 12 XEP)	Gasolina	FWD	1229	59	80	07.05-06.06	*

#### CORSA C / VITA C (X01) 09.00-12.09

#### [CAMBIADO]:Fastback (Supermini car-B Segment)

1.0 (F08, F68) (Z 10 XEP)	Gasolina	FWD	998	44	60	06.03-12.09	*
1.0 (F08, F68) (Z 10 XEP)	Gasolina	FWD	998	44	60	06.03-12.09	*
1.2 Twinport (F08, F68) (Z 12 XEP)	Gasolina	FWD	1229	59	80	07.04-12.09	*
1.2 Twinport (F08, F68) (Z 12 XEP)	Gasolina	FWD	1229	59	80	07.04-12.09	*

### VAUXHALL

#### CORSA Mk II (C) (X01) 08.00-04.07

#### [CAMBIADO]:Fastback (Supermini car-B Segment)

1.0 12V (F08, F68) (Z 10 XEP)	Gasolina	FWD	998	44	60	11.03-10.06	*
1.0 12V (F08, F68) (Z 10 XEP)	Gasolina	FWD	998	44	60	11.03-10.06	*
1.2 16V Dualfuel (F08) (Z 12 XE)	Gasol./G as (LPG)	FWD	1199	55	75	08.01-10.06	*
1.2 16V Dualfuel (F08) (Z 12 XE)	Gasol./G as (LPG)	FWD	1199	55	75	08.01-10.06	*

#### CORSAVAN Mk II (C) (X01) 09.00-11.06

#### Furgón/hatchback (LCVs-N1 Segment)

1.2 16V Dualfuel (F08) (Z 12 XE)	Gasol./G as (LPG)	FWD	1199	55	75	08.01-06.06	*
1.2 16V Dualfuel (F08) (Z 12 XE)	Gasol./G as (LPG)	FWD	1199	55	75	08.01-06.06	*