

LISTA DE APLICACIONES - BUYERS GUIDE

3R15034070

Weight: 8.690

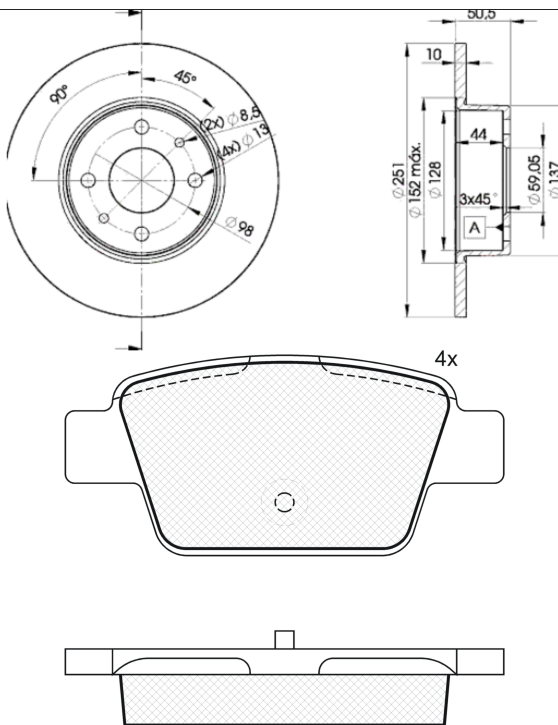

181503-701



3R15034070



Bosch

94.8x42.9x16.3

Ø251x10x50.5

WVA

23714

Sin Filas



Trac.	CC	Kw	CV	
				Front / Rear

CHRYSLER

DELTA 08.11-

[CAMBIADO]:Fastback (Compact car-C Segment)

1.4 (198 A4.000)	Gasolina	FWD	1368	88	120	08.11-	*
1.4 (198 A4.000)	Gasolina	FWD	1368	88	120	08.11-	*
1.6 D Multijet (198 A2.000)	Diesel	FWD	1598	88	120	08.11-	*
1.6 D Multijet (198 A2.000)	Diesel	FWD	1598	88	120	08.11-	*
2.0 D Multijet (198 A5.000)	Diesel	FWD	1956	121	165	08.11-	*
2.0 D Multijet (198 A5.000)	Diesel	FWD	1956	121	165	08.11-	*

FIAT

BRAVO II / RITMO III (198_) 11.06-

[CAMBIADO]:Fastback (Compact car-C Segment)

1.4 (198AXA1B) (192 B2.000)	Gasolina	FWD	1368	66	90	04.07-12.14	*
1.4 (198AXA1B) (192 B2.000)	Gasolina	FWD	1368	66	90	04.07-12.14	*
1.4 T-Jet (198AXF1B) (198 A1.000)	Gasolina	FWD	1368	110	150	09.07-12.14	*
1.4 T-Jet (198AXF1B) (198 A1.000)	Gasolina	FWD	1368	110	150	09.07-12.14	*
1.4 LPG (198AXA1B) (192 B2.000)	Gasol./G as (LPG)	FWD	1368	66	90	12.08-12.14	*
1.4 LPG (198AXA1B) (192 B2.000)	Gasol./G as (LPG)	FWD	1368	66	90	12.08-12.14	*
1.9 D Multijet (198AXB1A) (192 A8.000)	Diesel	FWD	1910	88	120	04.07-12.14	*
1.9 D Multijet (198AXB1A) (192 A8.000)	Diesel	FWD	1910	88	120	04.07-12.14	*
1.9 D Multijet (198AXC1B) (937 A5.000)	Diesel	FWD	1910	110	150	04.07-12.14	*
1.9 D Multijet (198AXC1B) (937 A5.000)	Diesel	FWD	1910	110	150	04.07-12.14	*

MULTIPLA (186_) 04.99-06.10

MPV (Compact MPV-M1 Segment)

1.6 16V (186AGB1A) (182 B6.000)	Gasolina	FWD	1596	70	95	04.02-06.10	*
1.6 16V (186AGB1A) (182 B6.000)	Gasolina	FWD	1596	70	95	04.02-06.10	*

LISTA DE APLICACIONES - BUYERS GUIDE

1.6 (186AXC1A, 186BMC1A, 186BXC1A) (182 B6.000)	Gasolina	FWD	1596	76	103	09.00-06.10	*
1.6 (186AXC1A, 186BMC1A, 186BXC1A) (182 B6.000)	Gasolina	FWD	1596	76	103	09.00-06.10	*
1.6 16V GPL (182 B6.000)	Gasol./Gas (LPG)	FWD	1596	76	103	10.01-06.10	*
1.6 16V GPL (182 B6.000)	Gasol./Gas (LPG)	FWD	1596	76	103	10.01-06.10	*
1.6 Blupower (186AMA1A) (186 A3.000)	Gasol./Gas (CNG)	FWD	1581	70	95	04.99-09.04	*
1.6 Blupower (186AMA1A) (186 A3.000)	Gasol./Gas (CNG)	FWD	1581	70	95	04.99-09.04	*
1.6 16V Bipower (186AXC1A) (182 B6.000)	Gasol./Gas (CNG)	FWD	1596	76	103	10.01-06.10	*
1.6 16V Bipower (186AXC1A) (182 B6.000)	Gasol./Gas (CNG)	FWD	1596	76	103	10.01-06.10	*
1.9 JTD 105 (186AXB1A) (182 B4.000)	Diesel	FWD	1910	77	105	04.99-06.10	*
1.9 JTD 105 (186AXB1A) (182 B4.000)	Diesel	FWD	1910	77	105	04.99-06.10	*
1.9 JTD 110 (186 A6.000)	Diesel	FWD	1910	81	110	03.01-07.02	*
1.9 JTD 110 (186 A6.000)	Diesel	FWD	1910	81	110	03.01-07.02	*
1.9 JTD 115 (186 A8.000)	Diesel	FWD	1910	85	115	07.02-06.10	*
1.9 JTD 115 (186 A8.000)	Diesel	FWD	1910	85	115	07.02-06.10	*
1.9 JTD (186AXE1A) (186 A9.000)	Diesel	FWD	1910	88	120	04.02-06.10	*
1.9 JTD (186AXE1A) (186 A9.000)	Diesel	FWD	1910	88	120	04.02-06.10	*
STILO (192_) 10.01-11.10				[CAMBIADO]:Fastback (Compact car-C Segment)			
1.2 16V (192_XA1B) (188 A5.000)	Gasolina	FWD	1242	59	80	02.02-11.06	*
1.2 16V (192_XA1B) (188 A5.000)	Gasolina	FWD	1242	59	80	02.02-11.06	*
1.4 16V (192 B2.000)	Gasolina	FWD	1368	66	90	03.05-11.06	*
1.4 16V (192 B2.000)	Gasolina	FWD	1368	66	90	03.05-11.06	*
1.4 16V (192AXH1B, 192BXH1B) (843 A1.000)	Gasolina	FWD	1368	70	95	10.03-12.06	*
1.4 16V (192AXH1B, 192BXH1B) (843 A1.000)	Gasolina	FWD	1368	70	95	10.03-12.06	*
1.6 16V (192_XB1A) (182 B6.000)	Gasolina	FWD	1596	76	103	10.01-11.06	*
1.6 16V (192_XB1A) (182 B6.000)	Gasolina	FWD	1596	76	103	10.01-11.06	*
1.6 (182 B6.000)	Gasolina	FWD	1596	100	136	04.05-11.06	*
1.6 (182 B6.000)	Gasolina	FWD	1596	100	136	04.05-11.06	*
1.8 16V (192AXC1A, 192BXC1A) (192 A4.000)	Gasolina	FWD	1747	98	133	10.01-04.07	*
1.8 16V (192AXC1A, 192BXC1A) (192 A4.000)	Gasolina	FWD	1747	98	133	10.01-04.07	*
1.8	Gasolina	FWD	1796	76	103	01.04-11.06	*
1.8	Gasolina	FWD	1796	76	103	01.04-11.06	*
1.8 Flex	Gasolina	FWD	1796	84	114	09.05-11.10	*
1.8 Flex	Gasolina	FWD	1796	84	114	09.05-11.10	*
1.8	Gasolina	FWD	1796	90	122	01.04-11.06	*
1.8	Gasolina	FWD	1796	90	122	01.04-11.06	*
2.4 20V	Gasolina	FWD	2446	123	167	01.04-11.06	*
2.4 20V	Gasolina	FWD	2446	123	167	01.04-11.06	*
2.4 20V (192_XD1A, 192AXD12) (192 A2.000)	Gasolina	FWD	2446	125	170	10.01-04.07	*
2.4 20V (192_XD1A, 192AXD12) (192 A2.000)	Gasolina	FWD	2446	125	170	10.01-04.07	*
1.9 JTD (192_XF1A) (192 A3.000)	Diesel	FWD	1910	59	80	02.02-11.06	*
1.9 JTD (192_XF1A) (192 A3.000)	Diesel	FWD	1910	59	80	02.02-11.06	*
1.9 JTD (192AXS1B, 192BXS1B) (192 B5.000)	Diesel	FWD	1910	66	90	09.04-11.06	*
1.9 JTD (192AXS1B, 192BXS1B) (192 B5.000)	Diesel	FWD	1910	66	90	09.04-11.06	*
1.9 JTD (192_XE1A) (192 A1.000)	Diesel	FWD	1910	85	115	10.01-11.06	*
1.9 JTD (192_XE1A) (192 A1.000)	Diesel	FWD	1910	85	115	10.01-11.06	*

LISTA DE APLICACIONES - BUYERS GUIDE

1.9 JTD (192_XE1A) (937 A7.000)		Diesel	FWD	1910	85	115	10.01-11.06	*
1.9 JTD (192_XE1A) (937 A7.000)		Diesel	FWD	1910	85	115	10.01-11.06	*
1.9 D Multijet (192 A8.000)		Diesel	FWD	1910	88	120	09.05-11.06	*
1.9 D Multijet (192 A8.000)		Diesel	FWD	1910	88	120	09.05-11.06	*
1.9 JTD (937 A4.000)		Diesel	FWD	1910	93	126	09.03-11.06	*
1.9 JTD (937 A4.000)		Diesel	FWD	1910	93	126	09.03-11.06	*
1.9 JTD (192 B1.000)		Diesel	FWD	1910	100	136	04.04-11.06	*
1.9 JTD (192 B1.000)		Diesel	FWD	1910	100	136	04.04-11.06	*
1.9 JTD (192 A5.000)		Diesel	FWD	1910	103	140	01.04-11.06	*
1.9 JTD (192 A5.000)		Diesel	FWD	1910	103	140	01.04-11.06	*
1.9 D Multijet (937 A5.000)		Diesel	FWD	1910	110	150	09.05-11.06	*
1.9 D Multijet (937 A5.000)		Diesel	FWD	1910	110	150	09.05-11.06	*
STILO (192_) 10.01-08.08					[CAMBIADO]:Furgón/Break (Compact car-C Segment)			
1.4 (192DXH1B) (843 A1.000)		Gasolina	FWD	1368	70	95	01.04-08.08	*
1.4 (192DXH1B) (843 A1.000)		Gasolina	FWD	1368	70	95	01.04-08.08	*
1.6 (192DXB1A) (182 B6.000)		Gasolina	FWD	1596	100	136	04.05-08.08	*
1.6 (192DXB1A) (182 B6.000)		Gasolina	FWD	1596	100	136	04.05-08.08	*
1.9 JTD (192DXF1A) (192 A3.000)		Diesel	FWD	1910	59	80	10.01-08.05	*
1.9 JTD (192DXF1A) (192 A3.000)		Diesel	FWD	1910	59	80	10.01-08.05	*
1.9 JTD (192DXE1A) (192 A1.000)		Diesel	FWD	1910	85	116	10.01-08.05	*
1.9 JTD (192DXE1A) (192 A1.000)		Diesel	FWD	1910	85	116	10.01-08.05	*
1.9 JTD (192DXS1A) (192 A8.000)		Diesel	FWD	1910	88	120	09.05-08.08	*
1.9 JTD (192DXS1A) (192 A8.000)		Diesel	FWD	1910	88	120	09.05-08.08	*
1.9 JTD (192DXG1B) (937 A4.000)		Diesel	FWD	1910	93	126	09.03-08.05	*
1.9 JTD (192DXG1B) (937 A4.000)		Diesel	FWD	1910	93	126	09.03-08.05	*
1.9 JTD (192DXG1B) (192 B1.000)		Diesel	FWD	1910	100	136	02.04-08.08	*
1.9 JTD (192DXG1B) (192 B1.000)		Diesel	FWD	1910	100	136	02.04-08.08	*
1.9 JTD (192DXG1B) (192 A5.000)		Diesel	FWD	1910	103	140	09.03-08.05	*
1.9 JTD (192DXG1B) (192 A5.000)		Diesel	FWD	1910	103	140	09.03-08.05	*
1.9 JTD (192DXT1B) (937 A5.000)		Diesel	FWD	1910	110	150	09.05-08.08	*
1.9 JTD (192DXT1B) (937 A5.000)		Diesel	FWD	1910	110	150	09.05-08.08	*
STILO Multi Wagon (192_) 01.03-08.08					[CAMBIADO]:Break (Compact car-C Segment)			
1.4 16V (192 B2.000)		Gasolina	FWD	1368	66	90	03.05-08.08	*
1.4 16V (192 B2.000)		Gasolina	FWD	1368	66	90	03.05-08.08	*
1.4 16V (843 A1.000)		Gasolina	FWD	1368	70	95	01.04-08.08	*
1.4 16V (843 A1.000)		Gasolina	FWD	1368	70	95	01.04-08.08	*
1.6 16V (182 B6.000)		Gasolina	FWD	1596	76	103	01.03-08.08	*
1.6 16V (182 B6.000)		Gasolina	FWD	1596	76	103	01.03-08.08	*
1.8 16V (192 A4.000)		Gasolina	FWD	1747	98	133	01.03-08.08	*
1.8 16V (192 A4.000)		Gasolina	FWD	1747	98	133	01.03-08.08	*
1.8		Gasolina	FWD	1796	76	103	01.04-08.08	*
1.8		Gasolina	FWD	1796	76	103	01.04-08.08	*
1.8		Gasolina	FWD	1796	84	114	09.05-08.08	*
1.8		Gasolina	FWD	1796	84	114	09.05-08.08	*
1.8		Gasolina	FWD	1796	90	122	01.04-08.08	*
1.8		Gasolina	FWD	1796	90	122	01.04-08.08	*
2.4 20V (19245ZO) (192 A7.011)		Gasolina	FWD	2446	123	167	01.04-08.08	*
2.4 20V (19245ZO) (192 A7.011)		Gasolina	FWD	2446	123	167	01.04-08.08	*
1.9 JTD (192 A3.000)		Diesel	FWD	1910	59	80	01.03-08.08	*
1.9 JTD (192 A3.000)		Diesel	FWD	1910	59	80	01.03-08.08	*

LISTA DE APLICACIONES - BUYERS GUIDE

1.9 D Multijet (192 A9.000)	Diesel	FWD	1910	74	100	09.05-08.08	*
1.9 D Multijet (192 A9.000)	Diesel	FWD	1910	74	100	09.05-08.08	*
1.9 JTD (192 A1.000)	Diesel	FWD	1910	85	115	01.03-08.08	*
1.9 JTD (192 A1.000)	Diesel	FWD	1910	85	115	01.03-08.08	*
1.9 JTD (937 A7.000)	Diesel	FWD	1910	85	115	01.03-08.08	*
1.9 JTD (937 A7.000)	Diesel	FWD	1910	85	115	01.03-08.08	*
1.9 D Multijet (192 A8.000)	Diesel	FWD	1910	88	120	09.05-08.08	*
1.9 D Multijet (192 A8.000)	Diesel	FWD	1910	88	120	09.05-08.08	*
1.9 JTD (937 A4.000)	Diesel	FWD	1910	93	126	09.03-08.08	*
1.9 JTD (937 A4.000)	Diesel	FWD	1910	93	126	09.03-08.08	*
1.9 JTD (192 B1.000)	Diesel	FWD	1910	100	136	04.04-08.08	*
1.9 JTD (192 B1.000)	Diesel	FWD	1910	100	136	04.04-08.08	*
1.9 JTD (192 A5.000)	Diesel	FWD	1910	103	140	01.04-08.08	*
1.9 JTD (192 A5.000)	Diesel	FWD	1910	103	140	01.04-08.08	*
1.9 D Multijet (192DXT1B) (937 A5.000)	Diesel	FWD	1910	110	150	09.05-08.08	*
1.9 D Multijet (192DXT1B) (937 A5.000)	Diesel	FWD	1910	110	150	09.05-08.08	*
LANCIA							
DELTA III (844_) 08.08-08.14				[CAMBIADO]:Fastback (Compact car-C Segment)			
1.4 (844.AXA1A) (198 A4.000)	Gasolina	FWD	1368	88	120	09.08-08.14	*
1.4 (844.AXA1A) (198 A4.000)	Gasolina	FWD	1368	88	120	09.08-08.14	*
1.4 (844.AXB1A) (198 A1.000)	Gasolina	FWD	1368	110	150	09.08-08.14	*
1.4 (844.AXB1A) (198 A1.000)	Gasolina	FWD	1368	110	150	09.08-08.14	*
1.4 Bifuel (844.AXA1A) (198 A4.000)	Gasol./Gas (LPG)	FWD	1368	88	120	07.11-08.14	*
1.4 Bifuel (844.AXA1A) (198 A4.000)	Gasol./Gas (LPG)	FWD	1368	88	120	07.11-08.14	*
1.6 D Multijet (844.AXC11, 844.AXC1A) (198 A2.000)	Diesel	FWD	1598	88	120	09.08-08.14	*
1.6 D Multijet (844.AXC11, 844.AXC1A) (198 A2.000)	Diesel	FWD	1598	88	120	09.08-08.14	*
1.9 D Multijet (844.AXE1A) (844 A1.000)	Diesel	FWD	1910	140	190	01.09-08.14	*
1.9 D Multijet (844.AXE1A) (844 A1.000)	Diesel	FWD	1910	140	190	01.09-08.14	*
2.0 D Multijet (844.AXD1A, 844.AXM1A) (198 A5.000)	Diesel	FWD	1956	121	165	09.08-08.14	*
2.0 D Multijet (844.AXD1A, 844.AXM1A) (198 A5.000)	Diesel	FWD	1956	121	165	09.08-08.14	*
2.0 D Multijet (844.AXD1A, 844.AXM1A) (198 A8.000)	Diesel	FWD	1956	121	165	09.08-08.14	*
2.0 D Multijet (844.AXD1A, 844.AXM1A) (198 A8.000)	Diesel	FWD	1956	121	165	09.08-08.14	*