

# LISTA DE APLICACIONES - BUYERS GUIDE

## 3R14400356

Weight: 14.858

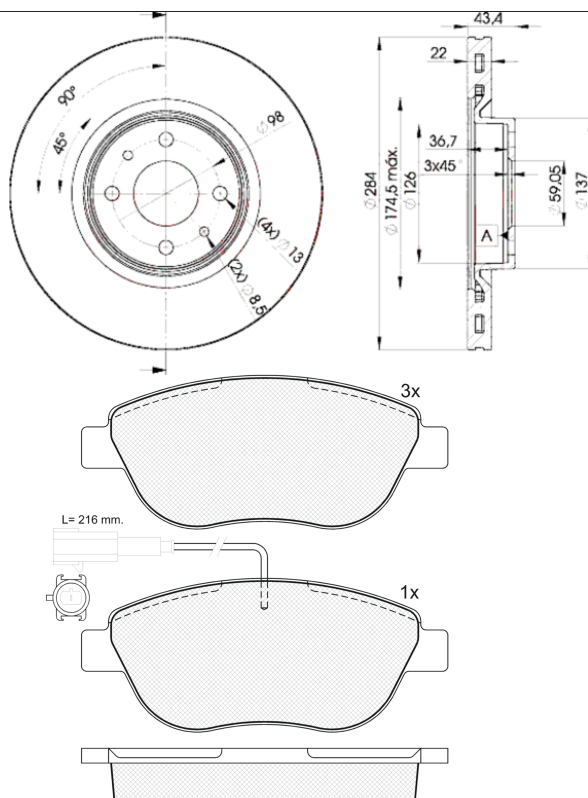

## 3R14400356



Bosch

136.7x57.34x19

Ø284x22x43.4

**WVA**

23708

Sin Filas



Trac.

CC

Kw

CV



Front / Rear

### ABARTH

#### 500 / 595 / 695 01.08-

[CAMBIADO]:Fastback (City car-A Segment)

1.4 (312.AXD1A) (312 A1.000)	Gasolina	FWD	1368	99	135	08.08-	*
1.4 (312.AXD1A) (312 A1.000)	Gasolina	FWD	1368	99	135	08.08-	*
1.4 (312.AXF1A, 312.AXF11, 312.AXD1A) (312 A3.000)	Gasolina	FWD	1368	103	140	05.10-	*
1.4 (312.AXF1A, 312.AXF11, 312.AXD1A) (312 A3.000)	Gasolina	FWD	1368	103	140	05.10-	*
1.4 (312.AXT1A)	Gasolina	FWD	1368	140	190	08.08-	*
1.4 (312.AXT1A)	Gasolina	FWD	1368	140	190	08.08-	*

### CHRYSLER

#### DELTA 08.11-

[CAMBIADO]:Fastback (Compact car-C Segment)

1.4 (198 A4.000)	Gasolina	FWD	1368	88	120	08.11-	*
1.4 (198 A4.000)	Gasolina	FWD	1368	88	120	08.11-	*
1.6 D Multijet (198 A2.000)	Diesel	FWD	1598	88	120	08.11-	*
1.6 D Multijet (198 A2.000)	Diesel	FWD	1598	88	120	08.11-	*

### FIAT

#### BRAVO II / RITMO III (198\_) 11.06-

[CAMBIADO]:Fastback (Compact car-C Segment)

1.9 D Multijet (198AXB1A) (192 A8.000)	Diesel	FWD	1910	88	120	04.07-12.14	*
1.9 D Multijet (198AXB1A) (192 A8.000)	Diesel	FWD	1910	88	120	04.07-12.14	*

#### STILO (192\_) 10.01-11.10

[CAMBIADO]:Fastback (Compact car-C Segment)

1.8 16V (192AXC1A, 192BXC1A) (192 A4.000)	Gasolina	FWD	1747	98	133	10.01-04.07	*
1.8 16V (192AXC1A, 192BXC1A) (192 A4.000)	Gasolina	FWD	1747	98	133	10.01-04.07	*
1.9 JTD (192_XF1A) (192 A3.000)	Diesel	FWD	1910	59	80	02.02-11.06	*

# LISTA DE APLICACIONES - BUYERS GUIDE

1.9 JTD (192_XF1A) (192 A3.000)	Diesel	FWD	1910	59	80	02.02-11.06	*
1.9 JTD (192AXS1B, 192BXS1B) (192 B5.000)	Diesel	FWD	1910	66	90	09.04-11.06	*
1.9 JTD (192AXS1B, 192BXS1B) (192 B5.000)	Diesel	FWD	1910	66	90	09.04-11.06	*
1.9 JTD (192_XE1A) (192 A1.000)	Diesel	FWD	1910	85	115	10.01-11.06	*
1.9 JTD (192_XE1A) (192 A1.000)	Diesel	FWD	1910	85	115	10.01-11.06	*
1.9 JTD (192_XE1A) (937 A7.000)	Diesel	FWD	1910	85	115	10.01-11.06	*
1.9 JTD (192_XE1A) (937 A7.000)	Diesel	FWD	1910	85	115	10.01-11.06	*
1.9 D Multijet (192 A8.000)	Diesel	FWD	1910	88	120	09.05-11.06	*
1.9 D Multijet (192 A8.000)	Diesel	FWD	1910	88	120	09.05-11.06	*
<b>STILO (192_) 10.01-08.08</b>				<b>[CAMBIADO]:Furgón/Break (Compact car-C Segment)</b>			
1.9 JTD (192DXF1A) (192 A3.000)	Diesel	FWD	1910	59	80	10.01-08.05	*
1.9 JTD (192DXF1A) (192 A3.000)	Diesel	FWD	1910	59	80	10.01-08.05	*
1.9 JTD (192DXE1A) (192 A1.000)	Diesel	FWD	1910	85	116	10.01-08.05	*
1.9 JTD (192DXE1A) (192 A1.000)	Diesel	FWD	1910	85	116	10.01-08.05	*
1.9 JTD (192DXS1A) (192 A8.000)	Diesel	FWD	1910	88	120	09.05-08.08	*
1.9 JTD (192DXS1A) (192 A8.000)	Diesel	FWD	1910	88	120	09.05-08.08	*
<b>STILO Multi Wagon (192_) 01.03-08.08</b>				<b>[CAMBIADO]:Break (Compact car-C Segment)</b>			
1.8 16V (192 A4.000)	Gasolina	FWD	1747	98	133	01.03-08.08	*
1.8 16V (192 A4.000)	Gasolina	FWD	1747	98	133	01.03-08.08	*
1.9 JTD (192 A3.000)	Diesel	FWD	1910	59	80	01.03-08.08	*
1.9 JTD (192 A3.000)	Diesel	FWD	1910	59	80	01.03-08.08	*
1.9 D Multijet (192 A9.000)	Diesel	FWD	1910	74	100	09.05-08.08	*
1.9 D Multijet (192 A9.000)	Diesel	FWD	1910	74	100	09.05-08.08	*
1.9 JTD (192 A1.000)	Diesel	FWD	1910	85	115	01.03-08.08	*
1.9 JTD (192 A1.000)	Diesel	FWD	1910	85	115	01.03-08.08	*
1.9 JTD (937 A7.000)	Diesel	FWD	1910	85	115	01.03-08.08	*
1.9 JTD (937 A7.000)	Diesel	FWD	1910	85	115	01.03-08.08	*
1.9 D Multijet (192 A8.000)	Diesel	FWD	1910	88	120	09.05-08.08	*
1.9 D Multijet (192 A8.000)	Diesel	FWD	1910	88	120	09.05-08.08	*
<b>LANCIA</b>							
<b>DELTA III (844_) 08.08-08.14</b>				<b>[CAMBIADO]:Fastback (Compact car-C Segment)</b>			
1.4 (844.AXA1A) (198 A4.000)	Gasolina	FWD	1368	88	120	09.08-08.14	*
1.4 (844.AXA1A) (198 A4.000)	Gasolina	FWD	1368	88	120	09.08-08.14	*
1.4 Bifuel (844.AXA1A) (198 A4.000)	Gasol./Gas (LPG)	FWD	1368	88	120	07.11-08.14	*
1.4 Bifuel (844.AXA1A) (198 A4.000)	Gasol./Gas (LPG)	FWD	1368	88	120	07.11-08.14	*
1.6 D Multijet (844.AXC11, 844.AXC1A) (198 A2.000)	Diesel	FWD	1598	88	120	09.08-08.14	*
1.6 D Multijet (844.AXC11, 844.AXC1A) (198 A2.000)	Diesel	FWD	1598	88	120	09.08-08.14	*