

LISTA DE APLICACIONES - BUYERS GUIDE

3R14342891

Weight: 12.698

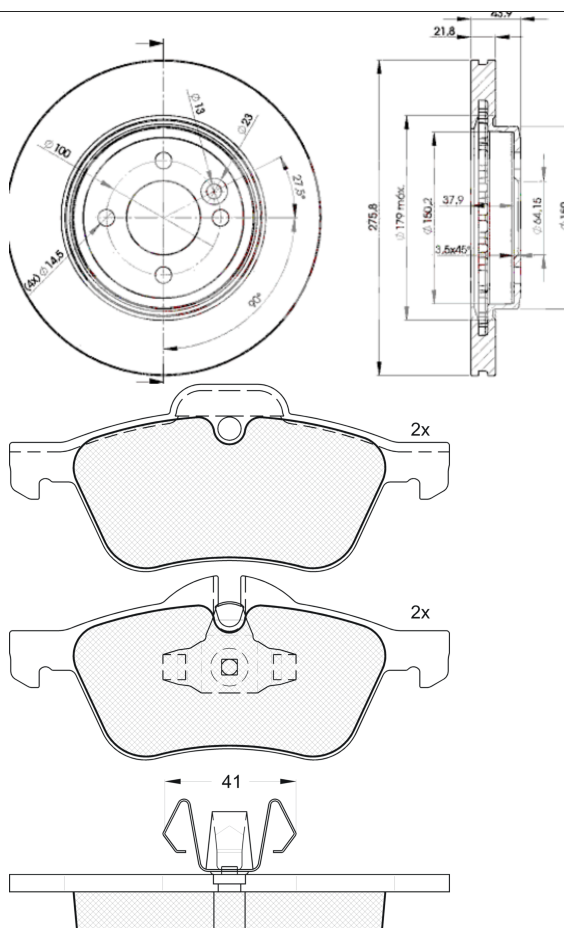

3R14342891



Ate - Teves

140.2x58.7x18.3

Ø276x22x44.2

WVA

23281

23282

Sin Filas



Trac.

CC

Kw

CV



Front / Rear

MINI

MINI (R50, R53) 06.01-09.06

[CAMBIADO]:Fastback (Supermini car-B Segment)

One (W10 B14 A)	Gasolina	FWD	1398	55	75	04.03-09.06	*
One (W10 B14 A)	Gasolina	FWD	1398	55	75	04.03-09.06	*
One (W10 B16 A)	Gasolina	FWD	1598	66	90	06.01-09.06	*
One (W10 B16 A)	Gasolina	FWD	1598	66	90	06.01-09.06	*
Cooper (W10 B16 A)	Gasolina	FWD	1598	85	116	06.01-09.06	*
Cooper (W10 B16 A)	Gasolina	FWD	1598	85	116	06.01-09.06	*
Cooper S (W11 B16 A)	Gasolina	FWD	1598	120	163	03.02-09.06	*
Cooper S (W11 B16 A)	Gasolina	FWD	1598	120	163	03.02-09.06	*
Cooper S (W11 B16 A)	Gasolina	FWD	1598	125	170	07.04-09.06	*
Cooper S (W11 B16 A)	Gasolina	FWD	1598	125	170	07.04-09.06	*
Works (W11 B16 A)	Gasolina	FWD	1598	155	210	11.03-09.06	*
Works (W11 B16 A)	Gasolina	FWD	1598	155	210	11.03-09.06	*
One D (1ND)	Diesel	FWD	1364	55	75	06.03-09.06	*
One D (1ND)	Diesel	FWD	1364	55	75	06.03-09.06	*
One D (W17 D14 (1ND))	Diesel	FWD	1364	65	88	06.03-09.06	*
One D (W17 D14 (1ND))	Diesel	FWD	1364	65	88	06.03-09.06	*

MINI (R52) 04.04-07.08

Cabrio (Supermini car-B Segment)

One (W10 B16 A)	Gasolina	FWD	1598	66	90	07.04-11.07	*
One (W10 B16 A)	Gasolina	FWD	1598	66	90	07.04-11.07	*
Cooper (W10 B16 A)	Gasolina	FWD	1598	85	116	04.04-07.08	*
Cooper (W10 B16 A)	Gasolina	FWD	1598	85	116	04.04-07.08	*
Cooper S (W11 B16 A)	Gasolina	FWD	1598	125	170	07.04-07.08	*

LISTA DE APLICACIONES - BUYERS GUIDE

Cooper S (W11 B16 A)	Gasolina	FWD	1598	125	170	07.04-07.08	*
John Cooper Works (W11 B16 A)	Gasolina	FWD	1598	155	210	07.04-11.07	*
John Cooper Works (W11 B16 A)	Gasolina	FWD	1598	155	210	07.04-11.07	*