

LISTA DE APLICACIONES - BUYERS GUIDE

3R13816768

Weight: 11.965

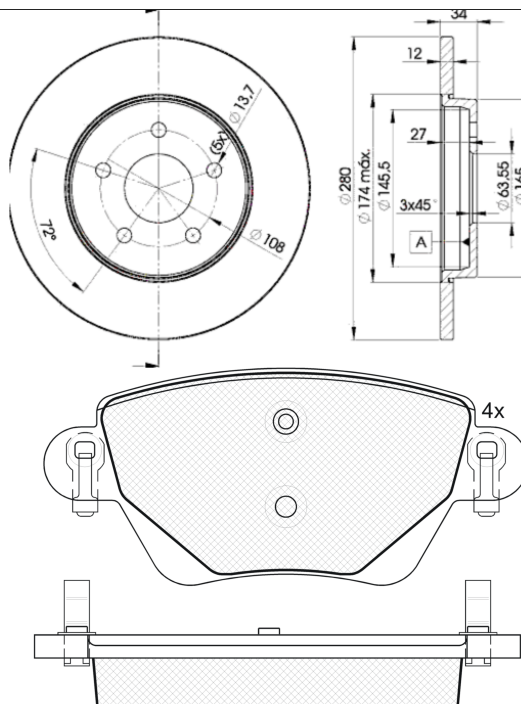

181381-701

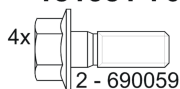

3R13816768



Bosch

115.7x51.8x17.2

Ø280x12x34.2

WVA

23557

Sin Filas



Trac.	CC	Kw	CV
-------	----	----	----



Front / Rear

FORD

MONDEO III (B5Y) 10.00-03.07

[CAMBIADO]:Fastback (Large family car-D Segment)

Model	Engine	Drive	CC	Kw	CV	Period	Notes
1.8 16V (CGBA)	Gasolina	FWD	1798	81	110	10.00-03.07	*
1.8 16V (CGBA)	Gasolina	FWD	1798	81	110	10.00-03.07	*
1.8 16V (CGBB)	Gasolina	FWD	1798	81	110	10.00-03.07	*
1.8 16V (CGBB)	Gasolina	FWD	1798	81	110	10.00-03.07	*
1.8 16V (CHBA)	Gasolina	FWD	1798	92	125	10.00-03.07	*
1.8 16V (CHBA)	Gasolina	FWD	1798	92	125	10.00-03.07	*
1.8 16V (CHBB)	Gasolina	FWD	1798	92	125	10.00-03.07	*
1.8 16V (CHBB)	Gasolina	FWD	1798	92	125	10.00-03.07	*
1.8 SCi (CFBA)	Gasolina	FWD	1798	96	130	06.03-03.07	*
1.8 SCi (CFBA)	Gasolina	FWD	1798	96	130	06.03-03.07	*
2.0 16V (CJBA)	Gasolina	FWD	1999	107	146	10.00-03.07	*
2.0 16V (CJBA)	Gasolina	FWD	1999	107	146	10.00-03.07	*
2.0 16V (CJBB)	Gasolina	FWD	1999	107	146	10.00-03.07	*
2.0 16V (CJBB)	Gasolina	FWD	1999	107	146	10.00-03.07	*
2.5 V6 24V (LCBD)	Gasolina	FWD	2495	125	170	10.00-03.07	*
2.5 V6 24V (LCBD)	Gasolina	FWD	2495	125	170	10.00-03.07	*
3.0 V6 24V (REBA)	Gasolina	FWD	2967	150	204	09.04-03.07	*
3.0 V6 24V (REBA)	Gasolina	FWD	2967	150	204	09.04-03.07	*
ST220 (MEBA)	Gasolina	FWD	2967	166	226	04.02-03.07	*
ST220 (MEBA)	Gasolina	FWD	2967	166	226	04.02-03.07	*
2.0 16V DI / TDDi / TDCi (D5BA)	Diesel	FWD	1998	66	90	10.00-03.07	*
2.0 16V DI / TDDi / TDCi (D5BA)	Diesel	FWD	1998	66	90	10.00-03.07	*
2.0 16V DI / TDDi / TDCi (SDBA)	Diesel	FWD	1998	66	90	10.00-03.07	*

LISTA DE APLICACIONES - BUYERS GUIDE

2.0 16V DI / TDDi / TDCi (SDBA)	Diesel	FWD	1998	66	90	10.00-03.07	*
2.0 16V TDDi / TDCi (D6BA)	Diesel	FWD	1998	85	115	10.00-03.07	*
2.0 16V TDDi / TDCi (D6BA)	Diesel	FWD	1998	85	115	10.00-03.07	*
2.0 16V TDDi / TDCi (HJBA)	Diesel	FWD	1998	85	115	10.00-03.07	*
2.0 16V TDDi / TDCi (HJBA)	Diesel	FWD	1998	85	115	10.00-03.07	*
2.0 16V TDDi / TDCi (HJBB)	Diesel	FWD	1998	85	115	10.00-03.07	*
2.0 16V TDDi / TDCi (HJBB)	Diesel	FWD	1998	85	115	10.00-03.07	*
2.0 16V TDDi / TDCi (HJBC)	Diesel	FWD	1998	85	115	10.00-03.07	*
2.0 16V TDDi / TDCi (HJBC)	Diesel	FWD	1998	85	115	10.00-03.07	*
2.0 TDCi	Diesel	RWD	1998	92	125	02.03-06.05	*
2.0 TDCi	Diesel	RWD	1998	92	125	02.03-06.05	*
2.0 TDCi (FMBA)	Diesel	FWD	1998	96	130	10.01-03.07	*
2.0 TDCi (FMBA)	Diesel	FWD	1998	96	130	10.01-03.07	*
2.0 TDCi (N7BA)	Diesel	FWD	1998	96	130	10.01-03.07	*
2.0 TDCi (N7BA)	Diesel	FWD	1998	96	130	10.01-03.07	*
2.0 TDCi (N7BB)	Diesel	FWD	1998	96	130	10.01-03.07	*
2.0 TDCi (N7BB)	Diesel	FWD	1998	96	130	10.01-03.07	*
2.2 TDCi (QJBC)	Diesel	FWD	2198	110	150	09.04-03.07	*
2.2 TDCi (QJBC)	Diesel	FWD	2198	110	150	09.04-03.07	*
2.2 TDCi (QJBD)	Diesel	FWD	2198	110	150	09.04-03.07	*
2.2 TDCi (QJBD)	Diesel	FWD	2198	110	150	09.04-03.07	*
2.2 TDCi (QJBA)	Diesel	FWD	2198	114	155	09.04-03.07	*
2.2 TDCi (QJBA)	Diesel	FWD	2198	114	155	09.04-03.07	*
2.2 TDCi (QJBB)	Diesel	FWD	2198	114	155	09.04-03.07	*
2.2 TDCi (QJBB)	Diesel	FWD	2198	114	155	09.04-03.07	*
MONDEO III (B4Y) 10.00-09.07					Sedán (Large family car-D Segment)		
1.8 16V (CGBA)	Gasolina	FWD	1798	81	110	10.00-03.07	*
1.8 16V (CGBA)	Gasolina	FWD	1798	81	110	10.00-03.07	*
1.8 16V (CGBB)	Gasolina	FWD	1798	81	110	10.00-03.07	*
1.8 16V (CGBB)	Gasolina	FWD	1798	81	110	10.00-03.07	*
1.8 16V (CHBA)	Gasolina	FWD	1798	92	125	10.00-03.07	*
1.8 16V (CHBA)	Gasolina	FWD	1798	92	125	10.00-03.07	*
1.8 16V (CHBB)	Gasolina	FWD	1798	92	125	10.00-03.07	*
1.8 16V (CHBB)	Gasolina	FWD	1798	92	125	10.00-03.07	*
1.8 SCi (CFBA)	Gasolina	FWD	1798	96	130	06.03-03.07	*
1.8 SCi (CFBA)	Gasolina	FWD	1798	96	130	06.03-03.07	*
2.0 16V (CJBA)	Gasolina	FWD	1999	107	146	10.00-03.07	*
2.0 16V (CJBA)	Gasolina	FWD	1999	107	146	10.00-03.07	*
2.0 16V (CJBB)	Gasolina	FWD	1999	107	146	10.00-03.07	*
2.0 16V (CJBB)	Gasolina	FWD	1999	107	146	10.00-03.07	*
2.5 V6 24V (LCBD)	Gasolina	FWD	2495	125	170	10.00-03.07	*
2.5 V6 24V (LCBD)	Gasolina	FWD	2495	125	170	10.00-03.07	*
3.0 V6 24V (REBA)	Gasolina	FWD	2967	150	204	09.04-03.07	*
3.0 V6 24V (REBA)	Gasolina	FWD	2967	150	204	09.04-03.07	*
ST220 (MEBA)	Gasolina	FWD	2967	166	226	04.02-03.07	*
ST220 (MEBA)	Gasolina	FWD	2967	166	226	04.02-03.07	*
2.0 16V DI / TDDi / TDCi (D5BA)	Diesel	FWD	1998	66	90	10.00-03.07	*
2.0 16V DI / TDDi / TDCi (D5BA)	Diesel	FWD	1998	66	90	10.00-03.07	*
2.0 16V DI / TDDi / TDCi (SDBA)	Diesel	FWD	1998	66	90	10.00-03.07	*
2.0 16V DI / TDDi / TDCi (SDBA)	Diesel	FWD	1998	66	90	10.00-03.07	*
2.0 16V TDDi / TDCi (D6BA)	Diesel	FWD	1998	85	115	10.00-03.07	*

LISTA DE APLICACIONES - BUYERS GUIDE

2.0 16V TDDi / TDCi (D6BA)	Diesel	FWD	1998	85	115	10.00-03.07	*
2.0 16V TDDi / TDCi (HJBA)	Diesel	FWD	1998	85	115	10.00-03.07	*
2.0 16V TDDi / TDCi (HJBA)	Diesel	FWD	1998	85	115	10.00-03.07	*
2.0 16V TDDi / TDCi (HJBB)	Diesel	FWD	1998	85	115	10.00-03.07	*
2.0 16V TDDi / TDCi (HJBB)	Diesel	FWD	1998	85	115	10.00-03.07	*
2.0 16V TDDi / TDCi (HJBC)	Diesel	FWD	1998	85	115	10.00-03.07	*
2.0 16V TDDi / TDCi (HJBC)	Diesel	FWD	1998	85	115	10.00-03.07	*
2.0 DI	Diesel	FWD	1998	92	125	10.00-03.07	*
2.0 DI	Diesel	FWD	1998	92	125	10.00-03.07	*
2.0 TDCi (FMBA)	Diesel	FWD	1998	96	130	10.01-03.07	*
2.0 TDCi (FMBA)	Diesel	FWD	1998	96	130	10.01-03.07	*
2.0 TDCi (N7BA)	Diesel	FWD	1998	96	130	10.01-03.07	*
2.0 TDCi (N7BA)	Diesel	FWD	1998	96	130	10.01-03.07	*
2.0 TDCi (N7BB)	Diesel	FWD	1998	96	130	10.01-03.07	*
2.0 TDCi (N7BB)	Diesel	FWD	1998	96	130	10.01-03.07	*
2.2 TDCi (QJBC)	Diesel	FWD	2198	110	150	09.04-03.07	*
2.2 TDCi (QJBC)	Diesel	FWD	2198	110	150	09.04-03.07	*
2.2 TDCi (QJBD)	Diesel	FWD	2198	110	150	09.04-03.07	*
2.2 TDCi (QJBD)	Diesel	FWD	2198	110	150	09.04-03.07	*
2.2 TDCi (QJBA)	Diesel	FWD	2198	114	155	09.04-03.07	*
2.2 TDCi (QJBA)	Diesel	FWD	2198	114	155	09.04-03.07	*
2.2 TDCi (QJBB)	Diesel	FWD	2198	114	155	09.04-03.07	*
2.2 TDCi (QJBB)	Diesel	FWD	2198	114	155	09.04-03.07	*
MONDEO III Turnier (BWY) 10.00-03.07					[CAMBIADO]:Break (Large family car-D Segment)		
1.8 16V (CGBA)	Gasolina	FWD	1798	81	110	10.00-03.07	*
1.8 16V (CGBA)	Gasolina	FWD	1798	81	110	10.00-03.07	*
1.8 16V (CGBB)	Gasolina	FWD	1798	81	110	10.00-03.07	*
1.8 16V (CGBB)	Gasolina	FWD	1798	81	110	10.00-03.07	*
1.8 16V (CHBA)	Gasolina	FWD	1798	92	125	10.00-03.07	*
1.8 16V (CHBA)	Gasolina	FWD	1798	92	125	10.00-03.07	*
1.8 16V (CHBB)	Gasolina	FWD	1798	92	125	10.00-03.07	*
1.8 16V (CHBB)	Gasolina	FWD	1798	92	125	10.00-03.07	*
1.8 SCi (CFBA)	Gasolina	FWD	1798	96	130	06.03-03.07	*
1.8 SCi (CFBA)	Gasolina	FWD	1798	96	130	06.03-03.07	*
2.0 16V (CJBA)	Gasolina	FWD	1999	107	146	10.00-03.07	*
2.0 16V (CJBA)	Gasolina	FWD	1999	107	146	10.00-03.07	*
2.0 16V (CJBB)	Gasolina	FWD	1999	107	146	10.00-03.07	*
2.0 16V (CJBB)	Gasolina	FWD	1999	107	146	10.00-03.07	*
2.5 V6 24V (LCBD)	Gasolina	FWD	2495	125	170	10.00-03.07	*
2.5 V6 24V (LCBD)	Gasolina	FWD	2495	125	170	10.00-03.07	*
3.0 V6 24V (REBA)	Gasolina	FWD	2967	150	204	09.04-03.07	*
3.0 V6 24V (REBA)	Gasolina	FWD	2967	150	204	09.04-03.07	*
ST220 (MEBA)	Gasolina	FWD	2967	166	226	04.02-03.07	*
ST220 (MEBA)	Gasolina	FWD	2967	166	226	04.02-03.07	*
2.0 16V DI / TDDi / TDCi (D5BA)	Diesel	FWD	1998	66	90	10.00-03.07	*
2.0 16V DI / TDDi / TDCi (D5BA)	Diesel	FWD	1998	66	90	10.00-03.07	*
2.0 16V DI / TDDi / TDCi (SDBA)	Diesel	FWD	1998	66	90	10.00-03.07	*
2.0 16V DI / TDDi / TDCi (SDBA)	Diesel	FWD	1998	66	90	10.00-03.07	*
2.0 16V TDDi / TDCi (D6BA)	Diesel	FWD	1998	85	115	10.00-03.07	*
2.0 16V TDDi / TDCi (D6BA)	Diesel	FWD	1998	85	115	10.00-03.07	*
2.0 16V TDDi / TDCi (HJBA)	Diesel	FWD	1998	85	115	10.00-03.07	*

LISTA DE APLICACIONES - BUYERS GUIDE

2.0 16V TDDi / TDCi (HJBA)		Diesel	FWD	1998	85	115	10.00-03.07	*
2.0 16V TDDi / TDCi (HJBB)		Diesel	FWD	1998	85	115	10.00-03.07	*
2.0 16V TDDi / TDCi (HJBB)		Diesel	FWD	1998	85	115	10.00-03.07	*
2.0 16V TDDi / TDCi (HJBC)		Diesel	FWD	1998	85	115	10.00-03.07	*
2.0 16V TDDi / TDCi (HJBC)		Diesel	FWD	1998	85	115	10.00-03.07	*
2.0 TDCi (FMBA)		Diesel	FWD	1998	96	130	10.01-03.07	*
2.0 TDCi (FMBA)		Diesel	FWD	1998	96	130	10.01-03.07	*
2.0 TDCi (N7BA)		Diesel	FWD	1998	96	130	10.01-03.07	*
2.0 TDCi (N7BA)		Diesel	FWD	1998	96	130	10.01-03.07	*
2.0 TDCi (N7BB)		Diesel	FWD	1998	96	130	10.01-03.07	*
2.0 TDCi (N7BB)		Diesel	FWD	1998	96	130	10.01-03.07	*
2.2 TDCi (QJBA)		Diesel	FWD	2198	114	155	09.04-03.07	*
2.2 TDCi (QJBA)		Diesel	FWD	2198	114	155	09.04-03.07	*
2.2 TDCi (QJBB)		Diesel	FWD	2198	114	155	09.04-03.07	*
2.2 TDCi (QJBB)		Diesel	FWD	2198	114	155	09.04-03.07	*
JAGUAR								
X-TYPE (X400) 09.03-12.09					[CAMBIADO]:Break (Compact executive car-D Segment)			
2.1 V6 (YB (AJ-V6))		Gasolina	FWD	2099	115	156	11.03-03.09	*
2.1 V6 (YB (AJ-V6))		Gasolina	FWD	2099	115	156	11.03-03.09	*
2.5 (XB (AJ-V6))		Gasolina	4WD	2495	144	196	02.04-12.09	*
2.5 (XB (AJ-V6))		Gasolina	4WD	2495	144	196	02.04-12.09	*
3.0 (AJ-V6)		Gasolina	4WD	2967	169	230	02.04-12.09	*
3.0 (AJ-V6)		Gasolina	4WD	2967	169	230	02.04-12.09	*
2.0 D (FMBA)		Diesel	FWD	1998	96	130	02.04-12.09	*
2.0 D (FMBA)		Diesel	FWD	1998	96	130	02.04-12.09	*
2.0 D (FMBB)		Diesel	FWD	1998	96	130	02.04-12.09	*
2.0 D (FMBB)		Diesel	FWD	1998	96	130	02.04-12.09	*
2.2 D (QJBA)		Diesel	FWD	2198	114	155	10.05-12.09	*
2.2 D (QJBA)		Diesel	FWD	2198	114	155	10.05-12.09	*
X-TYPE (X400) 03.01-11.09					Sedán (Compact executive car-D Segment)			
2.1 V6 (YB (AJ-V6))		Gasolina	FWD	2099	115	156	03.02-11.09	*
2.1 V6 (YB (AJ-V6))		Gasolina	FWD	2099	115	156	03.02-11.09	*
2.5 V6 A las 4 ruedas (XB (AJ-V6))		Gasolina	4WD	2495	144	196	06.01-11.09	*
2.5 V6 A las 4 ruedas (XB (AJ-V6))		Gasolina	4WD	2495	144	196	06.01-11.09	*
3.0 V6 A las 4 ruedas (AJ-V6)		Gasolina	4WD	2967	169	230	06.01-12.08	*
3.0 V6 A las 4 ruedas (AJ-V6)		Gasolina	4WD	2967	169	230	06.01-12.08	*
2.0 D (FMBA)		Diesel	FWD	1998	96	130	07.03-11.09	*
2.0 D (FMBA)		Diesel	FWD	1998	96	130	07.03-11.09	*
2.0 D (FMBB)		Diesel	FWD	1998	96	130	07.03-11.09	*
2.0 D (FMBB)		Diesel	FWD	1998	96	130	07.03-11.09	*
2.2 D (QJBA)		Diesel	FWD	2198	114	155	10.05-11.09	*
2.2 D (QJBA)		Diesel	FWD	2198	114	155	10.05-11.09	*